

Remedial card

F. Loc. 1650/N; 990/W Elev. 6501 GL Spd. 4/10/52 Comp. 5/12/52 TD 2140 PB 2099 2082*
 Casing S. 10-3/4 @ 117 W 85 Sx. Int. @ W Sx. Pr. 52 @ 2065 W 50 Sx. T. 1 @ 2133
 Csg. Perf. * Prod. Stim.

I.P. 700* 2575 MCF/D After Hrs. SICP 465 PSI After Days GOR Grav. 1st Del. 7/26/52 SUG

TOPS		NITD	X	Well Log	X	TEST				DATA	
				Plot	X	Schd.	PC	Q	PW	PD	Ref. No.
Kirtland		C-102		Electric Log		53				90	
Fruitland		C-103*	X	C-110	XX	54	393	81	253	197	100
Pictured Cliffs	2060	C-104	X			6/23/55	404	70	254	202	84
Cliff House						12/1/55	331	204	176	165	213 #342
Menefee		Ditr		Dfa	*12	16/56	332	144	207	166	171
Point Lookout		Datr		Dac	4/1/56	3/					
Mancos		Remarks Former operators J D Hancock & Western Development * 9/14/55 - SWF 2059-2082 w/ 14400 G, 11000 # G after SWF 770 MCF				5/1/55	20	140	256	161	178
Tocito											
Dakota											
Morrison								1	9	101	
Entrada											
PCD	4451										

P
 o
 W Kutz PC Co SJ S 36 T 27N R 11W UE Odr. British-Amer Lse E Scott No. 6
 Jan. | Feb. | Mar. | Apr. | May | June | July | Aug. | Sept. | Oct. | Nov. | Dec.

(SUBMIT IN TRIPLICATE)

UNITED STATES
DEPARTMENT OF THE INTERIOR
GEOLOGICAL SURVEY

Land Office Santa Fe
Lease No. 678019
Unit Oil & Gas - 10 in
Geological Drilling
Unit

SUNDRY NOTICES AND REPORTS ON WELLS

NOTICE OF INTENTION TO DRILL	<input checked="" type="checkbox"/>	SUBSEQUENT REPORT OF WATER SHUT-OFF	<input type="checkbox"/>
NOTICE OF INTENTION TO CHANGE PLANS	<input type="checkbox"/>	SUBSEQUENT REPORT OF SHOOTING OR ACIDIZING	<input type="checkbox"/>
NOTICE OF INTENTION TO TEST WATER SHUT-OFF	<input type="checkbox"/>	SUBSEQUENT REPORT OF ALTERING CASING	<input type="checkbox"/>
NOTICE OF INTENTION TO RE-DRILL OR REPAIR WELL	<input type="checkbox"/>	SUBSEQUENT REPORT OF REDRILLING OR REPAIR	<input type="checkbox"/>
NOTICE OF INTENTION TO SHOOT OR ACIDIZE	<input type="checkbox"/>	SUBSEQUENT REPORT OF ABANDONMENT	<input type="checkbox"/>
NOTICE OF INTENTION TO PULL OR ALTER CASING	<input type="checkbox"/>	SUPPLEMENTARY WELL HISTORY	<input type="checkbox"/>
NOTICE OF INTENTION TO ABANDON WELL	<input type="checkbox"/>		

(INDICATE ABOVE BY CHECK MARK NATURE OF REPORT, NOTICE, OR OTHER DATA)

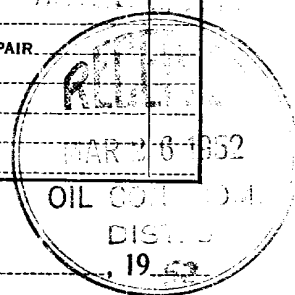

Well No. 0 is located 1650 ft. from N line and 300 ft. from W line of sec. 36
11 W
(1/4 Sec. and Sec. No.) (Twp.) (Range) (Meridian)
South Santa Fe New Mexico
(Field) (City) (County or Subdivision) (State or Territory)

The elevation of the derrick floor above sea level is 6501 ft. ()

DETAILS OF WORK

(State names of and expected depths to objective sands; show sizes, weights, and lengths of proposed casings; indicate mudding jobs, cementing points, and all other important proposed work)

It is proposed to drill a well to the top of Pictured Cliffs formation with history as follows: Estimated 10' 1130'.

DRILLING: 10 3/4" casing set at 100' and cemented to the surface with 75 sacks cement. Cement to be circulated. 100 1/2 hours.

PRODUCTION: 10 1/2" casing set on top of Pictured Cliffs and cemented with 50 of regular portland cement. Casing to be equipped with 1/2" regular 1000, Luckin Clapper type 21 1/2" and 2 1/2" drillers. Run foot bar to locate top of cement. 100 75 hours.

I understand that this plan of work must receive approval in writing by the Geological Survey before operations may be commenced.

Company British American Oil Corporation, Inc.

Address P. O. Box 1117

Oil & Gas City, N.M.

By J. H. Callahan
Title Field Forman

Company British American Oil Producing Co.

Lease Scott Well No. 6

Sec. 36 T. 27 N., R. 11 W., N.M.P.M.

Location 1650' from the North line and 990' from
the West line.



San Juan County New Mexico

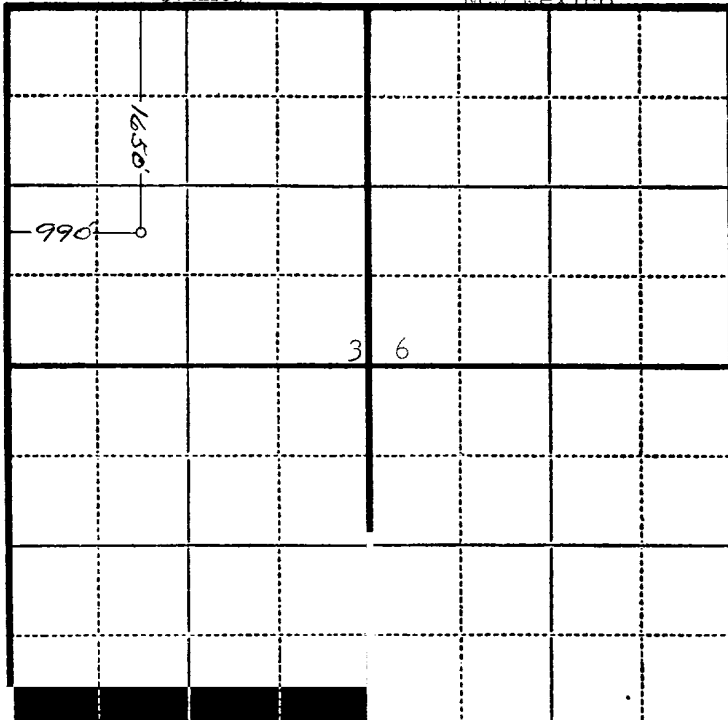

Scale—4 inches equals 1 mile.

This is to certify that the above plat was prepared from field notes of actual surveys made by me or under my supervision and that the same are true and correct to the best of my knowledge and belief.

Charles J. Finkles

Seal:

Registered Professional
Engineer and Land Surveyor.

Charles J. Finkles
N. Mex. Reg. No. 1302

Surveyed March 8, 1952