

NEW MEXICO OIL CONSERVATION COMMISSION  
Well Location and Acreage Dedication Plat

Section A.

Date October 5, 1960

Operator A. N. Brown Lease McAdams  
Well No. 3 Unit Letter H Section 34 Township 27 N Range 10 W NMPM  
Located 1650 Feet From North Line, 990 Feet From East Line  
County San Juan G. L. Elevation 6672' Dedicated Acreage 80\* Acres  
Name of Producing Formation \_\_\_\_\_ Pool \_\_\_\_\_

1. Is the Operator the only owner\* in the dedicated acreage outlined on the plat below?  
Yes X No \_\_\_\_\_.
2. If the answer to question one is "no," have the interests of all the owners been consolidated by communitization agreement or otherwise? Yes \_\_\_\_\_ No \_\_\_\_\_. If answer is "yes," Type of Consolidation \_\_\_\_\_
3. If the answer to question two is "no," list all the owners and their respective interests below:

Owner

Land Description

\*The acreage herein dedicated as a standard Angels Peak Gallup oil proration unit has two wells on it and will be a joint unit.

Section B

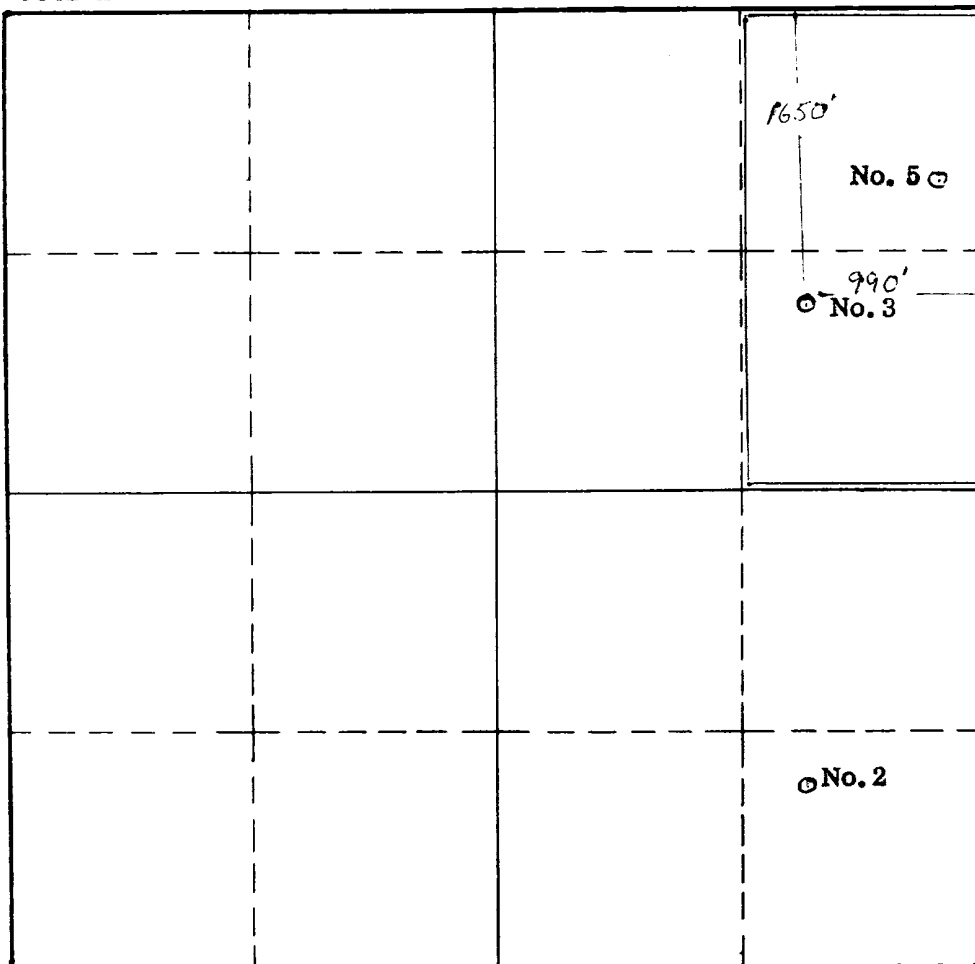

RECEIVED  
OCT 11 1960  
OIL CON. COM.  
DIST. 3

This is to certify that the information in Section A above is true and complete to the best of my knowledge and belief.

A. N. Brown

(Operator)

E. B. Mays

(Representative)

5th Floor Midland Savings Bldg.  
Denver 2, Colorado

Address

This is to certify that the well location shown on the plat in Section B was plotted from field notes of actual surveys made by me or under my supervision and that the same is true and correct to the best of my knowledge and belief.

Date Surveyed March 28, 1958

E. V. Echohawk

Registered Professional  
Engineer and/or Land Surveyor.

Certificate No. 1545

(See instructions for completing this form on the reverse side)

INSTRUCTIONS FOR COMPLETION:

1. Operator shall furnish and certify to the information called for in Section A.
2. Operator shall outline the dedicated acreage for both oil and gas wells on the plat in Section B.
3. A registered professional engineer or land surveyor registered in the State of New Mexico or approved by the Commission shall show on the plat the location of the well and certify this information in the space provided.
4. All distances shown on the plat must be from the outer boundaries of Section.
5. If additional space is needed for listing owners and their respective interests as required in question 3, Section A, please use space below

STATE OF NEW MEXICO	
OIL CONSERVATION COMMISSION	
AZTEC DISTRICT OFFICE	
NUMBER OF COPIES RECEIVED	
DISTRIBUTION	
SANTA FE	
FILE	
U.S.S.	
D	ONE
1	ONE

\* "Owner" means the person who has the right to drill into and to produce from any pool and to appropriate the production either for himself or for himself and another. (65-3-29 (e) NMSA 1953 Comp.)