

(SUBMIT IN TRIPLICATE)

UNITED STATES
DEPARTMENT OF THE INTERIOR
GEOLOGICAL SURVEY

Land Office **New Mexico**

Lease No. **03017**

Unit **Huerfano Unit**

SUNDRY NOTICES AND REPORTS ON WELLS

NOTICE OF INTENTION TO DRILL

NOTICE OF INTENTION TO CHANGE PLANS

NOTICE OF INTENTION TO TEST WATER SHUT-OFF

NOTICE OF INTENTION TO RE-DRILL OR REPAIR WELL

NOTICE OF INTENTION TO SHOOT OR ACIDIZE

NOTICE OF INTENTION TO PULL OR ALTER CASING

NOTICE OF INTENTION TO ABANDON WELL

XX

SUBSEQUENT REPORT OF WATER SHUT-OFF

SUBSEQUENT REPORT OF SHOOTING OR ACIDIZING

SUBSEQUENT REPORT OF ALTERING CASING

SUBSEQUENT REPORT OF RE-DRILLING OR REPAIR

SUBSEQUENT REPORT OF ABANDONMENT

SUPPLEMENTARY WELL HISTORY

RECEIVED

APR 8 1963

**U. S. GEOLOGICAL SURVEY
FARMINGTON, NEW MEXICO**

INDICATE ABOVE BY CHECK MARK NATURE OF REPORT, NOTICE, OR OTHER DATA

April 8 19 63

Well No. **128** is located **1550** ft. from **N** line and **1150** ft. from **W** line of sec. **36**

NW/4 Sec. 36 **27N** **10W** **N.M.P.M.**

Basin Dakota **San Juan** **New Mexico**

The elevation of the derrick floor above sea level is **6525** ft.

DETAILS OF WORK

(State names of and expected depths to objective sands; show sizes, weights, and lengths of proposed casings; indicate mudding jobs, cementing points, and all other important proposed work)

It is intended to mud drill a well with rotary tools thru the Dakota formation. Possible producing zones will be perforated and fractured. Est. T. D. 6939'.

Casing Program:

- 9 5/8" @ 300' w/200 sacks circulated to surface.
- 4 1/2" @ 6939' cemented in 3 stages. Set second stage collar 100' below base of Gallup, Third stage collar 100' below base of Pictured Cliffs.
- Cement first stage w/200 sacks to cover stage tool.
- Second stage w/200 sacks to cover 300' above Gallup.
- Third stage w/100 sacks to cover 300' above Fruitland.

The W/2 of Section 36 is dedicated to this well.

I understand that this plan of work must receive approval in writing by the Geological Survey, before operations may be commenced.

Company **El Paso Natural Gas Company**

Address **Box 990**

Farmington, New Mexico

By

Title **Petroleum Engineer**



NEW MEXICO OIL CONSERVATION COMMISSION

Well Location and Acreage Dedication Plat

Section A.

Date **APRIL 2, 1963**

Operator **EL PASO NATURAL GAS COMPANY** Lease **HUERFANO UNIT** NMO3017
 Well No. **128** Unit Letter **E** Section **36** Township **27-N** Range **10-W** NMPM
 Located **1550** Feet From **NORTH** Line **1150** Feet From **WEST** Line
 County **SAN JUAN** G. L. Elevation **6515** Dedicated Acreage **320** Acres
 Name of Producing Formation **DAKOTA** Pool **BASIN DAKOTA**

1. Is the Operator the only owner in the dedicated acreage outlined on the plat below?
 Yes ☒ No ☐
2. If the answer to question one is "no", have the interests of all the owners been consolidated by communication agreement or otherwise? Yes ☐ No ☐ If answer is "yes", Type of Consolidation.

3. If the answer to question two is "no", list all the owners and their respective interests below:

Owner

Land Description

Section B.

This is to certify that the information in Section A above is true and complete to the best of my knowledge and belief.

El Paso Natural Gas Company

(Operator)

ORIGINAL SIGNED E. S. OBERLY

(Representative)

Box 990

(Address)

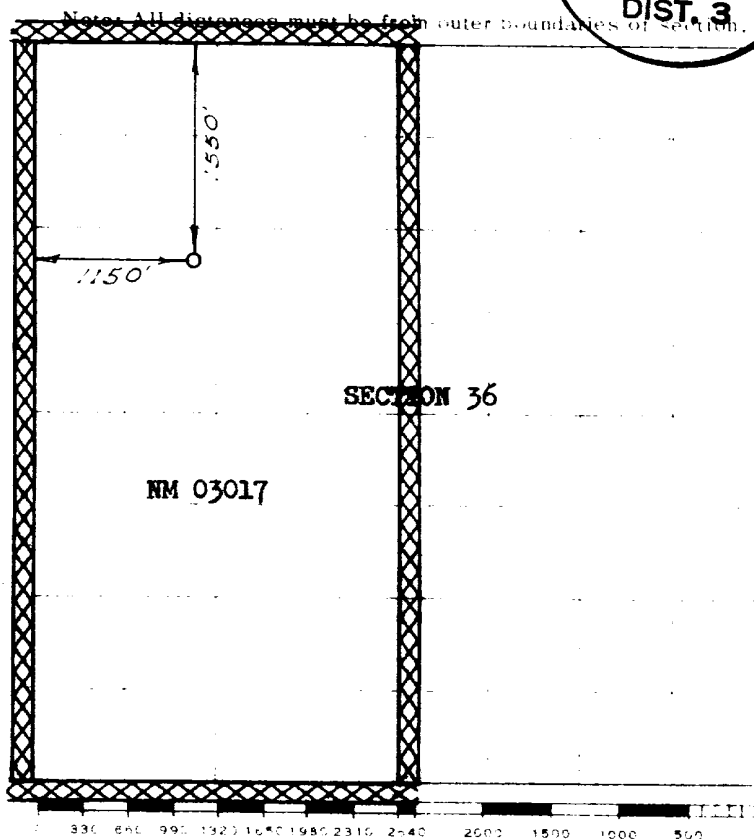
Farmington, New Mexico

Scale 4 inches equal 1 mile

This is to certify that the above plat was prepared from field notes of actual surveys made by me or under my supervision and that the same are true and correct to the best of my knowledge and belief.

(Seal)

Farmington, New Mexico

Date Surveyed

APRIL 16, 1962

Paul C. Wilson
 Registered Professional Engineer and/or Land Surveyor