

(SUBMIT IN TRIPLICATE)

UNITED STATES  
DEPARTMENT OF THE INTERIOR  
GEOLOGICAL SURVEY

Land Office Santa Fe  
Lease No. 011950  
Unit Surface Unit

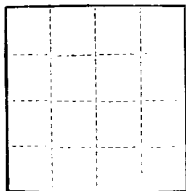

SUNDRY NOTICES AND REPORTS ON WELLS

NOTICE OF INTENTION TO DRILL	SUBSEQUENT REPORT OF WATER SHUT-OFF
NOTICE OF INTENTION TO CHANGE PLANS	SUBSEQUENT REPORT OF SHOOTING OR ACIDIZING
NOTICE OF INTENTION TO TEST WATER SHUT-OFF	SUBSEQUENT REPORT OF ALTERING CASING
NOTICE OF INTENTION TO RE-DRILL OR REPAIR WELL	SUBSEQUENT REPORT OF RE-DRILLING OR REPAIR
NOTICE OF INTENTION TO SHOOT OR ACIDIZE	SUBSEQUENT REPORT OF ABANDONMENT
NOTICE OF INTENTION TO PULL OR ALTER CASING	SUPPLEMENTARY WELL HISTORY
NOTICE OF INTENTION TO ABANDON WELL	

(INDICATE ABOVE BY CHECK MARK NATURE OF REPORT, NOTICE, OR OTHER DATA)

February 21, 1959

Well No. 107 (CD) is located 1460 ft. from N line and 1120 ft. from W line of sec. 35

NW Sec. 35 27N 10E S.M.P.M.  
(1/4 Sec. and Sec. No.) (Twp.) (Range) (Meridian)  
Angel Park Dk. Ext. & Wildcat Santa Juan New Mexico  
(Field) (County or Subdivision) (State or Territory)

The elevation of the derrick floor above sea level is 6000 ft.

DETAILS OF WORK

(State names of and expected depths to objective sands; show sizes, weights, and lengths of proposed casings; indicate mudding jobs, cementing points, and all other important proposed work)

This plat is re-issued to show dual completion well.

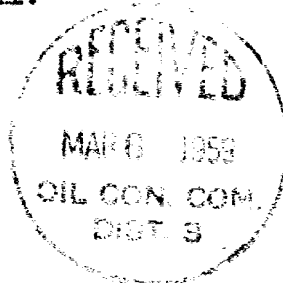

I understand that this plan of work must receive approval in writing by the Geological Survey before operations may be commenced.

El Paso Natural Gas Company  
Company  
Box 511  
Address Farmington, New Mexico  
ORIGINAL SIGNED J.J. TILLERSON  
By Petroleum Engineer  
Title

## NEW MEXICO OIL CONSERVATION COMMISSION

## Well Location and Acreage Dedication Plat

Section A.

Date OCTOBER 22, 1958

Operator EL PASO NATURAL GAS COMPANY Lease HUERFANO SF 077950  
 Well No. 107 (GD) Unit Letter E Section 35 Township 27-N Range 10-W NMPM  
 Located 1160 Feet From NORTH Line, 1180 Feet From WEST Line  
 County SAN JUAN G. L. Elevation 6650 Dedicated Acreage 120 & 10 Acres  
 Name of Producing Formation DAKOTA & GALLUP Pool ANGEL PEAK DAKOTA EXTENSION &

1. Is the Operator the only owner in the dedicated acreage outlined on the plat below? GALLUP WILDCAT

Yes \_\_\_\_\_ No X

2. If the answer to question one is "no", have the interests of all the owners been consolidated by communization agreement or otherwise? Yes X No \_\_\_\_\_. If answer is "yes", Type of Consolidation.

Unit Agreement

3. If the answer to question two is "no", list all the owners and their respective interests below:

Owner

Land Description



RECEIVED

MAR 4 1959

LOGIC NEW B

## Section B.

This is to certify that the information in Section A above is true and complete to the best of my knowledge and belief.

El Paso Natural Gas Company

(Operator)

ORIGINAL SIGNED J.J. TILLERSON

(Representative)

Box 997

(Address)

Farmington, New Mexico

Note: All distances must be from outer boundaries of section.

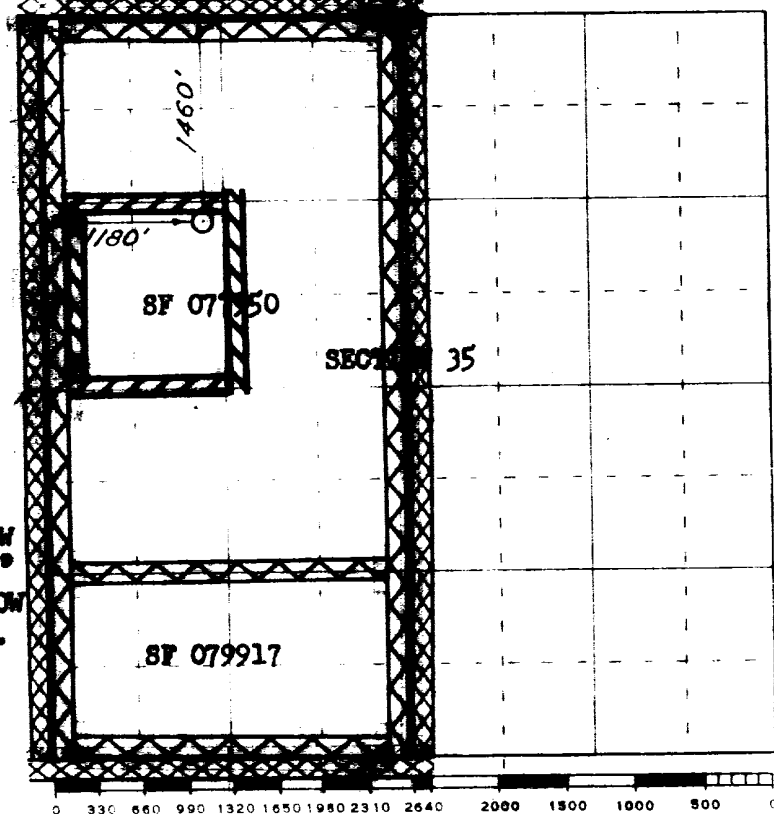

Scale 4 inches equal 1 mile

**NOTE:** THIS PLAT IS RE-ISSUED TO SHOW DUAL COMPLETION WELL. 2 19 59

**NOTE:** THIS PLAT IS RE-ISSUED TO SHOW CHANGE IN ACREAGE DEDICATION. 2 26 59

This is to certify that the above plat was prepared from field notes of actual surveys made by me or under my supervision and that the same are true and correct to the best of my knowledge and belief.

(Seal)

Date Surveyed OCTOBER 21, 1958

David O. Tillerson  
 Registered Professional Engineer and/or Land Surveyor

Farmington, New Mexico