

OIL CONSERVATION COMMISSION
1000 Rio Brazos Rd.
Aztec, New Mexico

OIL CONSERVATION COMMISSION
BOX 871
SANTA FE, NEW MEXICO

DATE 11-4-59

RE: Proposed NSP _____

Proposed NSL _____

Proposed NFO _____

Proposed DC ✓

Gentlemen:

I have examined the application dated 10-30-59
for the PAN AMERICAN JACK FREDER "B" 27-27N-10W
Operator Lease and Well No. S-T-R

and my recommendations are as follows:

Approve

Yours very truly,

OIL CONSERVATION COMMISSION
Arthur J. Smith



PAN AMERICAN PETROLEUM CORPORATION

P. O. Box 487, Farmington, New Mexico
October 30, 1959

File: B-2346-400.1

Subject: Application for Dual Completion
Jack Frost "B" No. 1

Mr. A. L. Porter (2)
New Mexico Oil Conservation Commission
P. O. Box 1901
Santa Fe, New Mexico

Dear Sir:

In accordance with the provisions of Rule No. 112-A, Multiple Completions, as amended by Order No. R-1214, dated July 3, 1958, Pan American Petroleum Corporation respectfully requests administrative approval to dually complete the Jack Frost "B" No. 1, located in Unit P, Section 27, T-27-N, R-10-W, San Juan County, New Mexico, in the Gallup (oil) and Dakota (gas) zones. Jack Frost "B" No. 1 is located approximately one mile east of our C. A. McAdams "B" No. 1, which was approved for dual completion in the same zones by Order No. DC-776, dated June 14, 1959.

As specified in Rule 112-A, we are submitting in quadruplicate an Application for Dual Completion, a Diagramatic Sketch of Dual Completion, a plat showing the location of the Jack Frost "B" No. 1 with respect to offsetting wells, including the names and addresses of offset operators. Also submitted is one copy of the electric log which has been posted with the required completion data.

Also being submitted in quadruplicate is a Packer Leakage Test which was completed successfully on October 27, 1959. Included with the Packer Leakage Test is the required packer setting affidavit.

By registered letter, offset operators are being furnished a copy of this letter and a copy of the Dual Completion Application.

Very truly yours,

PAN AMERICAN PETROLEUM CORPORATION

L. O. Speer, Jr.
L. O. Speer, Jr.
Area Superintendent

RBB:hh

cc: Mr. E. C. Arnold (2)
El Paso Natural Gas Co., Farmington, N. Mex.
Weaver & Brown, Denver, Colorado

COPY



SECRET

CONFIDENTIAL

CONFIDENTIAL

CONFIDENTIAL

CONFIDENTIAL

CONFIDENTIAL

CONFIDENTIAL

CONFIDENTIAL

CONFIDENTIAL

CONFIDENTIAL

CONFIDENTIAL



CONFIDENTIAL

CONFIDENTIAL

Reference Point - RDB Elev. 6544

10'

Ground Level Elev. 6534

490' of 9-5/8", 32.3# N-40 casing
set in 12-1/4" hole (cement circu-
lated to surface).

Top Cement 1867'

Two-stage cementing tool set
at 2544'.

Top Cement = 5265'

Gallup Perforations: 4 JSPF
6161-6187.

6323' of 2-3/8" 4.7# tubing; (with
2.910" O.D. tapered couplings)

6283' of 3/4" sucker rods and pump

Baker Model "D" Production Packer
set at 6800'

Dakota Perforations: 2 JSPF
6824-6862; 4 JSPF 6884-90 and
6910-25.

PBE - 6940'

6835' of 2-3/8" 4.7# tubing
(with 2.910" O.D. tapered
couplings) with Baker Model
"D" Anchor Tubing Seal Assembly.

6955' of 7" 20# & 23# casing set
in 8-3/4" hole

TD 6955'

PAN AMERICAN PETROLEUM CORPORATION

SCALE: None

RBE 10-30-57

Jack Frost "B" No. 1 - Diagramatic Sketch of Dual Completion Equipment

DRG.
NO



NEW MEXICO OIL CONSERVATION COMMISSION

SANTA FE, NEW MEXICO

7-3-58

APPLICATION FOR DUAL COMPLETION

Field Name Angels Peak Dakota		County San Juan	Date October 30, 1959
Operator Pan American Petroleum Corporation		Lease Jack Frost "B"	Well No. 1
Location of Well	Unit P	Section 27	Township 27N
		Range 10W	

1. Has the New Mexico Oil Conservation Commission heretofore authorized the dual completion of a well in these same pools or in the same zones within one mile of the subject well? YES ☒ NO ☐
2. If answer is yes, identify one such instance: Order No. **DC 776**; Operator, Lease, and Well No.: **Pan American Petroleum Corporation C. A. McAdams "B" No. 1**

3. The following facts are submitted:	Upper Zone	Lower Zone
a. Name of reservoir	Angels Peak Gallup	Angels Peak Dakota
b. Top and Bottom of Pay Section (Perforations)	6161-6187	6821-6925
c. Type of production (Oil or Gas)	Oil	Gas
d. Method of Production (Flowing or Artificial Lift)	Art. Lift	Flow

4. The following are attached. (Please mark YES or NO)

- Yes** a. Diagrammatic Sketch of the Dual Completion, showing all casing strings, including size and setting, top of cement, perforated intervals, tubing strings, including diameters and setting depth, location and type of packers and side door chokes, and such other information as may be pertinent.
- Yes** b. Plat showing the location of all wells on applicant's lease, all offset wells on offset leases, and the names and addresses of operators of all leases offsetting applicant's lease.
- Yes** c. Waivers consenting to such dual completion from each offset operator, or in lieu thereof, evidence that said offset operators have been furnished copies of the application.*
- Yes** d. Electrical log of the well or other acceptable log with tops and bottoms of producing zones and intervals of perforation indicated thereon. (If such log is not available at the time application is filed, it shall be submitted as provided by Rule 112-A.)

5. List all offset operators to the lease on which this well is located together with their correct mailing address.

El Paso Natural Gas Company, Box 997, Farmington, New Mexico

Wheeler & Brown, 337 Denver U. S. National Bank Bldg., Denver, Colorado

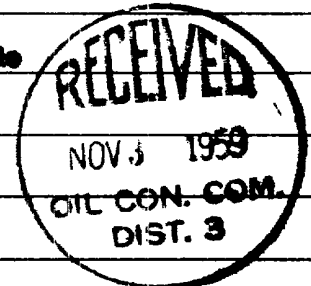

6. Were all operators listed in Item 5 above notified and furnished a copy of this application? YES ☒ NO ☐ . If answer is yes, give date of such notification **Registered Mail 10-30-59** .

CERTIFICATE: I, the undersigned, state that I am the **Area Foreman** of the **Pan American Petroleum Corporation** (company), and that I am authorized by said company to make this report; and that this report was prepared under my supervision and direction and that the facts stated therein are true, correct and complete to the best of my knowledge.

J. R. Stockton
J. R. Stockton Signature

- * Should waivers from all offset operators not accompany an application for administrative approval, the New Mexico Oil Conservation Commission will hold the application for a period of twenty (20) days from date of receipt by the Commission's Santa Fe office. If, after said twenty-day period, no protest nor request for hearing is received by the Santa Fe office, the application will then be processed.
- NOTE: If the proposed dual completion will result in an unorthodox well location and/or a non-standard proration unit in either or both of the producing zones, then separate application for approval of the same should be filed simultaneously with this application.

100

100

100

100

100

100

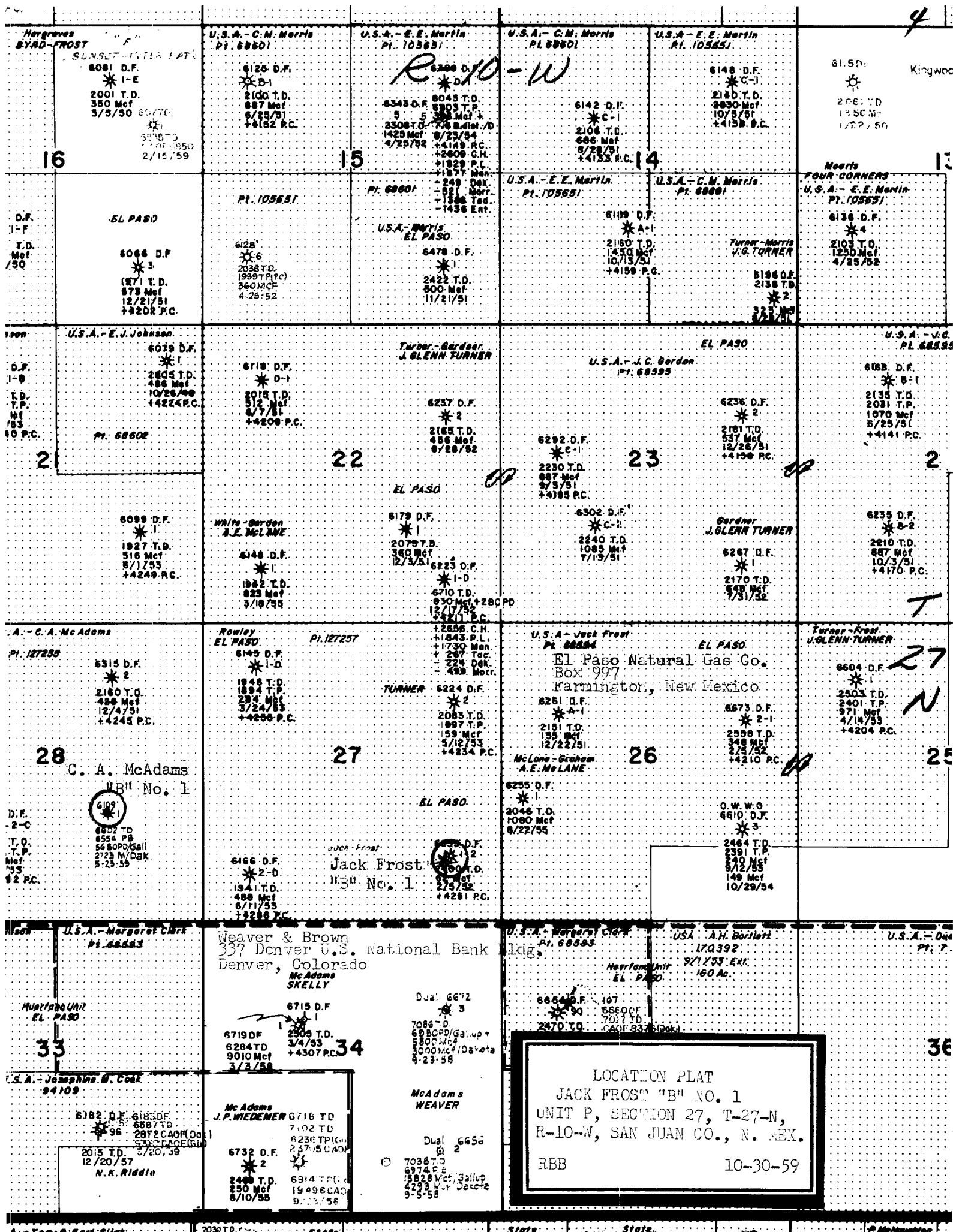

~~_____~~

~~_____~~

~~_____~~

•

•

•

PAN AMERICAN PETROLEUM CORPORATION

P. O. Box 487, Farmington, New Mexico
October 30, 1959

File: B-2346-400.1

Subject: Application for Dual Completion
Jack Frost "B" No. 1

Mr. A. L. Porter (2)
New Mexico Oil Conservation Commission
P. O. Box 1901
Santa Fe, New Mexico

Dear Sir:

In accordance with the provisions of Rule No. 112-A, Multiple Completions, as amended by Order No. R-1214, dated July 3, 1958, Pan American Petroleum Corporation respectfully requests administrative approval to dually complete the Jack Frost "B" No. 1, located in Unit P, Section 27, T-27-N, R-10-W, San Juan County, New Mexico, in the Gallup (oil) and Dakota (gas) zones. Jack Frost "B" No. 1 is located approximately one mile east of our C. A. McAdams "B" No. 1, which was approved for dual completion in the same zones by Order No. DC-776, dated June 14, 1959.

As specified in Rule 112-A, we are submitting in quadruplicate an Application for Dual Completion, a Diagrammatic Sketch of Dual Completion, a plat showing the location of the Jack Frost "B" No. 1 with respect to offsetting wells, including the names and addresses of offset operators. Also submitted is one copy of the electric log which has been posted with the required completion data.

Also being submitted in quadruplicate is a Packer Leakage Test which was completed successfully on October 27, 1959. Included with the Packer Leakage Test is the required packer setting affidavit.

By registered letter, offset operators are being furnished a copy of this letter and a copy of the Dual Completion Application.

Very truly yours,

PAN AMERICAN PETROLEUM CORPORATION

L. O. Speer, Jr.

L. O. Speer, Jr.
Area Superintendent

RBB:hh

cc: Mr. E. C. Arnold (2)
El Paso Natural Gas Co., Farmington, N. Mex.
Weaver & Brown, Denver, Colorado

COPY



RECEIVED
JAN 10 1945

U.S. DEPARTMENT OF THE ARMY

OFFICE OF THE CHIEF OF STAFF
WASHINGTON, D.C.

TO: THE CHIEF OF STAFF
FROM: THE CHIEF OF STAFF
SUBJECT: [Illegible]

[Illegible text block]

[Illegible text block]

[Illegible text block]

[Illegible text block]

[Illegible text block]

[Illegible text block]

[Illegible text block]

[Illegible text block]

[Illegible text block]

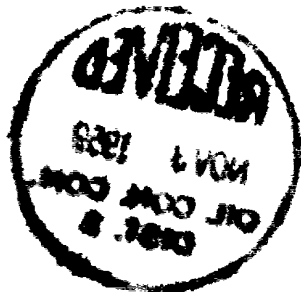

10-10-1944