

Form 9-831a
(Feb. 1961)

(SUBMIT IN TRIPLICATE)

Land Office Santa Fe
Lease No. 07232
Unit Polack

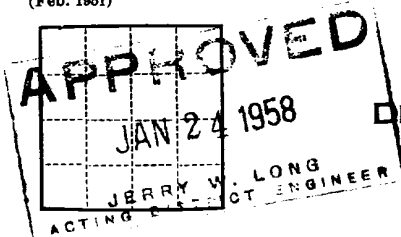

UNITED STATES
DEPARTMENT OF THE INTERIOR
GEOLOGICAL SURVEY

SUNDRY NOTICES AND REPORTS ON WELLS

NOTICE OF INTENTION TO DRILL.....	<input checked="" type="checkbox"/>	SUBSEQUENT REPORT OF WATER SHUT-OFF.....	
NOTICE OF INTENTION TO CHANGE PLANS.....		SUBSEQUENT REPORT OF SHOOTING OR ACIDIZING.....	
NOTICE OF INTENTION TO TEST WATER SHUT-OFF.....		SUBSEQUENT REPORT OF ALTERING CASING.....	
NOTICE OF INTENTION TO RE-DRILL OR REPAIR WELL.....		SUBSEQUENT REPORT OF RE-DRILLING OR REPAIR.....	
NOTICE OF INTENTION TO SHOOT OR ACIDIZE.....		SUBSEQUENT REPORT OF ABANDONMENT.....	
NOTICE OF INTENTION TO PULL OR ALTER CASING.....		SUPPLEMENTARY WELL HISTORY.....	
NOTICE OF INTENTION TO ABANDON WELL.....			

(INDICATE ABOVE BY CHECK MARK NATURE OF REPORT, NOTICE, OR OTHER DATA)

January 24, 1958

Well No. 11-c (FM) is located 1000 ft. from W/2 line and 1250 ft. from E/2 line of sec. 20
SW Sec. 20 27N 6W N.M.P.M.
(1/4 Sec. and Sec. No.) (Twp.) (Range) (Meridian)
Blanco & So. Blanco P.C. San Juan New Mexico
(Field) (County or Subdivision) (State or Territory)

The elevation of the derrick floor above sea level is 6205 ft.

DETAILS OF WORK

(State names of and expected depths to objective sands; show sizes, weights, and lengths of proposed casings; indicate mudding jobs, cementing points, and all other important proposed work)

It is intended to drill & dual complete a well in the Pictured Cliffs formation & Mesa Verde formation. Mud circulation will be used thru the Pictured Cliffs formation & set intermediate casing. Gas circulation will be used thru the Mesa Verde & a production liner will be set. Possible productive intervals will be perforated & fractured. Estimated Total Depth 4697'.

Casing Program:

10 3/4" at 170' with 125 sacks cement circulated to the surface.

7 5/8" at 4380' with 250 sacks cement.

5 1/2" liner at 4697' with 300 sacks cement.

The W/2 of Section 20 is dedicated to the Mesa Verde

The SW/4 of Section 20 is dedicated to the Pictured Cliffs

W/2 SF 07232

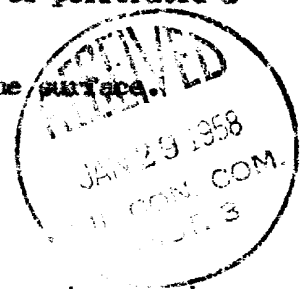

I understand that this plan of work must receive approval in writing by the Geological Survey before operations may be commenced.

Company El Paso Natural Gas Company
Address Box 997
Farmington, New Mexico
By Original Signed F. H. WOOD
Title Petroleum Engineer

NEW MEXICO OIL CONSERVATION COMMISSION

Well Location and Acreage Declaration Form

Date **JANUARY 22, 1958**

Section A:

Operator **EL PASO NATURAL GAS COMPANY** Lease **BOLACK** SF **079232**
 Well No. **11-C (PM)** Unit Letter **K** Section **28** Township **27-N** Range **8-W** NMPM
 Located **1800** Foot From **SOUTH** Line **1550** Foot From **WEST** Line
 County **SAN JUAN** G. L. Elevation **6195** Dedicated Acreage **320 & 160** Acres
 Name of Producing Formation **MESA VERDE & PICTURED CLIFF** Pool **BLANCO MV & SOUTH BLANCO FC**

1. Is the Operator the only owner in the indicated acreage outlined on the plat below?

Yes ☒ No ☐2. If the answer to question one is "No", have the interests of all the owners been consolidated by communitization or otherwise? Yes ☐ No ☐ If answer is "No", Type of Consolidation:

3. If the answer to question two is "No", list all the owners and their respective interests below:

Owner

Land Description

Section B:

This is to certify that the information in Section A above is true and complete to the best of my knowledge and belief.

El Paso Natural Gas Company

Operator

Original Signed **F. H. WOOD**

Representative

Box 997

Address

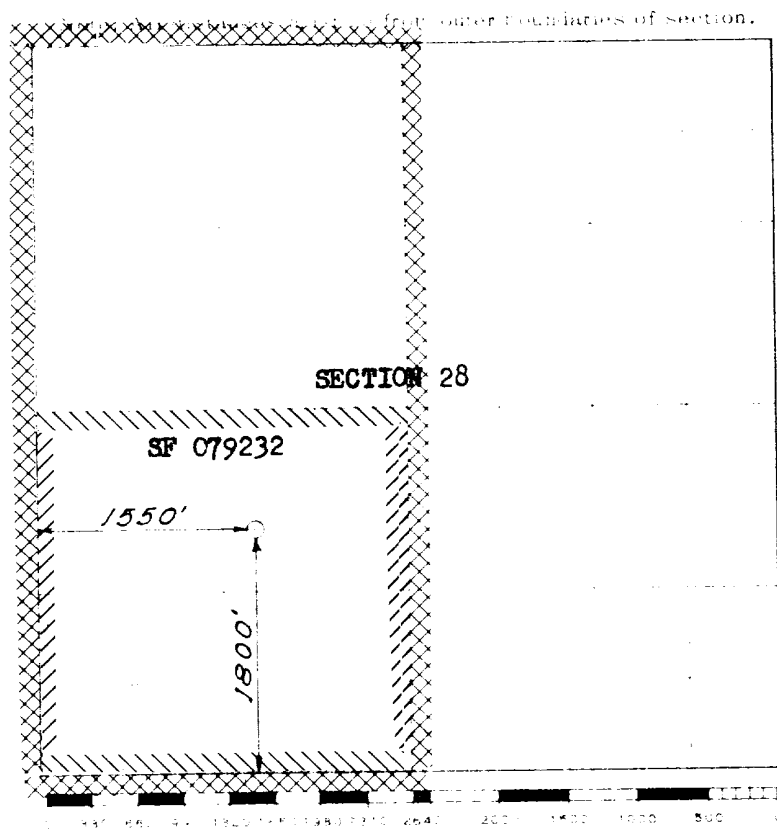
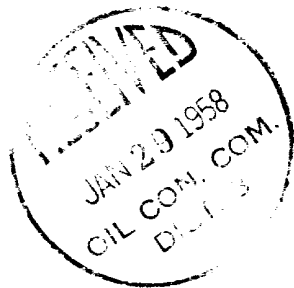
Farmington, New Mexico

Scale 1 inch = 1 mile

This is to certify that the above plat was prepared from field notes of actual surveys made by me or under my supervision and that the same are true and correct to the best of my knowledge and belief.

(Seal)

Date Surveyed **JANUARY 17, 1958**

David O. Wilson
 Registered Professional Engineer and/or Land Surveyor

Farmington, New Mexico