

(SUBMIT IN TRIPLICATE)

Land Office Santa Fe
071973
Lease No. _____
Unit E. H. NEWMAN

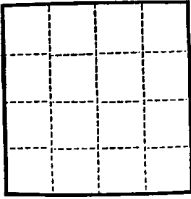

UNITED STATES
DEPARTMENT OF THE INTERIOR
GEOLOGICAL SURVEY

SUNDRY NOTICES AND REPORTS ON WELLS

NOTICE OF INTENTION TO DRILL.....	<input checked="" type="checkbox"/>	SUBSEQUENT REPORT OF WATER SHUT-OFF.....
NOTICE OF INTENTION TO CHANGE PLANS.....	<input type="checkbox"/>	SUBSEQUENT REPORT OF SHOOTING OR ACIDIZING.....
NOTICE OF INTENTION TO TEST WATER SHUT-OFF.....	<input type="checkbox"/>	SUBSEQUENT REPORT OF ALTERING CASING.....
NOTICE OF INTENTION TO RE-DRILL OR REPAIR WELL.....	<input type="checkbox"/>	SUBSEQUENT REPORT OF RE-DRILLING OR REPAIR.....
NOTICE OF INTENTION TO SHOOT OR ACIDIZE.....	<input type="checkbox"/>	SUBSEQUENT REPORT OF ABANDONMENT.....
NOTICE OF INTENTION TO PULL OR ALTER CASING.....	<input type="checkbox"/>	SUPPLEMENTARY WELL HISTORY.....
NOTICE OF INTENTION TO ABANDON WELL.....	<input type="checkbox"/>	

RECEIVED
FEB 12 1957
GEOLOGICAL SURVEY
NEW MEXICO

(INDICATE ABOVE BY CHECK MARK NATURE OF REPORT, NOTICE, OR OTHER DATA)

Farmington, New Mexico February 11, 1957

Well No. 2 is located 1650 ft. from S line and 860 ft. from W line of sec. 28

SW/4 of Section 28 T-27-N R-13-W HSPN
(1/4 Sec. and Sec. No.) (Twp.) (Range) (Meridian)
Wildcat San Juan New Mexico
(Field) (County or Subdivision) (State or Territory)

The elevation of the derrick floor above sea level is _____ ft. (To be reported later.)

DETAILS OF WORK

(State names of and expected depths to objective sands; show sizes, weights, and lengths of proposed casings; indicate mudding jobs, cementing points, and all other important proposed work)

We propose to drill the above well to the approximate depth of 6220' and test the Dakota formation. Rotary tools will be used to total depth. Stimulation and completion will be as indicated upon reaching this formation.

The following casing program is proposed:

SIZE	DEPTH	CEMENT	REMARKS
9-5/8"	500'	270	200% Theoretical amount to circulate.
5-1/2"	6220'		To be determined later.

Copies of location plat are attached. A copy of any survey taken will be submitted upon completion of well.

I understand that this plan of work must receive approval in writing by the Geological Survey before operations may be commenced.

Company PAN-AMERICAN PETROLEUM CORPORATION
Address P. O. BOX 487
FARMINGTON, NEW MEXICO

RECEIVED
FEB 13 1957
OIL CON. COMM.
DIST. 3
By [Signature]
Title Field Superintendent

NEW MEXICO
OIL CONSERVATION COMMISSION

Form C-128

Well Location and/or Gas Proration Plat

Date February 11, 1957

Operator Pan American Petroleum Corporation Lease E. H. Newman

Well No. 2 Section 28 Township 27 North Range 13 West NMPM

Located 1650 Feet From South Line, 860 Feet From West Line,

San Juan County, New Mexico. G. L. Elevation to be reported later

Name of Producing Formation Wildcat Pool Wildcat Dedicated Acreage 160

(Note: All distances must be from outer boundaries of Section)

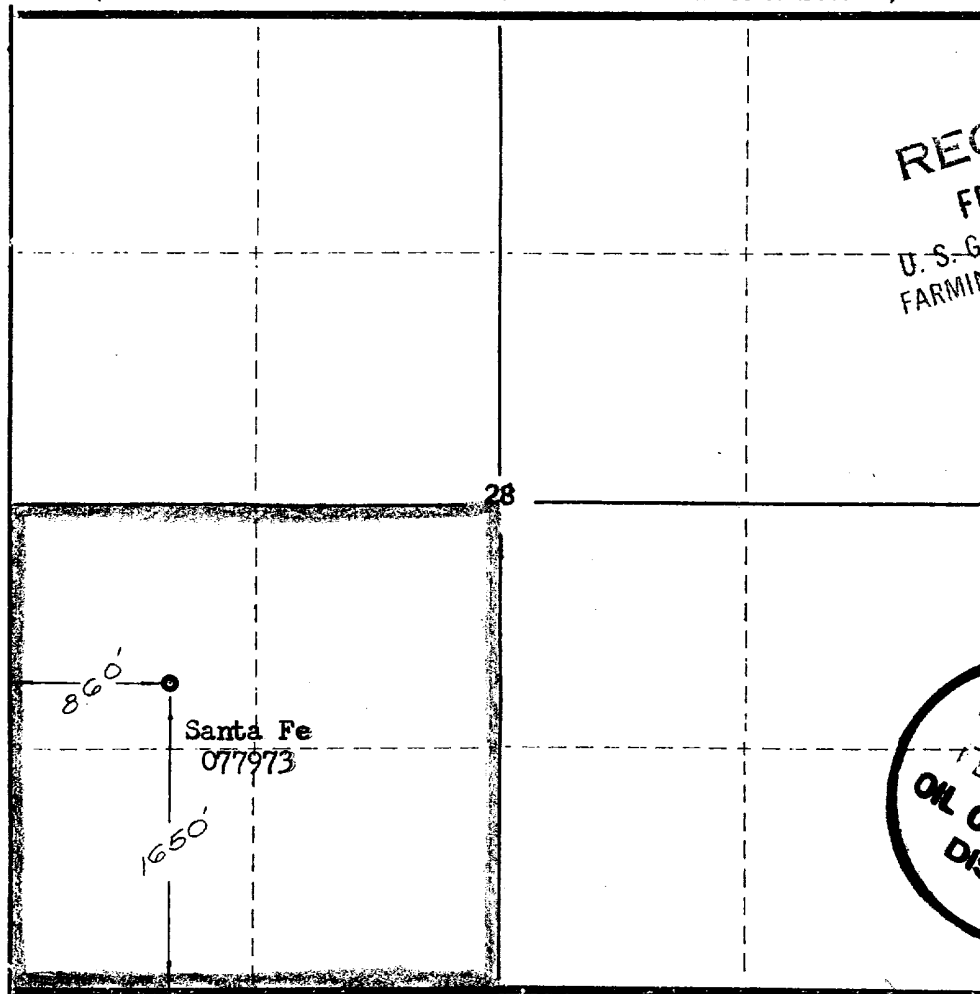

RECEIVED
FEB 12 1957
U. S. GEOLOGICAL SURVEY
FARMINGTON, NEW MEXICO

RECEIVED
FEB 13 1957
OIL CON. COM.
DIST. 3

NOTE
This section of form is to be used for gas wells only.

SCALE: 1"=1000'

1. Is this Well a Dual Comp. ? Yes... No X.
2. If the answer to Question 1 is yes, are there any other dually completed wells within the dedicated acreage?
Yes _____ No _____

Name R. M. Bauer, Jr. *RMBauer, Jr.*
Position Field Engineer
Representing Pan American Petroleum Corporation
Address Box 487, Farmington, New Mexico

This is to certify that the above plat was prepared from field notes of actual surveys made by me or under my supervision and that the same are true and correct to the best of my knowledge and belief.

Date Surveyed February 5, 1957
Ernest V. Echohawk
Ernest V. Echohawk
Reg. Land Surveyor, N. Mex., Reg. No. 1545