

(SUBMIT IN TRIPLICATE)

UNITED STATES
DEPARTMENT OF THE INTERIOR
GEOLOGICAL SURVEY

Land Office Santa Fe
Lease No. 077951
Unit SE/4 Sec. 26

SUNDRY NOTICES AND REPORTS ON WELLS

NOTICE OF INTENTION TO DRILL.....	<input checked="" type="checkbox"/>	SUBSEQUENT REPORT OF WATER SHUT-OFF.....	
NOTICE OF INTENTION TO CHANGE PLANS.....		SUBSEQUENT REPORT OF SHOOTING OR ACIDIZING.....	
NOTICE OF INTENTION TO TEST WATER SHUT-OFF.....		SUBSEQUENT REPORT OF ALTERING CASING.....	
NOTICE OF INTENTION TO RE-DRILL OR REPAIR WELL.....		SUBSEQUENT REPORT OF RE-DRILLING OR REPAIR.....	
NOTICE OF INTENTION TO SHOOT OR ACIDIZE.....		SUBSEQUENT REPORT OF ABANDONMENT.....	
NOTICE OF INTENTION TO PULL OR ALTER CASING.....		SUPPLEMENTARY WELL HISTORY.....	
NOTICE OF INTENTION TO ABANDON WELL.....			

(INDICATE ABOVE BY CHECK MARK NATURE OF REPORT, NOTICE, OR OTHER DATA)

August 17, 1953, 19

Well No. 3 is located 1,650 ft. from S line and 990 ft. from E line of sec. 26

SE/4 Sec. 26 (4 Sec. and Sec. No.)
27N 10W (Twp.) (Range)
N.P.M. (Meridian)
Fulcher-Kutz (Field)
San Juan (County or Subdivision)
New Mexico (State or Territory)

The elevation of the derrick floor above sea level is _____ ft.

DETAILS OF WORK

(State names of and expected depths to objective sands; show sizes, weights, and lengths of proposed casings; indicate mudding jobs, cementing points, and all other important proposed work)

Propose to drill with rotary tools to the top of the Pictured Cliff Formation - expected between 1,500 feet and 2,200 feet below surface; complete drilling with cable tools to bottom of Pictured Cliff formation; run shoot with solidified nitro-glycerine.

Casing program: 1 1/2 feet of 2 1/2" new J.L.C. 5" thread, 3 1/2" J.L.C. casing, when available. If not available, use 2 1/2" new J.L.C. casing. Circulate to surface. 4 1/2" 27" J.L.C. casing to be set in top of Pictured Cliff formation, cemented with 1 1/2 sacks regular cement.

1 1/2" casing to be set to within 50 feet of total depth for production.

I understand that this plan of work must receive approval in writing by the Geological Survey before operations may be commenced.
J. L. Turner

Company c/o San Juan Drilling Company
Address Box 722, Farmington, New Mexico

By [Signature]
Title _____

Company J. Glenn Turner

Lease Frost Well No. 3

Sec. 26, T. 27 N., R. 10 W., N.M.P.M.

Location 1650' from the South line and 990' from the East line.

Elevation 6610 Ungraded ground.

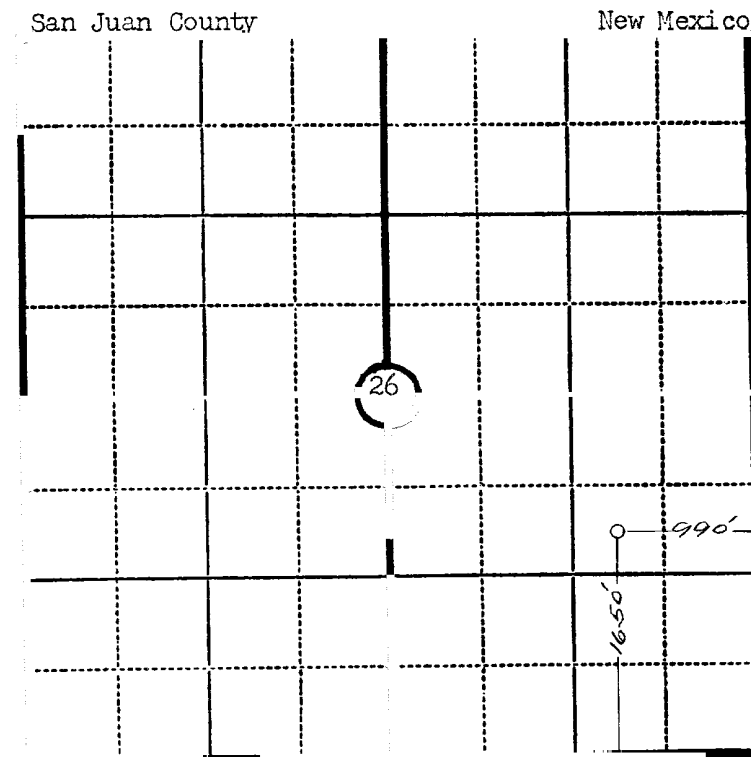

Scale—4 inches equal 1 mile.

This is to certify that the above plat was prepared from field notes of actual surveys made by me or under my supervision and that the same are true and correct to the best of my knowledge and belief.

Seal:

James P. Leese
Registered Professional
Engineer and Land Surveyor.

James P. Leese
N. Mex. Reg. No. 1463

Surveyed August 11, 1953

