

(SUBMIT IN TRIPLICATE)

UNITED STATES
DEPARTMENT OF THE INTERIOR
GEOLOGICAL SURVEY

Budget Bureau No. 42-B358.4
Approval expires 12-31-60.

Land Office **Santa Fe**
Lease No. **078092**
Unit **Gov't. Douthit**

SUNDRY NOTICES AND REPORTS ON WELLS

NOTICE OF INTENTION TO DRILL	<input checked="" type="checkbox"/>	SUBSEQUENT REPORT OF WATER SHUT-OFF	<input type="checkbox"/>
NOTICE OF INTENTION TO CHANGE PLANS	<input type="checkbox"/>	SUBSEQUENT REPORT OF SHOOTING OR ACIDIZING	<input type="checkbox"/>
NOTICE OF INTENTION TO TEST WATER SHUT-OFF	<input type="checkbox"/>	SUBSEQUENT REPORT OF ALTERING CASING	<input type="checkbox"/>
NOTICE OF INTENTION TO RE-DRILL OR REPAIR WELL	<input type="checkbox"/>	SUBSEQUENT REPORT OF RE-DRILLING OR REPAIR	<input type="checkbox"/>
NOTICE OF INTENTION TO SHOOT OR ACIDIZE	<input type="checkbox"/>	SUBSEQUENT REPORT OF ABANDONMENT	<input type="checkbox"/>
NOTICE OF INTENTION TO PULL OR ALTER CASING	<input type="checkbox"/>	SUPPLEMENTARY WELL HISTORY	<input type="checkbox"/>
NOTICE OF INTENTION TO ABANDON WELL	<input type="checkbox"/>		

(INDICATE ABOVE BY CHECK MARK NATURE OF REPORT, NOTICE, OR OTHER DATA)

February 27, 1961

Federal Douthit C
Well No. **2** is located **1850** ft. from **S** line and **790** ft. from **W** line of sec. **27**
NW SW Section 27 (1/4 Sec. and Sec. No.) 27N (Twp.) 11W (Range) N40M (Meridian)
West Kutz Canyon San Juan New Mexico
(Field) (County or Subdivision) (State or Territory)

The elevation of the ~~datum~~ above sea level is **6330** ft. KB Est.

DETAILS OF WORK

(State names of and expected depths to objective sands; show sizes, weights, and lengths of proposed casings; indicate mudding jobs, cementing points, and all other important proposed work)

To drill and test subject well to the Dakota formation. Estimated TD - 6630'.
Surface Casing: 8-5/8" 24" casing to be set at approximately 275' KB and cemented to surface. WOC 24 hours. Production Casing: 4-1/2", 11.6#/ft. J-55 casing to 6630' with stage collar set approx. 50' below Picture Cliff. Use centralizers and scratchers thru the Dakota and Gallup Sands. Cement with 300 sack 1:1 Pozmix with 2% gel on 1st stage and 150 sack neat cement on 2nd stage. No coring planned. Possibly Dakota DST. Logging: Combination ES-Induction Log from TD to surface casing. Detail ES-Induction Log and Sonic or Microlog, 5200' to TD. Run Gamma Ray-Collar Log in conjunction with perforating. Drilling Time: Geolograph from 300' to TD. Drift Surveys: At 50' intervals to 300'; thereafter at 250' intervals. Standard Depth Measurements: SLH of drill pipe at approx. 300' above the Lower Gallup Zone, prior to coring or DST, and at TD. Samples: Collect 10' samples from surface to TD, or as directed by wellsite geologist. If commercial production is obtained in both the Dakota and Gallup Sands, the well will be completed similarly to Fullerton #8.

I understand that this plan of work must receive approval in writing by the Geological Survey before operations may be commenced.

Company **The British-American Oil Producing Company**
Address **P. O. Box 180**
Denver, Colorado
By **Thomas M. Hogan**
Title **District Superintendent**

NUMBER OF COPIES RECEIVED	
DISTRIBUTION	
SANTA FE	
FILE	
U.S.G.S.	
LAND OFFICE	
TRANSPORTER	OIL GAS
PRODUCTION OFFICE	
OPERATOR	

NEW MEXICO OIL CONSERVATION COMMISSION
WELL LOCATION AND ACREAGE DEDICATION PLAT
 SEE INSTRUCTIONS FOR COMPLETING THIS FORM ON THE REVERSE SIDE

FORM C-128
 Revised 5/1/57

SECTION A

Operator BRITISH AMERICAN OIL PRODUCING COMPANY		Lease DOUTHIT		Well No. C - 2
Unit Letter L	Section 27	Township 27 NORTH	Range 11 WEST	County SAN JUAN
Actual Footage Location of Well: 1850 feet from the SOUTH line and 790 feet from the WEST line				
Ground Level Elev. 5350-6350	Producing Formation Dakota	Pool Dakota Dakota	Dedicated Acreage: 20 Acres	
Ref: GLO plat dated 19 July 1915				
1. Is the Operator the only owner in the dedicated acreage outlined on the plat below? YES <input checked="" type="checkbox"/> NO <input type="checkbox"/> ("Owner" means the person who has the right to drill into and to produce from any pool and to appropriate the production either for himself or for himself and another. (65-3-29 (e) NMSA 1935 Comp.)				
2. If the answer to question one is "no," have the interests of all the owners been consolidated by communization agreement or otherwise? YES <input type="checkbox"/> NO <input type="checkbox"/> . If answer is "yes," Type of Consolidation _____				
3. If the answer to question two is "no," list all the owners and their respective interests below:				
Owner The British-American Oil Producing Company		Land Description 1/2 Section 27-27N-11W		

SECTION B

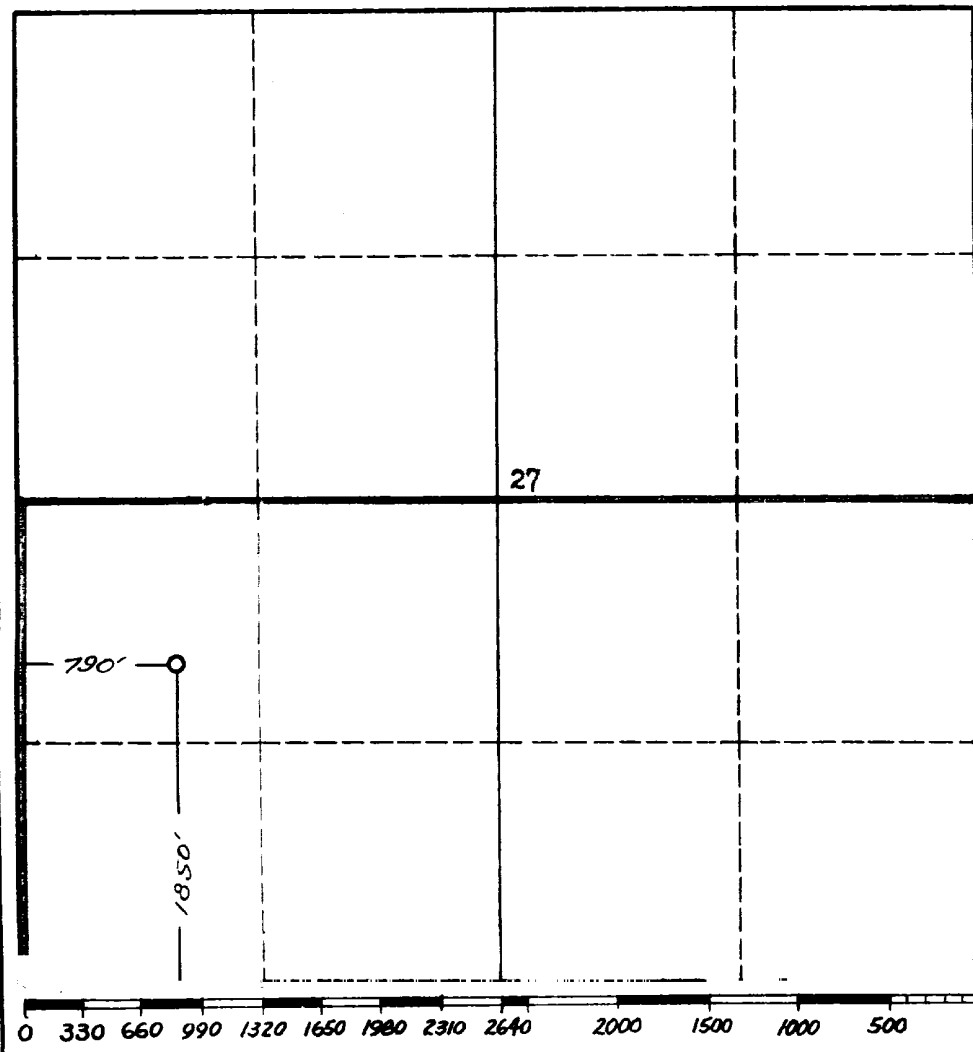

CERTIFICATION

I hereby certify that the information in SECTION A above is true and complete to the best of my knowledge and belief.

Name **Wes R. Stone**
 Position **Field Superintendent**
British-American Oil Prod. Co.
 Company **2-28-61**
 Date

I hereby certify that the well location shown on the plat in SECTION B was plotted from field notes of actual surveys made by me or under my supervision, and that the same is true and correct to the best of my knowledge and belief.

Date Surveyed **25 February 1961**
 Registered Professional Engineer and/or Land Surveyor
James P. Leese
James P. Leese
 Certificate No. **1463**

San Juan Engineering Company

INSTRUCTIONS FOR COMPLETION OF FORM C-128

1. Operator shall furnish and certify to the information called for in Section A.
2. Operator shall outline the dedicated acreage for *both* oil and gas wells on the plat in Section B.
3. A registered professional engineer or land surveyor registered in the State of New Mexico or approved by the Commission shall show on the plat the location of the well and certify this information in the space provided.
4. All distances shown on the plat must be from the outer boundaries of the Section.
5. If additional space is needed for listing owners and their respective interests as required in question 3 of Section A, please use space below.