

R11W

(SUBMIT IN TRIPLICATE)

UNITED STATES
T27N DEPARTMENT OF THE INTERIOR
GEOLOGICAL SURVEY

Land Office Santa Fe

Lease No. SF-080382-A

Unit RECEIVED

SUNDRY NOTICES AND REPORTS ON WELLS

NOTICE OF INTENTION TO DRILL	<input checked="" type="checkbox"/>	SUBSEQUENT REPORT OF WATER SHUT-OFF	
NOTICE OF INTENTION TO CHANGE PLANS		SUBSEQUENT REPORT OF SHOOTING OR ACIDIZING	
NOTICE OF INTENTION TO TEST WATER SHUT-OFF		SUBSEQUENT REPORT OF ALTERING CASING	
NOTICE OF INTENTION TO RE-DRILL OR REPAIR WELL		SUBSEQUENT REPORT OF RE-DRILLING OR REPAIR	
NOTICE OF INTENTION TO SHOOT OR ACIDIZE		SUBSEQUENT REPORT OF ABANDONMENT	
NOTICE OF INTENTION TO PULL OR ALTER CASING		SUPPLEMENTARY WELL HISTORY	
NOTICE OF INTENTION TO ABANDON WELL			

(INDICATE ABOVE BY CHECK MARK NATURE OF REPORT, NOTICE, OR OTHER DATA)

Frontier-Aztec Unit "B"

January 26, 1961

Well No. 1-D is located 1850 ft. from S line and 790 ft. from W line of sec. 28

NW/4 SW/4 Sec. 28
($\frac{1}{4}$ Sec. and Sec. No.)

27N
(Twp.)

11W
(Range)

N.M.P.M.
(Meridian)

Basin Dakota
(Field)

San Juan
(County or Subdivision)

New Mexico
(State or Territory)

The elevation of the derrick floor above sea level is _____ ft. Not yet run.

DETAILS OF WORK

(State names of and expected depths to objective sands; show sizes, weights, and lengths of proposed casings; indicate mudding jobs, cementing points, and all other important proposed work)

With Rotary Tools:
Drill 12 $\frac{1}{4}$ " hole to approximately 200'. Set 8 5/8" casing at approximately 200' and circulate cement to surface.
Drill 6 3/4" (or larger) hole to total depth at approximately 6500'.
(Cut 50' core in Dakota at approximately 6400').
Log and set 4 $\frac{1}{2}$ " casing at total depth. Two-stage cement to cover Dakota, Gallup, and Pictured Cliffs formations.
Complete in Dakota only.

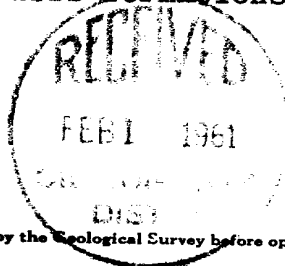

I understand that this plan of work must receive approval in writing by the Geological Survey before operations may be commenced.

Company THE FRONTIER REFINING COMPANY

Address 4040 East Louisiana Ave.

Denver 22, Colorado

By John L. Corkeil

Title Petroleum Engineer

NUMBER OF COPIES RECEIVED	
DISTRIBUTION	
SANTA FE	
FILE	
U.S.G.S.	
LAND OFFICE	
TRANSPORTER	OIL GAS
PRODUCTION OFFICE	
OPERATOR	

NEW MEXICO OIL CONSERVATION COMMISSION
WELL LOCATION AND ACREAGE DEDICATION PLAT
 SEE INSTRUCTIONS FOR COMPLETING THIS FORM ON THE REVERSE SIDE

FORM C-128
 Revised 5/1/57

SECTION A

Operator THE FRONTIER REFINING COMPANY		Lease FRONTIER - AZTEC UNIT "B"		Well No. 1 - D
Unit Letter L	Section 28	Township 27 NORTH	Range 11 WEST	County SAN JUAN
Actual Footage Location of Well: 1850 feet from the SOUTH line and 790 feet from the WEST line 6287.0 Ground Level Elev. Producing Formation Pool Dedicated Acreage: 3.20 Acres				

RECEIVED
 JAN 30 1961

Ref: GLO plat dated 19 July 1915

1. Is the Operator the only owner in the dedicated acreage outlined on the plat below? YES ☒ NO ____ ("Owner" means the person who has the right to drill into and to produce from any pool and to appropriate the production either for himself or for himself and another. (65-3-29 (e) NMSA 1935 Comp.)
2. If the answer to question one is "no," have the interests of all the owners been consolidated by communitization agreement or otherwise? YES ____ NO ____ . If answer is "yes," Type of Consolidation ____
3. If the answer to question two is "no," list all the owners and their respective interests below.

Owner	Land Description

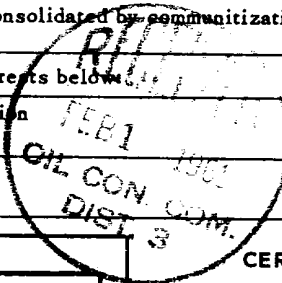

SECTION B

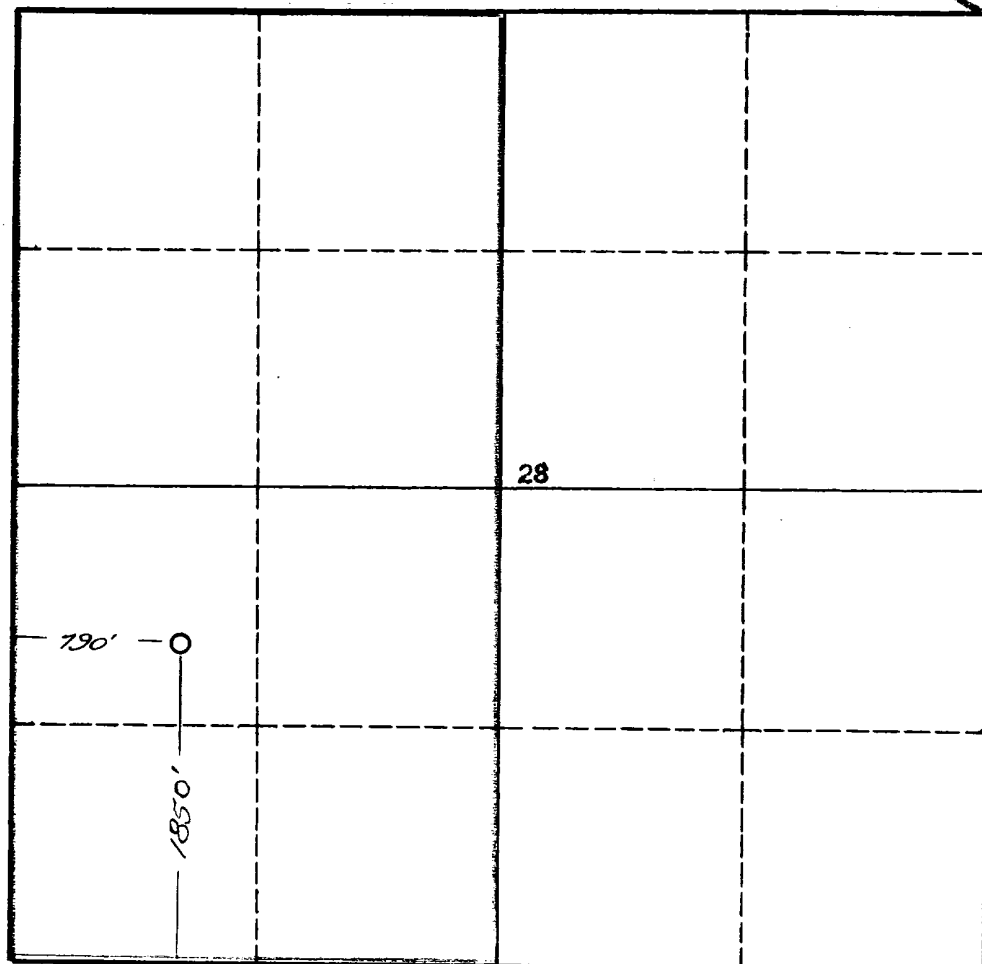

CERTIFICATION

I hereby certify that the information in SECTION A above is true and complete to the best of my knowledge and belief.

Name John L. Corkill
 Position Petr. Engr.
 Company Frontier Refining Co.
 Date Jan 30, 1961

I hereby certify that the well location shown on the plat in SECTION B was plotted from field notes of actual surveys made by me or under my supervision, and that the same is true and correct to the best of my knowledge and belief.

Date Surveyed 27 January 1961
 Registered Professional Engineer and/or Land Surveyor
James P. Lease
 Certificate No. 1463

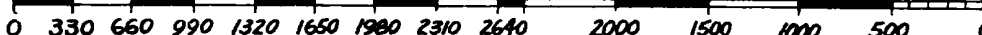

INSTRUCTIONS FOR COMPLETION OF FORM C-128

1. Operator shall furnish and certify to the information called for in Section A.
 2. Operator shall outline the dedicated acreage for *both* oil and gas wells on the plat in Section B.
 3. A registered professional engineer or land surveyor registered in the State of New Mexico or approved by the Commission shall show on the plat the location of the well and certify this information in the space provided.
 4. All distances shown on the plat must be from the outer boundaries of the Section.
 5. If additional space is needed for listing owners and their respective interests as required in question 3 of Section A, please use space below.
-