

(SUBMIT IN TRIPLICATE)

UNITED STATES  
DEPARTMENT OF THE INTERIOR  
GEOLOGICAL SURVEY

Land Office FM  
Lease No. 03605  
Unit RT 1 section 27  
Des. drilling unit

SUNDRY NOTICES AND REPORTS ON WELLS

NOTICE OF INTENTION TO DRILL.....	<input checked="" type="checkbox"/>	SUBSEQUENT REPORT OF WATER SHUT-OFF.....
NOTICE OF INTENTION TO CHANGE PLANS.....		SUBSEQUENT REPORT OF SHOOTING OR ACIDIZING.....
NOTICE OF INTENTION TO TEST WATER SHUT-OFF.....		SUBSEQUENT REPORT OF ALTERING CASING.....
NOTICE OF INTENTION TO RE-DRILL OR REPAIR WELL.....		SUBSEQUENT REPORT OF REDRILLING OR REPAIR.....
NOTICE OF INTENTION TO SHOOT OR ACIDIZE.....		SUBSEQUENT REPORT OF ABANDONMENT.....
NOTICE OF INTENTION TO PULL OR ALTER CASING.....		SUPPLEMENTARY WELL HISTORY.....
NOTICE OF INTENTION TO ABANDON WELL.....		

(INDICATE ABOVE BY CHECK MARK NATURE OF REPORT, NOTICE, OR OTHER DATA)

Well No. 2 is located 1953 ft. from N line and 546 ft. from E line of sec. 27  
27 (1/4 Sec. and Sec. No.) 27 (Twp.) 8 (Range) 111W (Meridian)  
Co. Blanco-Pio 01 San Juan New Mexico  
(Field) (County or Subdivision) (State or Territory)

The elevation of the derrick floor above sea level is 6105 ft. ~~XXXXXX~~

DETAILS OF WORK

(State names of and expected depths to objective sands; show sizes, weights, and lengths of proposed casings; indicate mudding jobs, cementing points, and all other important proposed work)

It is proposed to commence the drilling of a pictured cliffs test at the above location at once. Drilled as follows:

- To be drilled to approximate depth of 2200'
- To set approx 100' 9 5/8" surface casing and circulate cement to surface and test for water shutoff.
- To set approx 2100' 5 1/2" casing and cement with 150 sacks and to test for water shutoff
- To Electric Log, clean out with cable tools, shoot with SIS approx 6 quarts per foot
- To clean out, run 1" sypho and complete

I understand that this plan of work must receive approval in writing by the Geological Survey before operations may be commenced.

Company Frank B. Marshall  
Address Box 1407  
Hamilton, N.Y.

By Leon B Marshall  
Title Operator-Owner

Company..... Frank B. Marshall .....

Lease..... Well No.....

Sec. 27 ....., T. 27 N. ....., R. 8 W. ....., N.M.P.M. ....

Location 1953' from the North line and 546' from  
the East line.

Elevation 6097 Graded ground. .....

RECEIVED  
NOV 21 1953  
U. S. GEOLOGICAL SURVEY  
FEDERATION, N. M.

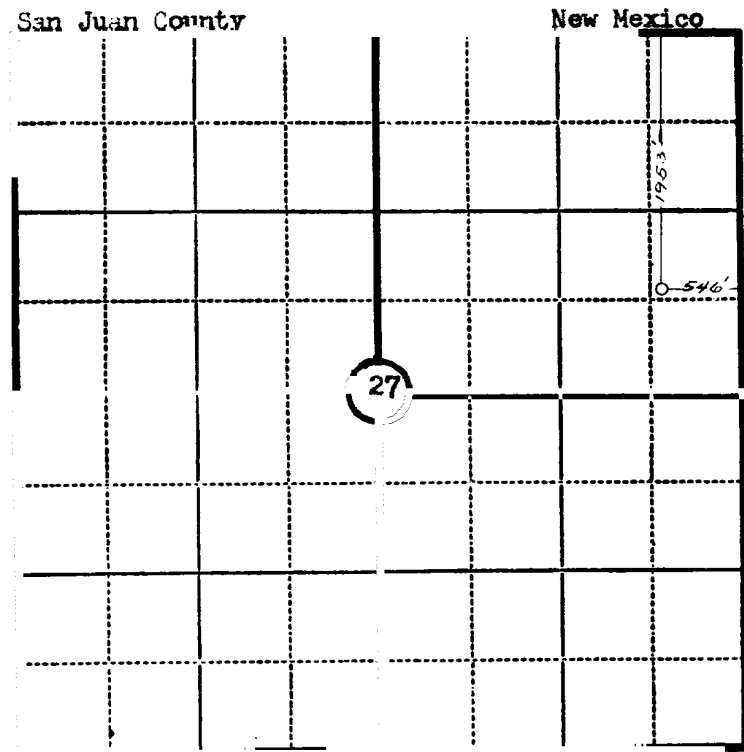

Scale—4 inches equal 1 mile.

This is to certify that the above plat was prepared from field notes of actual surveys made by me or under my supervision and that the same are true and correct to the best of my knowledge and belief.

Seal:

*James P. Leese*

Registered Professional  
Engineer and Land Surveyor.

James P. Leese  
N. Mex. Reg. No. 1463

Surveyed November 29 ....., 19 53