

(SUBMIT IN TRIPLICATE)

UNITED STATES
DEPARTMENT OF THE INTERIOR
GEOLOGICAL SURVEY

Land Office

Santa Fe

Lease No.

077304

Unit

SUNDRY NOTICES AND REPORTS ON WELLS

NOTICE OF INTENTION TO DRILL	<input checked="" type="checkbox"/>	SUBSEQUENT REPORT OF WATER SHUT-OFF	
NOTICE OF INTENTION TO CHANGE PLANS		SUBSEQUENT REPORT OF SHOOTING OR ACIDIZING	
NOTICE OF INTENTION TO TEST WATER SHUT-OFF		SUBSEQUENT REPORT OF ALTERING CASING	
NOTICE OF INTENTION TO RE-DRILL OR REPAIR WELL		SUBSEQUENT REPORT OF RE-DRILLING OR REPAIR	
NOTICE OF INTENTION TO SHOOT OR ACIDIZE		SUBSEQUENT REPORT OF ABANDONMENT	
NOTICE OF INTENTION TO PULL OR ALTER CASING		SUPPLEMENTARY WELL HISTORY	
NOTICE OF INTENTION TO ABANDON WELL			

(INDICATE ABOVE BY CHECK MARK NATURE OF REPORT, NOTICE, OR OTHER DATA)

March 13,

1956

Well No. **1** ~~NOTE~~ is located **1000** ft. from **[N]** line and **670** ft. from **[E]** line of sec. **30**

27 N 10 W

(1/4 Sec. and Sec. No.)

(Twp.)

(Range)

(Meridian)

FULCHER-NOTE (EXT)

San Juan

New Mexico

(Field)

(County or Subdivision)

(State or Territory)

The elevation of the derrick floor above sea level is **7077** ft.

DETAILS OF WORK

(State names of and expected depths to objective sands; show sizes, weights, and lengths of proposed casings; indicate mudding jobs, cementing points, and all other important proposed work)

Test To Penetrate CLIFFS Formation.

APPROXIMATELY 100' OF 43.5# 9 5/8" CASING.

APPROXIMATELY 1575' OF 12 1/2" PRODUCTION CASING.

Expected Total Depth 1675'.

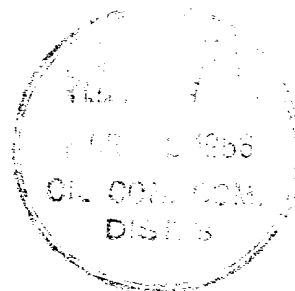

I understand that this plan of work must receive approval in writing by the Geological Survey before operations may be commenced.

Company **FAIRMONT OIL COMPANY, INC.**

Address **P. O. Box 936**

FARMINGTON, NEW MEXICO

By

E. H. Eder

Title

President

NEW MEXICO
OIL CONSERVATION COMMISSION

Form C-128

Well Location and/or Gas Proration Plat

Date _____

Operator Fairway Oil Company, Inc. Lease SANTA FE 077384

Well No. 1, Kutz Section 30 Township 27 North Range 10 West NMPM

Located 1830 Feet From North Line, 870 Feet From East Line,

San Juan County, New Mexico. G. L. Elevation 5969

Name of Producing Formation _____ Pool FULCHER-KUTZ Dedicated Acreage NE 1/4
160 Ac.

(Note: All distances must be from outer boundaries of Section)

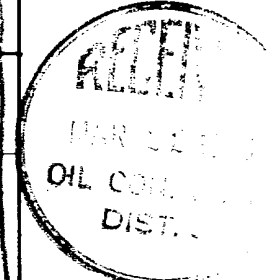
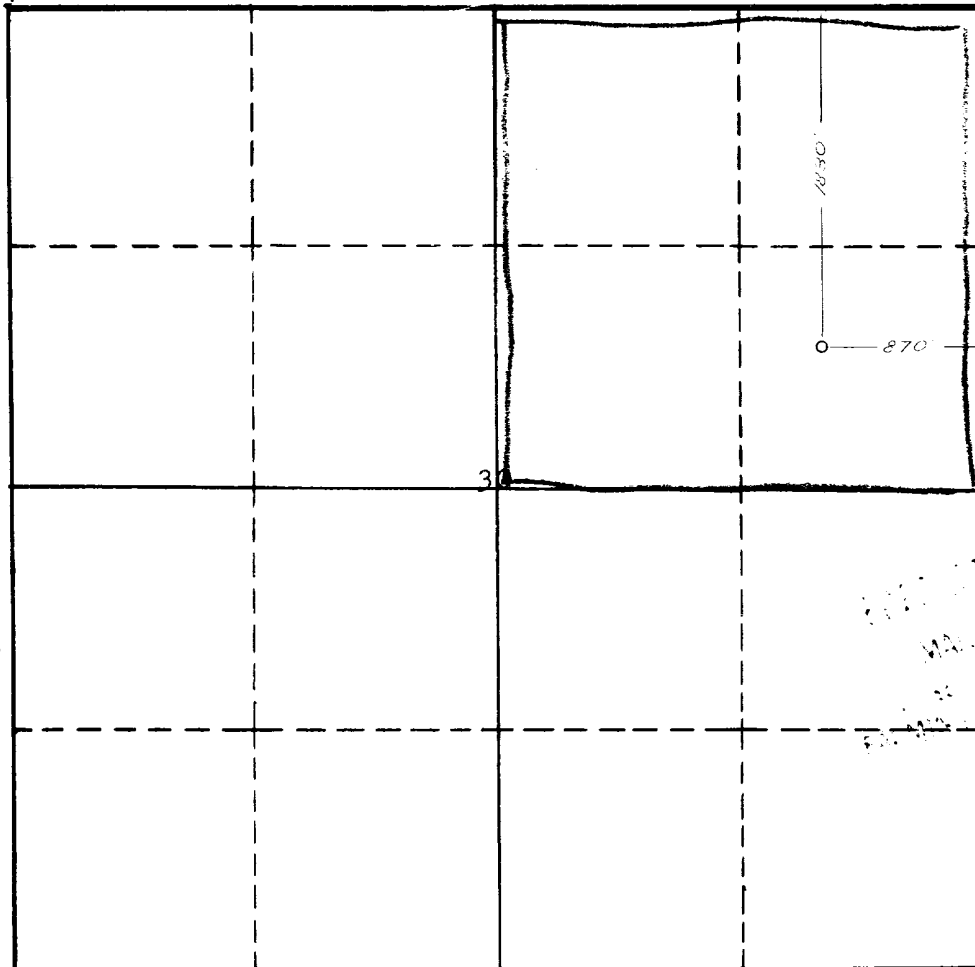

NOTE

This section of form is to be used for gas wells only.



SCALE: 1"=1000'

1. Is this Well a Dual Comp. ? Yes ___ No ___.
2. If the answer to Question 1 is yes, are there any other dually completed wells within the dedicated acreage ? Yes ___ No ___.

Name _____
Position _____
Representing _____
Address _____

This is to certify that the above plat was prepared from field notes of actual surveys made by me or under my supervision and that the same are true and correct to the best of my knowledge and belief.

Date Surveyed March 7, 1956
Ernest J. Galt
Registered Professional Engineer and/or Land Surveyor