



COPY TO D. S. G.

UNITED STATES
DEPARTMENT OF THE INTERIOR
GEOLOGICAL SURVEY
P. O. Box 965
Farmington, New Mexico

IN REPLY REFER TO:

May 21, 1956



J. Glenn Turner
Box 72^a
Farmington, New Mexico

Re: Navajo I-140-Ind-8473

Gentlemen:

Receipt is acknowledged of your "Notice of Intention to Drill" dated May 19, 1956 covering your well No. 1-25 Turner-Navajo in NE¹ sec. 25, T. 27 N., R. 9 W., N. M. P. M., San Juan County, New Mexico, So. Blanco P.C.

Your proposed work is hereby approved subject to compliance with the provisions of the "Oil and Gas Operating Regulations" revised May 25, 1942, a copy of which will be sent to you on request, and subject to the following conditions:

1. Drilling operations so authorized are subject to the attached sheet for general conditions of approval.
- 2.. Furnish copies of all logs.

Very truly yours,

P. T. McGrath

P. T. McGrath
District Engineer

PTMcGrath:sac
cc - Navajo Agency

IN REPLY REFER TO:

UNITED STATES
DEPARTMENT OF THE INTERIOR
GEOLOGICAL SURVEY

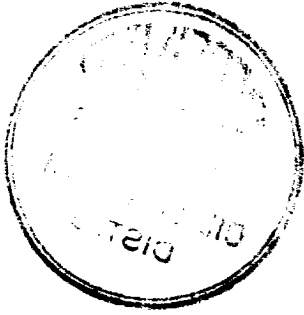

March 3, 1849

Very respectfully,
Your obedient servant,
[Signature]

Enclosed for the [Name]
[Address]
[City, State]

Very truly yours,
[Signature]

[Name]
[Title]

[Text]

[Text]

[Text]

(SUBMIT IN TRIPLICATE)

Indian Agency Navajo

UNITED STATES
DEPARTMENT OF THE INTERIOR
GEOLOGICAL SURVEY

Allottee -----
 Lease No. I-149-Ind.-8473

Lease No. 1-149-Ind.-0473

			X

SUNDRY NOTICES AND REPORTS ON WELLS

NOTICE OF INTENTION TO DRILL	box	SUBSEQUENT REPORT OF WATER SHUT-OFF
NOTICE OF INTENTION TO CHANGE PLANS		SUBSEQUENT REPORT OF SHOOTING OR ACIDIZING
NOTICE OF INTENTION TO TEST WATER SHUT-OFF		SUBSEQUENT REPORT OF ALTERING CASING
NOTICE OF INTENTION TO REDRILL OR REPAIR WELL		SUBSEQUENT REPORT OF REDRILLING OR REPAIR
NOTICE OF INTENTION TO SHOOT OR ACIDIZE		SUBSEQUENT REPORT OF ABANDONMENT
NOTICE OF INTENTION TO PULL OR ALTER CASING		SUPPLEMENTARY WELL HISTORY
NOTICE OF INTENTION TO ABANDON WELL		

(INDICATE ABOVE BY CHECK MARK NATURE OF REPORT, NOTICE, OR OTHER DATA)

May 19, 1956. 19

Turner-Nava jo

Well No. 1-25 is located 1,650 ft. from [N] line and 895 ft. from [E] line of sec. 25

NE 1/4 Sec. 25

(34 Sec. and Sec. No.)

T 27-N R 9-W

(Twp.)

(Range)

N.M.P.M.

(Meridian)

So. Blanco P. C.

(Field)

San Juan County

(County or Subdivision)

New Mexico

(State or Territory)

The elevation of the derrick floor above sea level is 6,120 ft.

DETAILS OF WORK

(State names of and expected depths to objective sands; show sizes, weights, and lengths of proposed casings; indicate mudding jobs, cementing points, and all other important proposed work)

NE 1/4 of Section 25 is dedicated to this well.

Propose to spud with cable tools; then drill with rotary tools to the top of the Pictured Cliffs formation - expected between 1,900 feet and 2,200 feet below the surface. Completion with cable tools - and sand oil fracturing and/or shooting with solidified nitro-glycerin as conditions warrant.

Casing program: 90 feet of 8-5/8" new 8 rd. thd. 24# casing. Circulate cement to surface, using at least 70 sacks of cement.

5-1/2" OD ~~J-55 casing~~ J-55 - 11# casing to be set on top of Pictured Cliffs formation, cemented with 100 sacks regular cement.

1" tubing to be set within 20 feet of total depth for production.

I understand that this plan of work must receive approval in writing by the Geological Survey before operations may be commenced.

Company J. Glenn Turner, et

Address _____ Box 728

Farmington, New Mexico

By C. Beeson Neal
C. Beeson Neal, Agent in Farmington
Title _____

NEW MEXICO
OIL CONSERVATION COMMISSION

Form C-128

Well Location and/or Gas Proration Plat

Date May 19, 1956

Operator J. GLENN TURNER Lease Navajo

Well No. 1-25 Section 25 Township 27 NORTH Range 9 WEST, NMPM

Located 1650 Feet From the NORTH Line, 895 Feet From the EAST Line,

SAN JUAN County, New Mexico. G. L. Elevation 6112.0 UNGRADED.

Name of Producing Formation Pictured Cliffs Pool So. Blanco Dedicated Acreage ~~159.51~~

(Note: All distances must be from outer boundaries of Section)

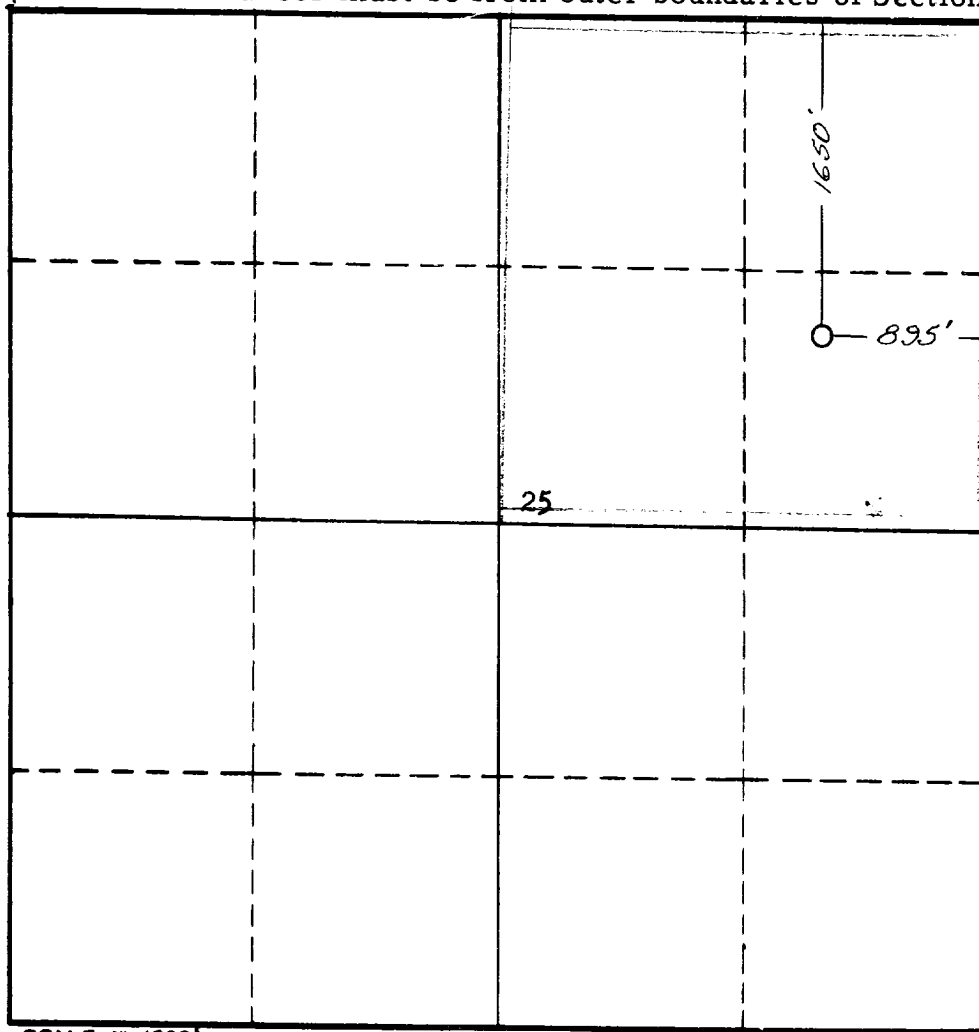

NOTE

This section of
form is to be
used for gas
wells only.



SCALE: 1"=1000'

1. Is this Well a Dual Comp. ? Yes No x.
2. If the answer to Question 1 is yes, are there any other dually completed wells within the dedicated acreage ? Yes No .

Name G. Beeson Neal
Position G. Beeson Neal, Agent in Farmington
Representing J. Glenn Turner
Address Box 728 - Farmington, New Mexico

This is to certify that the above plat was prepared from field notes of actual surveys made by me or under my supervision and that the same are true and correct to the best of my knowledge and belief.

Date Surveyed 18 MARCH 1956
James P. Leese
Registered Professional Engineer and/or
Land Surveyor James P. Leese
N. Mex. Reg. No. 1463

EL PASO NATURAL GAS COMPANY - Wells Requiring File Corrections Only

3-25-68

Page 3

<u>LEASE NAME & WELL NUMBER</u>	<u>LOCATION</u>	<u>POOL</u>	<u>PRESENT ACREAGE</u>	<u>CORRECT ACREAGE</u>
San Juan 28-7 Unit #103	A-3-27N-7W	So. Blanco PC	159.12	159.25 ✓
San Juan 28-7 Unit #103	A-3-27N-7W	Blanco MV	E 319.12	E 319.25 ✓
San Juan 28-7 Unit #95	M-4-27N-7W	Blanco MV	W 318.79	W 319.79 ✓
Filan #4	H-5-27N-8W	Blanco MV	E 322.27	E 321.48 ✓
Lodewick #3	D-19-27N-9W	Ful.Kutz PC	160	160.88 ✓
Turner Navajo #1	H-25-27N-9W	So. Blanco PC	159.51	160 ✓
Huerfanito Unit #74	M-19-27N-10W	Ful.Kutz PC	166.99	167.19
San Juan 28-4 Unit #29	M-31-28N-4W	Basin Dakota	W 319.38	W 319.56 ✓
Florance C #1	A-19-28N-8W	Blanco MV	N 313	N 312.52 ✓
Schwerdtfeger A #10	L-31-28N-8W	So. Blanco PC	137.54	137.59 ✓
Howell #3	N-34-28N-8W	Blanco MV	S 301	S 301.04 ✓
Storey C #9	L-34-28N-9W	Blanco MV	S 338.47	S 338.45 ✓
Indian A #2	N-30-29N-3W	Choza Mesa PC	253.55	253.63
San Juan 29-4 Unit #1	K-30-29N-4W	Blanco MV	320	W 318.10 ✓
San Juan 29-7 Unit #83	A-3-29N-7W	Blanco MV	E 318.04	E 318.05 ✓
Sunray #1	M-5-29N-8W	Blanco MV	W 324.84	W 324.94 ✓
Riddle A #2	H-1-29N-9W	Blanco MV	E 332.95	E 332.05 ✓
San Juan #20	K-35-29N-9W	Aztec PC	153.05	153.07 ✓
Ludwick #13	G-5-29N-10W	Aztec PC	161.81	160.86 ✓
Ludwick #13	G-5-29N-10W	Blanco MV	N 321.81	N 321.84 ✓
Duff #1	E-5-29N-11W	Aztec PC	148	147.76 ✓
Schultz Com F #11	D-36-29N-11W	Aztec Fruit.	160	158.61 ✓
White Allen #1	F-1-29N-12W	Ful.Kutz PC	160	160.20 ✓
San Juan 30-4 Unit #10	F-27-30N-4W	E. Blanco PC	159.96	159.99 ✓
San Juan 31-6 Unit #14	M-5-30N-6W	Blanco MV	W 319.84	W 319.49 ✓
Howell A #3	M-4-30N-8W	Blanco MV	320	320.50 ✓
Howell C #4	M-18-30N-8W	Blanco MV	334.95, W $\frac{1}{2}$ 18 SW $\frac{1}{4}$ 7	334.94 ✓