

NEW MEXICO OIL CONSERVATION COMMISSION
Santa Fe, New Mexico

Form C-101
Revised (12/1/55)

NOTICE OF INTENTION TO DRILL

Notice must be given to the District Office of the Oil Conservation Commission and approval obtained before drilling or recompletion begins. If changes in the proposed plan are considered advisable, a copy of this notice showing such changes will be returned to the sender. Submit this notice in QUINTUPLICATE. One copy will be returned following approval. See additional instructions in Rules and Regulations of the Commission. If State Land submit 6 Copies Attach Form C- 128 in triplicate to first 3 copies of form C-101

December 4, 1958

(Place)

(Date)

OIL CONSERVATION COMMISSION
SANTA FE, NEW MEXICO

Gentlemen:

You are hereby notified that it is our intention to commence the Drilling of a well to be known as GOV't. #1 - Newman
UTAH SOUTHERN OIL COMPANY, 1825 First National Bank Bldg., Denver 2, Colorado

(Company or Operator)

FEDERAL LEASE SF 077973-B

(Lease)

, Well No. 1, in (Unit) The well is

located 1980 feet from the West line and 1980 feet from the

North

line of Section 27, T. 27 North, R. 13 West, NMPM.

(GIVE LOCATION FROM SECTION LINE)

San Juan

County

D	C	B	A
E	27	G	H
L	K	J	I
M	N	O	P

If State Land the Oil and Gas Lease is No.

If patented land the owner is.

Address.

We propose to drill well with drilling equipment as follows: Rotary Tools

The status of plugging bond is on file with U. S. Government

Drilling Contractor Arapahoe Drilling Company

We intend to complete this well in the Gallup Sand
formation at an approximate depth of 5500 feet.

CASING PROGRAM

We propose to use the following strings of Casing and to cement them as indicated:

Size of Hole	Size of Casing	Weight per Foot	New or Second Hand	Depth	Sacks Cement
12 1/4	9 5/8	32.30	Used	200'	200
7 3/4	5 1/2	14	New J-55	5500'	300

If changes in the above plans become advisable we will notify you immediately.

ADDITIONAL INFORMATION (If recompletion give full details of proposed plan of work.)

Approved: Fred Lease, 19.....
Except as follows:

OIL CONSERVATION COMMISSION

By.....

Sincerely yours,

UTAH SOUTHERN OIL COMPANY

(Company or Operator)

By: Harry E. McDonald
Production Superintendent

Position: Send Communications regarding well to

Name: Harry E. McDonald

Address: 1825 First National Bank Bldg.

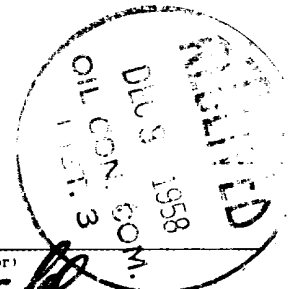

NEW MEXICO OIL CONSERVATION COMMISSION
Well Location and Acreage Dedication Plat

Section A.

Date December

FEDERAL LEASE SF 077973-B

Operator UTAH-SOUTHERN OIL COMPANY Lease UTAH SOUTHERN OIL CO. #1 GOV'T.-NEWMAN
Well No. _____ Unit Letter F Section 27 Township 27 NORTH Range 13 WEST NMPM
Located 1980 Feet From THE NORTH Line, 1980 Feet From THE WEST Line
County SAN JUAN G. L. Elevation 6110.0 Dedicated Acreage 40 Acres
Name of Producing Formation _____ Pool _____

1. Is the Operator the only owner* in the dedicated acreage outlined on the plat below?
Yes XX No _____.
2. If the answer to question one is "no," have the interests of all the owners been consolidated by communitization agreement or otherwise? Yes _____ No _____. If answer is "yes," Type of Consolidation _____
3. If the answer to question two is "no," list all the owners and their respective interests below:
Ref: GLO Plat dated 19 July 1915

Owner

Land Description

Section B

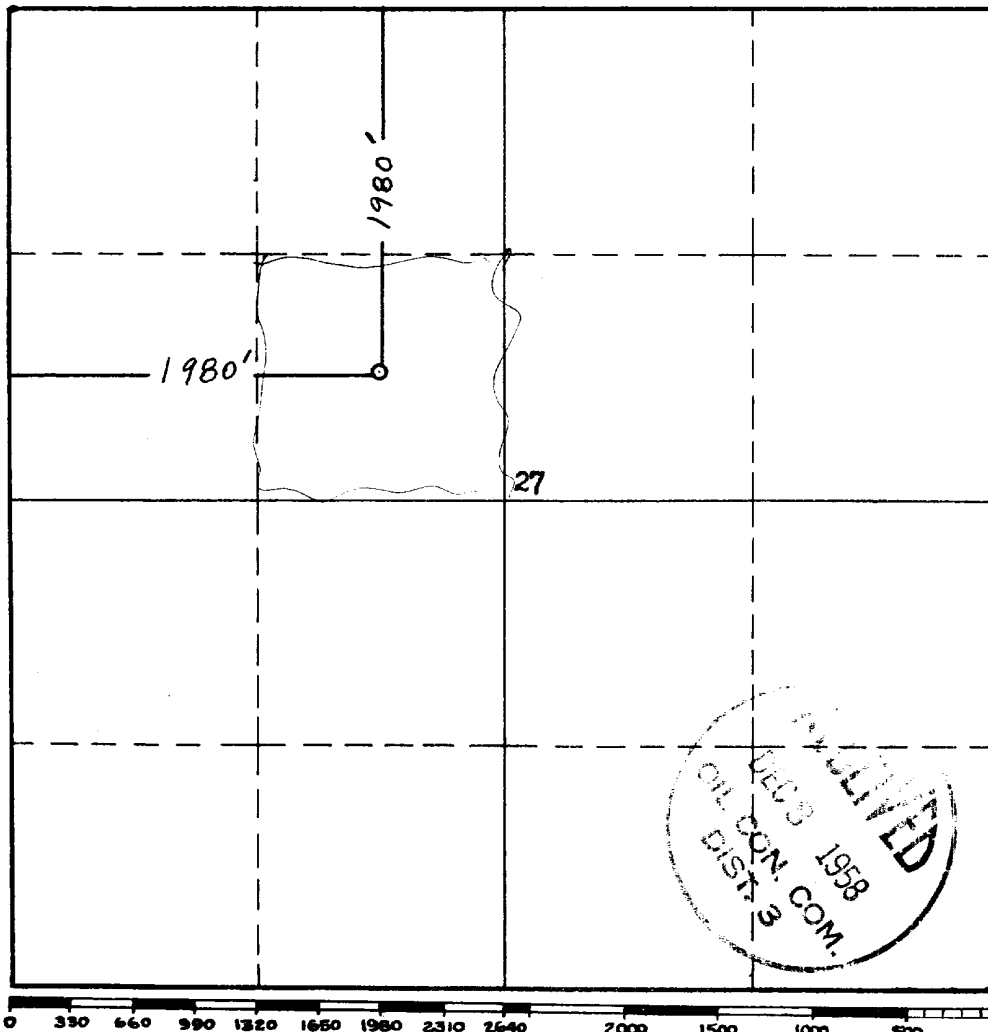

This is to certify that the information in Section A above is true and complete to the best of my knowledge and belief.

UTAH SOUTHERN OIL COMPANY

(Operator)

Harry E. McDonald, Prod. Supt.
(Representative)
1825 First Nat'l Bank Bldg.
Denver 2, Colorado.

Address

This is to certify that the well location shown on the plat in Section B was plotted from field notes of actual surveys made by me or under my supervision and that the same is true and correct to the best of my knowledge and belief.

Date Surveyed 2 Dec. 1958

James P. Lease
Registered Professional
Engineer and/or Land Surveyor.
James P. Lease

Certificate No. 1463

(See instructions for completing this form on the reverse side)

INSTRUCTIONS FOR COMPLETION:

1. Operator shall furnish and certify to the information called for in Section A.
2. Operator shall outline the dedicated acreage for both oil and gas wells on the plat in Section B.
3. A registered professional engineer or land surveyor registered in the State of New Mexico or approved by the Commission shall show on the plat the location of the well and certify this information in the space provided.
4. All distances shown on the plat must be from the outer boundaries of Section.
5. If additional space is needed for listing owners and their respective interests as required in question 3, Section A, please use space below

* "Owner" means the person who has the right to drill into and to produce from any pool and to appropriate the production either for himself or for himself and another. (65-3-29 (e) NMSA 1953 Comp.)