

3-USGS

1-WD

1-F

1-F

(SUBMIT IN TRIPLICATE)

Budget Bureau No. 42-R358.
Approval expires 12-31-60.

Land Office

Lease No.

Unit

SF-078069

Hancock Federal

UNITED STATES
DEPARTMENT OF THE INTERIOR
GEOLOGICAL SURVEY

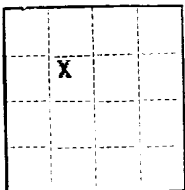

SUNDRY NOTICES AND REPORTS ON WELLS

NOTICE OF INTENTION TO DRILL	XX	SUBSEQUENT REPORT OF WATER SHUT-OFF
NOTICE OF INTENTION TO CHANGE PLANS		SUBSEQUENT REPORT OF SHOOTING OR ACIDIZING
NOTICE OF INTENTION TO TEST WATER SHUT-OFF		SUBSEQUENT REPORT OF ALTERING CASING
NOTICE OF INTENTION TO RE-DRILL OR REPAIR WELL		SUBSEQUENT REPORT OF RE-DRILLING OR REPAIR
NOTICE OF INTENTION TO SHOOT OR ACIDIZE		SUBSEQUENT REPORT OF ABANDONMENT
NOTICE OF INTENTION TO PULL OR ALTER CASING		SUPPLEMENTARY WELL HISTORY
NOTICE OF INTENTION TO ABANDON WELL		

(INDICATE ABOVE BY CHECK MARK NATURE OF REPORT, NOTICE, OR OTHER DATA)

April 26, 1962

Well No. 6 is located 1680 ft. from ^(N)~~15X~~ line and 1565 ft. from ^(W)~~15X~~ line of sec. 25

SE/4 NW/4 Sec. 25
(1/4 Sec. and 1/4 Sec. No.)

27N
(Twp.)

11W
(Range)

NMPM
(Meridian)

Basin Dakota
(Field)

San Juan
(County or Subdivision)

New Mexico
(State or Territory)

The elevation of the ~~derrick floor~~ ^{Ground level} above sea level is 6305 ft.

DETAILS OF WORK

(State names of and expected depths to objective sands; show sizes, weights, and lengths of proposed casings; indicate mudding jobs, cementing points, and all other important proposed work)

Propose to drill with rotary tools to an estimated depth of 6700 feet or to test the Dakota formation. Casing program will be as follows:

10 3/4" 32.75# casing set at approximately 200' with 150 sx cement.

4 1/2" 10.50# casing set at total depth with 425 sx or enough to cover the Gallup formation.

A DV tool will be placed for the protection of the Pictured Cliffs formation.

Will Perforate and Sand-Water frac the Dakota formation.

I understand that this plan of work must receive approval in writing by the Geological Survey before operations may be commenced.

Company Southwest Production Company

Address 207 Petr. Club Plaza

Farmington, N. M.

Original signed by
Carl W. Smith

By

Title Superintendent

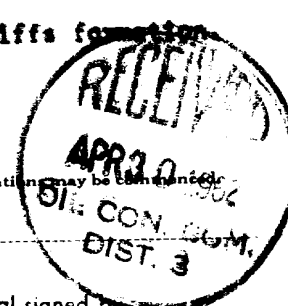

NEW MEXICO OIL CONSERVATION COMMISSION

Well Location and Acreage Dedication Plat

Section A.

Date April 26, 1962

Operator SOUTHWEST PRODUCTION COMPANY Lease Hancock Federal SF-078089
 Well No. 6 Unit Letter F Section 25 Township 27 NORTH Range 11 WEST, NMPM
 Located 1680 Feet From the NORTH Line, 1565 Feet From the WEST Line
 County SAN JUAN G. L. Elevation 6305.0 Dedicated Acreage 4/320 Acres
 Name of Producing Formation Dakota Pool Basin Dakota

1. Is the Operator the only owner in the dedicated acreage outlined on the plat below?
 Yes X No _____
2. If the answer to question one is "no", have the interests of all the owners been consolidated by communitization agreement or otherwise? Yes _____ No _____. If answer is "yes", Type of Consolidation.
3. If the answer to question two is "no", list all the owners and their respective interests below:

OwnerLand Description

Section B.

This is to certify that the information in Section A above is true and complete to the best of my knowledge and belief.

Southwest Production Company

Original signed by Carl W. Smith (Operator)

207 Petr. Club Plaza (Representative)

Farlington, N. M. (Address)

Ref: GLO plat dated 19 July 1915

Note: All distances must be from outer boundaries of section.

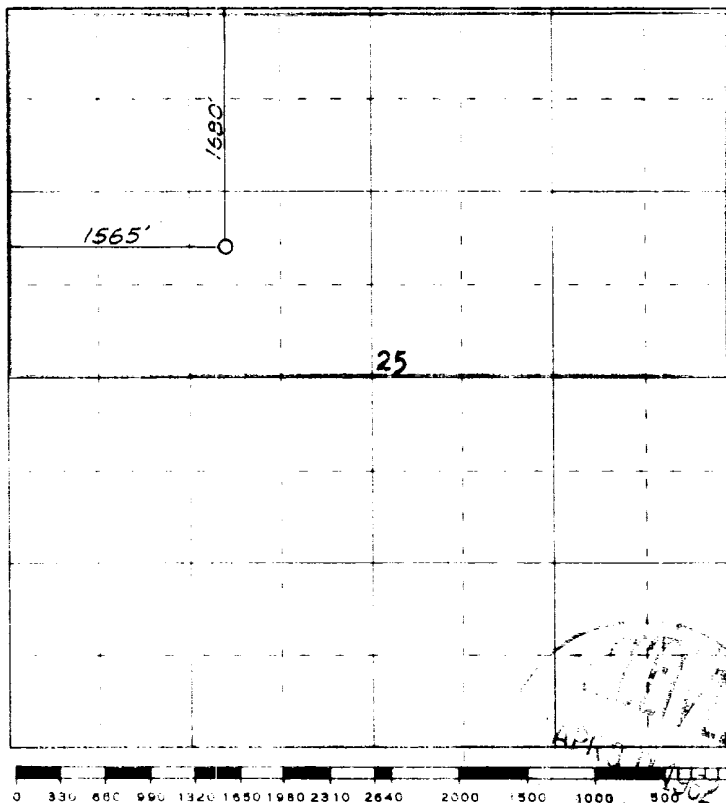

Scale 4 inches equal 1 mile

This is to certify that the above plat was prepared from field notes of actual surveys made by me or under my supervision and that the same are true and correct to the best of my knowledge and belief.

(Seal)

Farmington, New Mexico

Date Surveyed 11 April 1962

James P. Leese
 Registered Professional Engineer and/or Land Surveyor
 N. Mex. Reg. No. 1463