

(SUBMIT IN TRIPPLICATE)

UNITED STATES
DEPARTMENT OF THE INTERIOR
GEOLOGICAL SURVEY

Land Office Santa Fe
Lease No. 078356-B
Unit NE/4
30-045-06270

SUNDRY NOTICES AND REPORTS ON WELLS

NOTICE OF INTENTION TO DRILL.....	<input checked="" type="checkbox"/>	SUBSEQUENT REPORT OF WATER SHUT-OFF.....
NOTICE OF INTENTION TO CHANGE PLANS.....	<input type="checkbox"/>	SUBSEQUENT REPORT OF SHOOTING OR ACIDIZING.....
NOTICE OF INTENTION TO TEST WATER SHUT-OFF.....	<input type="checkbox"/>	SUBSEQUENT REPORT OF ALTERING CASING.....
NOTICE OF INTENTION TO RE-DRILL OR REPAIR WELL.....	<input type="checkbox"/>	SUBSEQUENT REPORT OF RE-DRILLING OR REPAIR.....
NOTICE OF INTENTION TO SHOOT OR ACIDIZE.....	<input type="checkbox"/>	SUBSEQUENT REPORT OF ABANDONMENT.....
NOTICE OF INTENTION TO PULL OR ALTER CASING.....	<input type="checkbox"/>	SUPPLEMENTARY WELL HISTORY.....
NOTICE OF INTENTION TO ABANDON WELL.....	<input type="checkbox"/>	

(INDICATE ABOVE BY CHECK MARK NATURE OF REPORT, NOTICE, OR OTHER DATA)

April 16, 1956, 19.....

Huerfano Unit

Well No. 47-27 is located 1345 ft. from [N] line and 1575 ft. from [E] line of sec. 27

NE/4 Section 27
(1/4 Sec. and Sec. No.)

T. 27-N. R. 9-W
(Twp.) (Range)

N. M. P. M.
(Meridian)

So. Blanco P. C.
(Field)

San Juan County
(County or Subdivision)

New Mexico
(State or Territory)

The elevation of the derrick floor above sea level is 6,343 ft.

DETAILS OF WORK

(State names of and expected depths to objective sands; show sizes, weights, and lengths of proposed casings; indicate mudding jobs, cementing points, and all other important proposed work)

NE/4 Section 27 is dedicated to this well. Propose to spud with cable tools; then drill with rotary tools to the top of the Pictured Cliffs Formation - expected between 1,900 feet and 2,200 feet below the surface. Completion with cable tools - and sand oil fracturing or shooting with solidified nitro-glycerin as conditions warrant.

Casing program: 90 feet 8-5/8" O.D. new 8 rd. thd. 24# casing. Circulate cement to surface, using at least 70 sacks of cement.

5-1/2" C.D. 14# J-55 casing to be set on top of Pictured Cliffs Formation cemented with 100 sacks regular cement.

1" tubing to be set within 20 feet of total depth for production.

I understand that this plan of work must receive approval in writing by the Geological Survey before operations may be commenced.

Company J. Glenn Turner - Unit Operator

Address Box 728

Farmington, New Mexico.

C. Beeson Neal, Agent in Farmington
Title

NEW MEXICO
OIL CONSERVATION COMMISSION

Form C-128

Well Location and/or Gas Proration Plat

Operator J. GLENN TURNER Lease HUERFALTO UNIT Date April 16, 1956
Well No. 47-27 Section 27 Township 27 NORTH Range 9 WEST, NMPM
Located 1345 Feet From the NORTH Line, 1575 Feet From the EAST Line,
SAN JUAN County, New Mexico. G. L. Elevation 6334.7
Name of Producing Formation Pictured Cliffs Pool So. Blanco P.C. Dedicated Acreage 160

(Note: All distances must be from outer boundaries of Section)

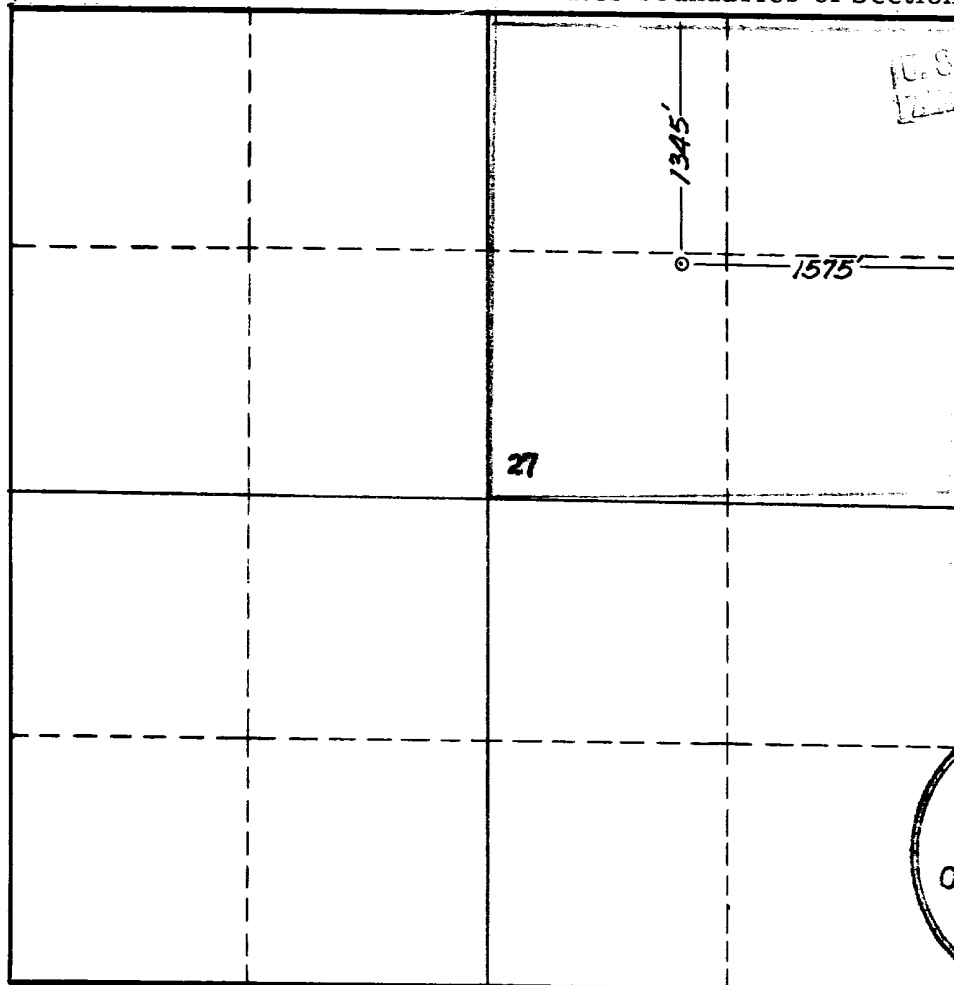

SCALE: 1"=1000'

1. Is this Well a Dual Comp. ? Yes No X .
2. If the answer to Question 1 is yes, are there any other dually completed wells within the dedicated acreage? Yes No .

Name [Signature]
Position C. Bee on Neal, Agent in Farmington
Representing J. Glenn Turner
Address Box 728 - Farmington, New Mexico

This is to certify that the above plat was prepared from field notes of actual surveys made by me or under my supervision and that the same are true and correct to the best of my knowledge and belief.

Date Surveyed FEBRUARY 22, 1956
[Signature]
Registered Professional Engineer and/or Land Surveyor JAMES P. LEESE
N. Mex. Reg. No. 1463