

(SUBMIT IN TRIPLICATE)

UNITED STATES
DEPARTMENT OF THE INTERIOR
GEOLOGICAL SURVEY

Land Office Santa Fe
Lease No. 079232
Unit Bolack

RECEIVED

SUNDRY NOTICES AND REPORTS ON WELLS FEB 4 1958

U. S. GEOLOGICAL SURVEY

| | | | |
|---|-------------------------------------|---|--|
| NOTICE OF INTENTION TO DRILL..... | <input checked="" type="checkbox"/> | SUBSEQUENT REPORT OF WATER SHUT-OFF..... | |
| NOTICE OF INTENTION TO CHANGE PLANS..... | | SUBSEQUENT REPORT OF SHOOTING OR ACIDIZING..... | |
| NOTICE OF INTENTION TO TEST WATER SHUT-OFF..... | | SUBSEQUENT REPORT OF ALTERING CASING..... | |
| NOTICE OF INTENTION TO RE-DRILL OR REPAIR WELL..... | | SUBSEQUENT REPORT OF RE-DRILLING OR REPAIR..... | |
| NOTICE OF INTENTION TO SHOOT OR ACIDIZE..... | | SUBSEQUENT REPORT OF ABANDONMENT..... | |
| NOTICE OF INTENTION TO PULL OR ALTER CASING..... | | SUPPLEMENTARY WELL HISTORY..... | |
| NOTICE OF INTENTION TO ABANDON WELL..... | | | |

(INDICATE ABOVE BY CHECK MARK NATURE OF REPORT, NOTICE, OR OTHER DATA)

February 4, 1958

Well No. 12-C(PM) is located 820 ft. from (N) line and 990 ft. from (E) line of sec. 29

NE Sec. 29 (1/4 Sec. and Sec. No.) 27N (Twp.) 8W (Range) E. N. P. M. (Meridian)
Blanco MV Ext. San Juan (County or Subdivision) New Mexico (State or Territory)
South Blanco P.C.

The elevation of the derrick floor above sea level is 6241 ft.

DETAILS OF WORK

(State names of and expected depths to objective sands; show sizes, weights, and lengths of proposed casings; indicate mudding jobs, cementing points, and all other important proposed work)

It is intended to drill & dual complete a well in the Pictured Cliffs formation & Mesa Verde formation. Mud circulation will be used thru the Pictured Cliffs formation & set intermediate casing. Gas circulation will be used thru the Mesa Verde & a production liner will be set. Possible productive intervals will be perforated & fractured. Estimated Total Depth 4753'.

Casing Program:

10 3/4" at 170' with 150 sacks cement circulated to the surface.

7 5/8" at 4368' with 250 sacks cement.

5 1/2" liner at 4753' with 110 sacks cement.

The E/2 of Section 29 is dedicated to the Mesa Verde

The NE/4 of Section 29 is dedicated to the Pictured Cliffs.

E/2: SP 079232

I understand that this plan of work must receive approval in writing by the Geological Survey before operations may be commenced.

Company El Paso Natural Gas Company

Address Box 997

Farmington, New Mexico

By Original Signed D. C. Johnson

Title Petroleum Engineer

NEW MEXICO OIL CONSERVATION COMMISSION

Well Location and Average Depth Data

Section A.

Date **JANUARY 31, 1958**

Operator **EL PASO NATURAL GAS COMPANY** Lease **BOLACK** SF **079232**
 Well No. **12-C (PM)** Unit Letter **A** Section **29** Township **27 N** Range **8 W** NMPM
 Location **820** Foot From **NORTH** Line **990** Foot From **EAST** Line
 County **SAN JUAN** G. L. Elevation **6231** Drilled Average **320 & 160** Acres
 Name of Producing Formation **MESA VERDE & PICTURED CLIFF** Base **BLANCO EXT. MV-SO. BLANCO PC.**

1. Is the Operator the only owner in the indicated acreage at the time this was made?

Yes ☒ No

2. If the answer to question one is "No", have the interests of all the owners been consolidated by formalization of agreement or otherwise? Yes No If answer is "No", Type of Consolidation

3. If the answer to question two is "No", list all the owners and their interests below with a brief description of the interest.

Owner



RECEIVED
FEB 4 1958
 U. S. GEOLOGICAL SURVEY
 FARMINGTON, NEW MEXICO

Section B.

I hereby certify that the information
 on Section A above is true and complete
 to the best of my knowledge and belief.

El Paso Natural Gas CompanyOperator
Original Signed **D. C. Johnston**

Representative

Box 997

Address

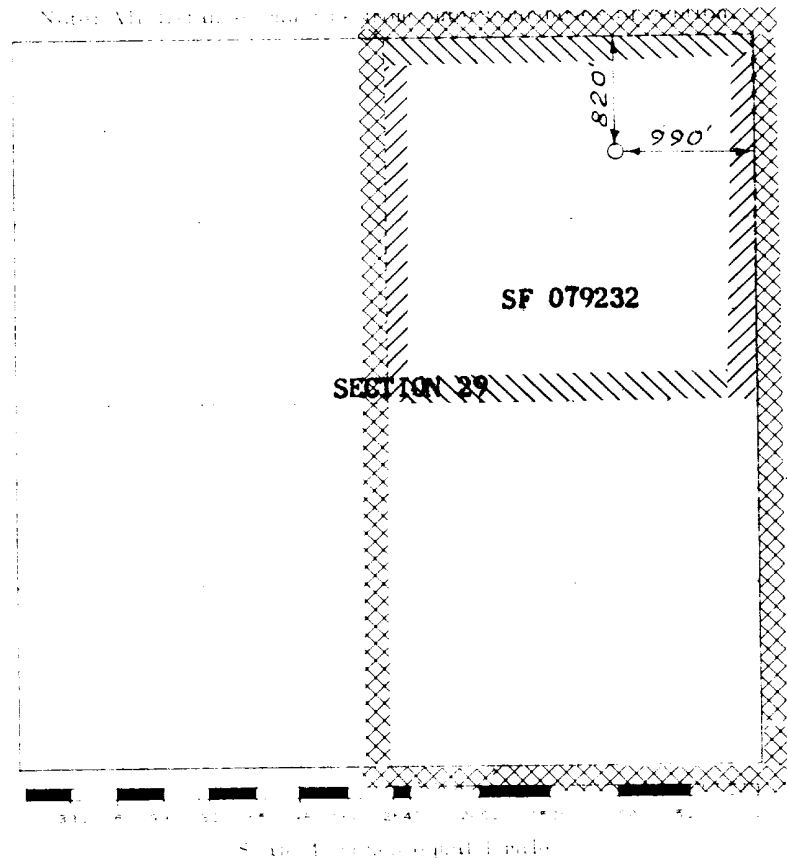
Farmington, New Mexico

Scale in feet, rounded to the nearest foot

This map was prepared from a survey made by the U.S. Geological Survey and is not to be used for any other purpose without the consent of the U.S. Geological Survey.

Page

Date Surveyed

NOVEMBER 25, 1957

David B. Wilson
 District Engineer, U.S. Geological Survey

Farmington, New Mexico