

UNITED STATES  
DEPARTMENT OF THE INTERIOR  
BUREAU OF LAND MANAGEMENT

APPLICATION FOR PERMIT TO DRILL, DEEPEN, OR PLUG BACK

**RECEIVED**

JUN 27 1990

**OIL CON. DIV**  
**DIST. 3**

- 1a. TYPE OF WORK  
PLUG BACK
- 1b. TYPE OF WELL  
GAS
2. OPERATOR  
~~EL PASO NATURAL GAS CO.~~ *Winters Oil Co.*
3. ADDRESS & PHONE NO. OF OPERATOR  
P.O. BOX 4289  
FARMINGTON, NM 87499  
(505) 326-9700
4. LOCATION OF WELL  
990' FNL; 1650' FEL
14. DISTANCE IN MILES FROM NEAREST TOWN
5. LEASE NUMBER  
USA-SF-078356 A
6. IF INDIAN, ALL. OR TRIBE NAME
7. UNIT AGREEMENT NAME  
HUERFANITO UNIT
8. FARM OR LEASE NAME
9. WELL NO.  
94
10. FIELD, POOL, OR WILDCAT  
BASIN FRUITLAND COAL
11. SEC. T. R. M OR BLK.  
*B* SEC. 26, T27N, R09W
12. COUNTY  
SAN JUAN
13. STATE  
NM
15. DISTANCE FROM PROPOSED LOCATION TO NEAREST PROPERTY OR LEASE LINE.
16. ACRES IN LEASE
17. ACRES ASSIGNED TO WELL  
320.00
18. DISTANCE FROM PROPOSED LOCATION TO NEAREST WELL DR. COMPL., OR APPLIED FOR ON THIS LEASE.
19. PROPOSED DEPTH
20. ROTARY OR CABLE TOOLS
21. ELEVATIONS (DF, FT, GR, ETC.)  
6183' GL
22. APPROX. DATE WORK WILL START

23. PROPOSED CASING AND CEMENTING PROGRAM

\*SEE OPERATIONS PLAN

24. AUTHORIZED BY: *William B. Adams* (ROS)  
REGULATORY AFFAIRS

*5-24-90*  
DATE

PERMIT NO. \_\_\_\_\_ APPROVAL DATE \_\_\_\_\_

APPROVED BY \_\_\_\_\_ TITLE \_\_\_\_\_ DATE \_\_\_\_\_

NOTE: THIS FORMAT IS ISSUED IN LIEU OF US BLM FORM 3160-3.  
(NO ADDITIONAL DIRT WORK WILL BE REQUIRED)

**APPROVED**

NMOCD

JUN 22 1990  
*Mark D. Holmes*  
for AREA MANAGER

Submit to Appropriate  
District Office  
State Lease - 4 copies  
Fee Lease - 3 copies

State of New Mexico  
Energy, Minerals and Natural Resources Department

Form C-102  
Revised 1-1-89

OIL CONSERVATION DIVISION  
P.O. Box 2088  
Santa Fe, New Mexico 87504-2088

DISTRICT I  
P.O. Box 1980, Hobbs, NM 88240

DISTRICT II  
P.O. Drawer DD, Artesia, NM 88210

DISTRICT III  
1000 Rio Brazos Rd., Aztec, NM 87410

WELL LOCATION AND ACREAGE DEDICATION PLAT

All Distances must be from the outer boundaries of the section

Operator <u>El Paso Natural Gas</u>		Lease <u>(SF-078356A)</u>	Well No. <u>21</u>
Unit Letter <u>B</u>	Section <u>25</u>	Township <u>27 North</u>	Range <u>8 West</u>
Actual Footage Location of Well: <u>990</u> feet from the <u>North</u> line and <u>1650</u> feet from the <u>East</u> line		County <u>San Juan</u>	NMPM
Ground level Elev. <u>6183'</u>	Producing Formation <u>Fruitland Coal</u>	Pool <u>Basin</u>	Dedicated Acreage: <u>320</u> Acres

- Outline the acreage dedicated to the subject well by colored pencil or hectare marks on the plat below.
- If more than one lease is dedicated to the well, outline each and identify the ownership thereof (both as to working interest and royalty).
- If more than one lease of different ownership is dedicated to the well, have the interest of all owners been consolidated by communitization, unitization, force-pooling, etc.?  
 Yes  No If answer is "yes" type of consolidation unitization

If answer is "no" list the owners and tract descriptions which have actually been consolidated. (Use reverse side of this form if necessary.)

No allowable will be assigned to the well until all interests have been consolidated (by communitization, unitization, force-pooling, or otherwise) or until a non-standard unit, eliminating such interest, has been approved by the Division.

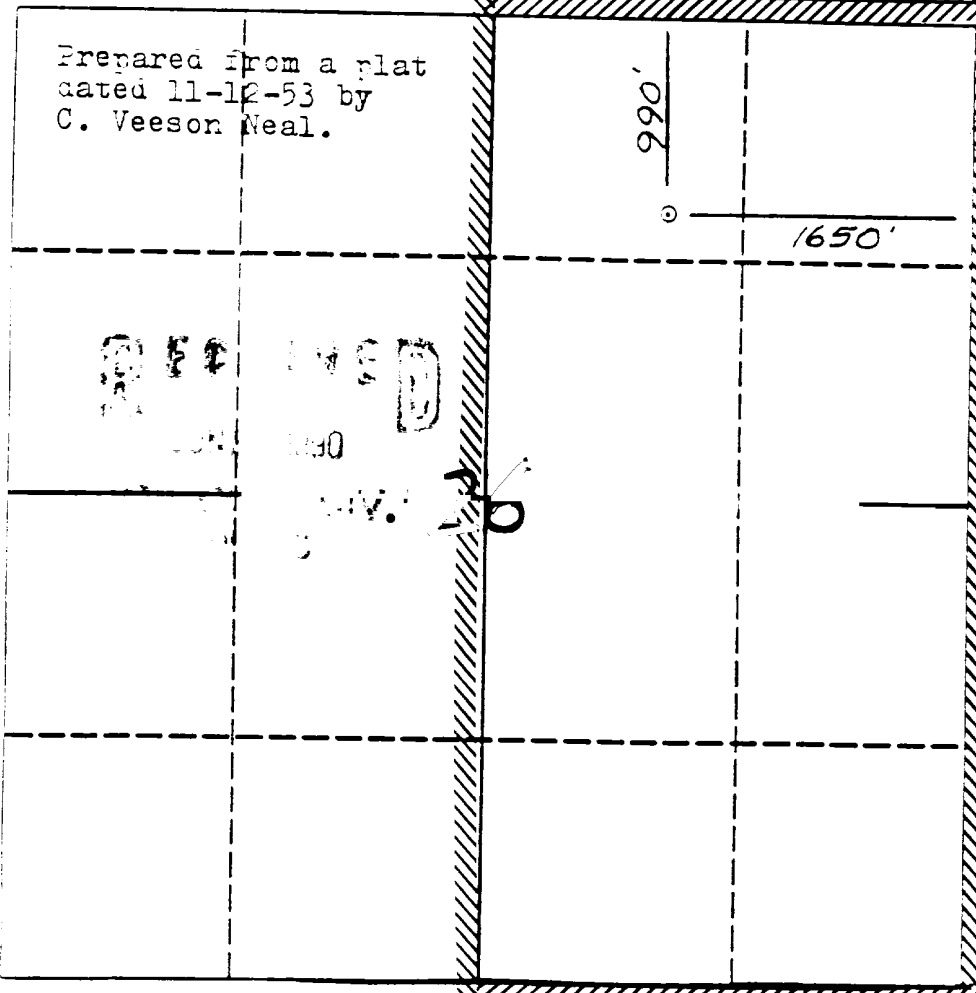

**OPERATOR CERTIFICATION**  
I hereby certify that the information contained herein is true and complete to the best of my knowledge and belief.  
Peggy Bradfield  
Signature  
Peggy Bradfield  
Printed Name  
Regulatory Affairs  
Position  
El Paso Natural Gas  
Company  
5-24-90  
Date

**SURVEYOR CERTIFICATION**  
I hereby certify that the well location shown on this plat was plotted from field notes of actual surveys made by me or under my supervision, and that the same is true and correct to the best of my knowledge and belief.  
5-23-90  
Date Surveyed  
Neale C. Edwards  
Signature  
Professional Surveyor  
NEW MEXICO  
6857  
REGISTERED LAND SURVEYOR  
Certificate No.  
Neale C. Edwards

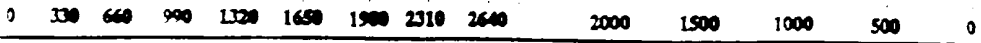

Recompletion Procedure  
Huerfanito Unit #94

1. Prepare location for workover. Install / replace anchors as necessary.
2. MOB with workover rig, hold safety meeting, install safety signs and proper fire equipment at strategic points. Comply with all BLM, NMOCD, and MOI regulations.
3. Rig up blow lines, record tubing and casing pressures and blow well down. Kill well as necessary with water. ND tree and NU 6" 3000 psi BOP and stripping head.
4. TOOH and lay down '03 joints of 1" tubing set @ 2184'.
5. BE 2 3/8" 4.7# J-55 EUE tubing and TIH with 7" casing scraper. CO to the base of the 7" casing @ 2096'. TOOH.
6. RU wireline unit and set a 7" bridge plug @ 2092'. Pressure test casing to 1000 psi for 15 minutes. If casing fails, isolate casing leak(s) with a test packer. A squeeze procedure will be provided if the casing is determined to be repairable.
7. Run a GR-CNL-CCL log and perforate the coal.
8. Breakdown the coal and evaluate. Fracture stimulate the coal if necessary.
9. Land 2 3/8" tubing with a common pump seating nipple one joint off bottom. Land tubing near bottom perforation. Record final 30, 45 and 60 minute gauges on morning report. Rig down and release rig.

# Huerfanito Unit #94

## NE/4 Section 26, T-27-N, R-9-W

### San Juan County, New Mexico

## Wellbore Schematics

CURRENT

PROPOSED

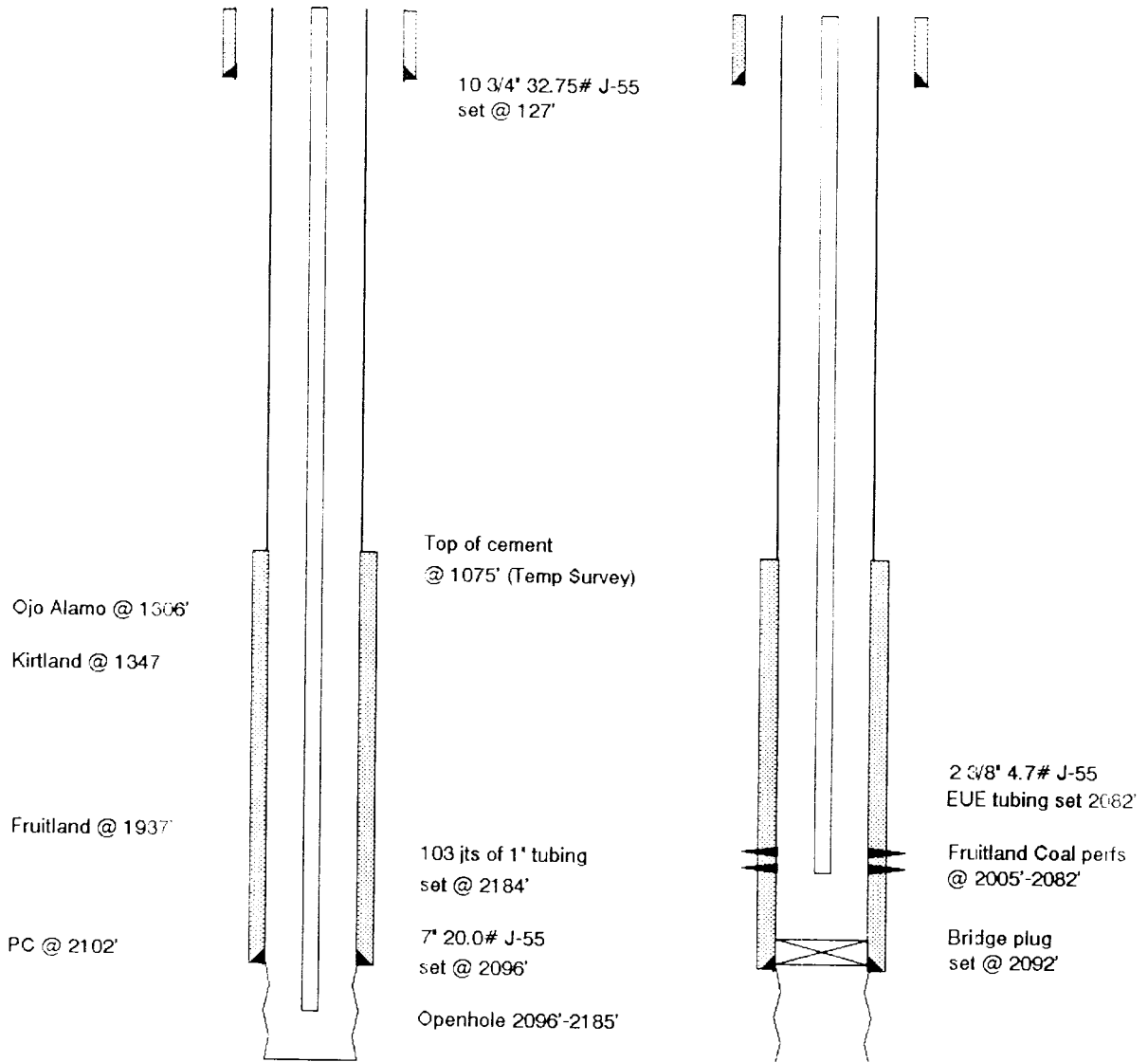

# WORKOVER / RECOMPLETION B.O.P. SCHEMATIC

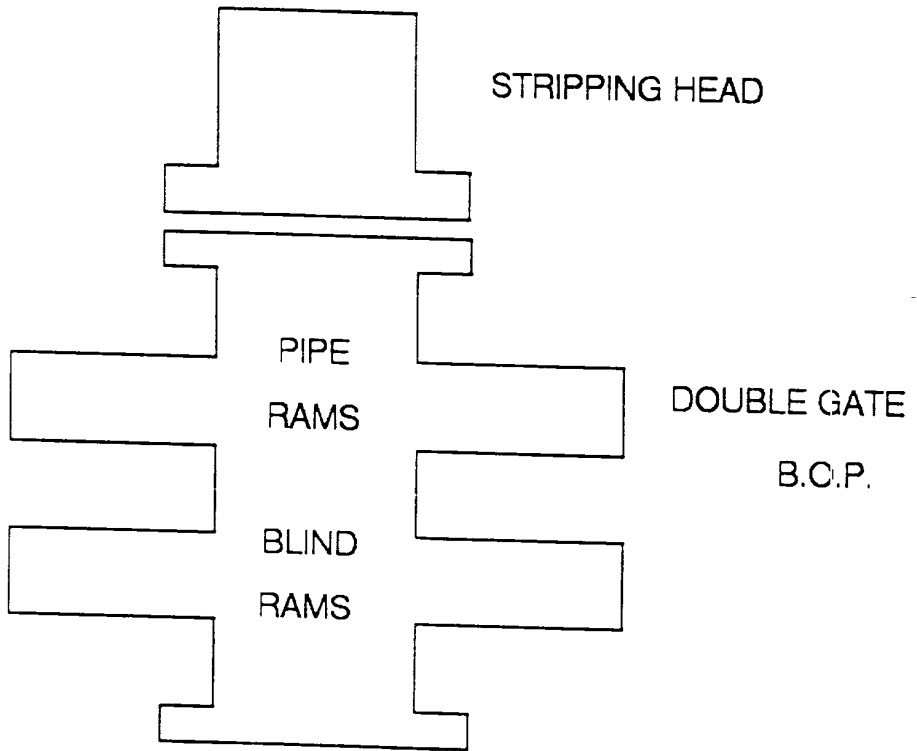

MINIMUM: 6" 2000 PSI DOUBLE GATE B.O.P.  
MAXIMUM ANTICIPATED SHUT-IN WELLHEAD  
PRESSURE IS LESS THAN 2000 PSI