

CMD :
OG6C102

ONGARD
C102-WELL LOCATION, DEDICATED ACREAGE PLAT

12/12/94 09:34:19
OGOAD -EMFM

API Well No : 30 45 6283 Well No : Eff Date : 12-12-1994
Pool Idn :

Prop Idn : 738

OGRID Idn :
GL Elevation :

U/L Sec Township Range North/South East/West Prop/Act(P/A)

B.H. Locn : FTG F FTG F

OCD U/L :

Lot Identifier: API County :

If more than 1 lease of different ownership is dedicated to the
well, have the interest of all owners been consolidated? (Y/N) :
Type of consolidation (Comm, Unit, Forced Pooling - C/U/F/O) :

E6101:Api well no. does not exist

PF01 HELP PF02 PF03 EXIT PF04 GoTo PF05 PF06 CONFIRM
PF07 PF08 PF09 PRINT PF10 NEXT-WC PF11 HISTORY PF12 ACRE

at 1335'. WOB all, RPM 80, psi 750, MW 9.5 Vis 62 PV/YP 18/12 Gels 8/30 WL 8.0 pH 9.5 FC/32 2 solids 6 % sand 1. Drill 12-1/2 hrs, cond & circ 2-1/2 hrs, trip 4-3/4 hrs, lub rig 1/4 hr, rep rig 3-1/2 hrs, WL logs 1/2 hr. DMC: \$700 CMC: \$2,300 DC: \$8,439 TAC: 12/19/90- Depth 1370' Loggers TD 1370' Ran DIGL/SDL/DSN/GR & coal logs. TIH circ. & cond. ran survey @ 1340' & 700' laying dn dp RU ran 34 jts. 4 1/2" 10.5# J-55 8R ST&C csg & landed @ 1365' KB. RU western & cement w/270 sks lead 50/50 poz. 2% gel, 10 % salt & 1/4# sk cello seal and tail w/30 sk class "B" w/1.2% CF18 low fkuid loss. Obtained full returns w/15 bbl cement circ. to surface. Release press. & float held. Plug dn @ 9:15pm on 12/18/90. ND BOPE jet pits. Release rig @ 1:15am on 12/19/90. WOCT. \$50,009

09/22/92- Well in city limits, alerted all city agencies. Lay dn plastic and MIRU JC Well Serv. ND well head and NU BOPE. PU bit and scraper on 2 3/8" tbg and tally in hole. Found PBTD at 1282' KB. Circ hole clean w/2% KCL. POOH w/bit and scraper. RU Quadco and press test csg and BOPE to 2200 psi, held ok. MI set fill and filter frac tanks. SDFN. Day 1 DC: \$5,750 TACC: \$5,750 TAC: \$94,165

09/23/92- RU Perforators and ran a GR/CCL log for correlation. Perf the fruitland Coal from 1152' to 1182' w/ a 3 1/8" csg gun loaded 4 JSPF, 90 ° phasing shooting a .38 hole w/ a 12 gram charge. All shots fired, no pressure to surface. RD Electric Line. Waiting on frac crew. SDFN. Day 2 DC: \$4,900 TACC: \$10,650 TAC: \$84,278 * Corrected

09/24/92- RU Dowell and frac stimulate the Fruitland Coal dn 4 1/2" csg w/911 bbl 30# crosslink gel containing 97,481# of 20/40 Brady sand at 25 BPM. Max press 1117 psi avg 975 pis. Max sand conc 6 ppg. ISIP 782 psi, 15 min 608 psi. Load to recover is 805 bbl. Left well shut-in 2 hrs for gel break. Open well to tank on a 3/8" choke. Well flowed back 05 bbls in one hr and died. TBLR 05 BLTR 800 Day 3 DC: \$24,400 TACC: \$35,050 TAC: \$106,678

09/25/92- Well dead. PU tbg and tally in hole. Tag sand @ 1175' KB, circ hole cl to PBTD w/2% KCL wtr. Pull up & land tbg w/38 jts 2 3/8" 4.7# J-55 8R EUE at 1199' KB. ND BOPE NU well head. RU to swab. Swab back 45 bbl load, well trying to kick off w/250 psi on csg. Shut well in, SDFN. TBLR 50 BLTR 755 Day 4 DC: \$7,700 TACC: \$42,750 TAC: \$116,378

09/26/92- Well dead. Tbg 0 psi csg 230 psi. Ran swab and kicked well off flowing. RD unit and move out. Left well flowing on a 1/2" choke. TBLR 60 BLTR 745 Day 5 DC: \$1,050 TACC: \$43,800 TAC: \$117,428

09/27/92- 20 hours flowing through a 1/2" choke. FTP 40 psi csg 135 psi. Recovered 140 bbl load w/ an estimated gas rate of 175 MCF/D. TBLR 200 BLTR 605 Day 6 DC: \$550 TACC: \$44,350 TAC: \$117,978

09/28/92- 24 hours flowing through a 1/2" choke. FTP 40 psi csg 160 psi. Recovered 220 bbl load w/ an estimated gas rate of 175 MCF/D. TBLR 420 BLTR 385 Day 7 DC: \$1,050 TACC: \$45,450 TAC: \$119,028

09/29/92- 24 hours flowing through a 1/2" choke. FTP 55 psi csg 150 psi. Recovered 250 bbl load w/ an estimated gas rate of 175 MCF/D. TBLR 670 BLTR 135 Day 8 DC: \$1,050 TACC: \$46,450 TAC: \$120,078

09/30/92- 24 hours flowing through a 1/2" choke. FTP 70 psi csg 145 psi. Recovered 121 bbl load w/ an estimated gas rate of 250 MCF/D.

NEW MEXICO
OIL CONSERVATION COMMISSION

Gas Well Plat

San a Fe
078357-A
G. H. Gentle

Date November 12, 1953
1

J. Glenn Turner

Operator

Lease

Well No.

Name of Producing Formation Pictured Cliffs Pool Fulcher Ruth

No. Acres Dedicated to the Well 160

Indicate land status and show ownership Federal

SECTION 26 TOWNSHIP 27 N RANGE 9 E

		X	

I hereby certify that the information given above is true and complete to the best of my knowledge.

Name [Signature]
Position C. Jackson Neal, Agent in Farmington
Representing J. Glenn Turner
Address Box 72R - Farmington, New Mexico.

(over)

OIL CONSERVATION COMMISSION

AZTEC DISTRICT OFFICE

No. Copies Received 3

DISTRIBUTION

Director	1
Asst. Dir.	
Asst. Dir. - Adm.	
Asst. Dir. - Eng.	
Asst. Dir. - Geol.	
Asst. Dir. - Insp.	
Asst. Dir. - Legal	
Asst. Dir. - Plan.	
Asst. Dir. - Rec.	
Asst. Dir. - Tech.	
Asst. Dir. - Training	
Asst. Dir. - Public Affs.	
Asst. Dir. - Safety	
Asst. Dir. - Security	
Asst. Dir. - Soc. Serv.	
Asst. Dir. - Special Inv.	
Asst. Dir. - Standards	
Asst. Dir. - Statistics	
Asst. Dir. - Technical Serv.	
Asst. Dir. - Transportation	
Asst. Dir. - Unemployment	
Asst. Dir. - Welfare	
Asst. Dir. - Youth	
Asst. Dir. - Other	
File	1

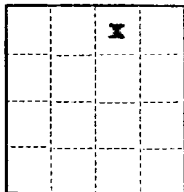

(SUBMIT IN TRIPPLICATE)

UNITED STATES
DEPARTMENT OF THE INTERIOR
GEOLOGICAL SURVEY

Land Office 078356-A

Lease No. _____

Unit 1/1 Sec. 26

SUNDRY NOTICES AND REPORTS ON WELLS

NOTICE OF INTENTION TO DRILL.....	SUBSEQUENT REPORT OF WATER SHUT-OFF.....
NOTICE OF INTENTION TO CHANGE PLANS.....	SUBSEQUENT REPORT OF SHOOTING OR ACIDIZING.....
NOTICE OF INTENTION TO TEST WATER SHUT-OFF.....	SUBSEQUENT REPORT OF ALTERING CASING.....
NOTICE OF INTENTION TO RE-DRILL OR REPAIR WELL.....	SUBSEQUENT REPORT OF RE-DRILLING OR REPAIR.....
NOTICE OF INTENTION TO SHOOT OR ACIDIZE.....	SUBSEQUENT REPORT OF ABANDONMENT.....
NOTICE OF INTENTION TO PULL OR ALTER CASING.....	SUPPLEMENTARY WELL HISTORY.....
NOTICE OF INTENTION TO ABANDON WELL.....	

INDICATE ABOVE BY CHECK MARK NATURE OF REPORT, NOTICE, OR OTHER DATA)

Well No. 1 is located 990 ft. from N line and 1,600 ft. from E line of sec. 26
NE 1/4 Sec. 26
Blucher-Butz (Field) T 27 N (Twp.) R 7 E (Range) N.M.P.M. (Meridian)
San Juan County (County or Subdivision) New Mexico (State or Territory)

The elevation of the derrick floor above sea level is 6123 ft.

DETAILS OF WORK

(State names of and expected depths to objective sands; show sizes, weights, and lengths of proposed casings; indicate mudding jobs, cementing points, and all other important proposed work)

Propose to drill with rotary tools to the top of the Clinton formation expected to be at 1,800 feet and 3,200 feet below surface; complete drilling with cable tool to bottom of Clinton formation; on show with solidified nitro glycerine

Casing program 2 1/2 feet of 2 1/2 inch casing through 2 1/2 inch casing, well casing not available, use 2 1/2 inch casing. Casing to surface. 17 1/2 inch casing to surface. Clinton formation, on show with solidified nitro glycerine

17 1/2 inch casing to surface. Clinton formation, on show with solidified nitro glycerine

I understand that this plan of work must receive approval in writing by the Geological Survey before operations may be commenced.

Company Blucher-Butz

Address Blucher-Butz, P.O. Box 100, Santa Fe, N.M.

By [Signature]

Title _____

Company.....J. Glenn Turner.....

Lease.....G. I. Gentile.....Well No. 1.....

Sec. 26....., T. 27 N....., R. 9 W., N.M.P.M.

Location.....920' from the North line and 165' from
the East line.

Elevation.....61.93 Ungraded ground.....

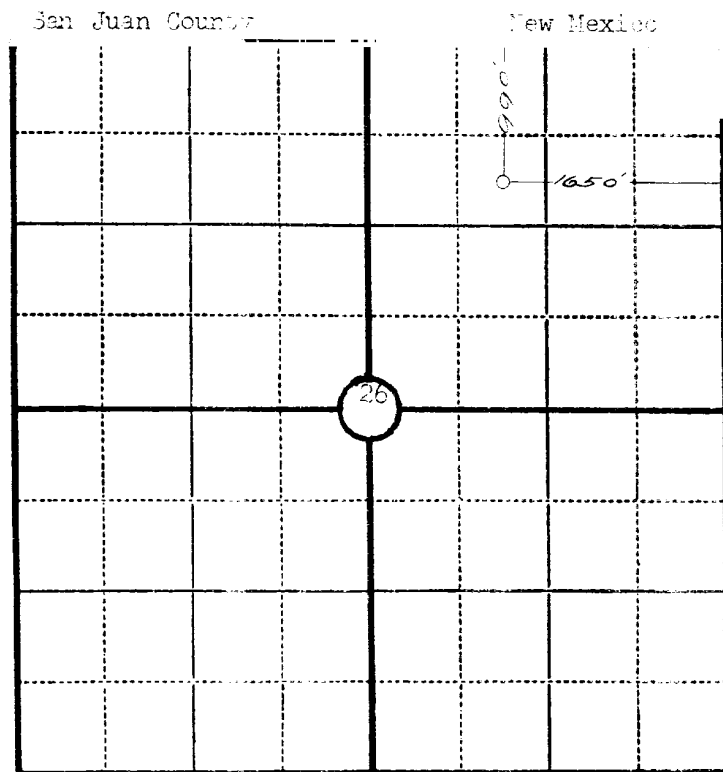

Scale—4 inches equal 1 mile.

This is to certify that the above plat was prepared from field notes of actual surveys made by me or under my supervision and that the same are true and correct to the best of my knowledge and belief.

Seal:

Registered Professional
Engineer and Land Surveyor.

James P. Leese
N. Mex. Reg. 1463

Surveyed June 30, 1953