

(SUBMIT IN TRIPLICATE)

Indian Agency **Navajo Tribal**

UNITED STATES  
DEPARTMENT OF THE INTERIOR  
GEOLOGICAL SURVEY

Allottee

Lease No. **Navajo Tribal Contract  
14-20-603-307**

|  |  |  |  |  |  |  |  |  |  |
|--|--|--|--|--|--|--|--|--|--|
|  |  |  |  |  |  |  |  |  |  |
|  |  |  |  |  |  |  |  |  |  |
|  |  |  |  |  |  |  |  |  |  |
|  |  |  |  |  |  |  |  |  |  |
|  |  |  |  |  |  |  |  |  |  |
|  |  |  |  |  |  |  |  |  |  |
|  |  |  |  |  |  |  |  |  |  |
|  |  |  |  |  |  |  |  |  |  |
|  |  |  |  |  |  |  |  |  |  |
|  |  |  |  |  |  |  |  |  |  |

SUNDRY NOTICES AND REPORTS ON WELLS

|   |                                     |  |   |
|---|-------------------------------------|--|---|
| NOTICE OF INTENTION TO DRILL                  | <input checked="" type="checkbox"/> | SUBSEQUENT REPORT OF WATER SHUT-OFF        | RECEIVED<br>APR 8 1963<br>U. S. GEOLOGICAL SURVEY<br>FARMINGTON, NEW MEXICO |
| NOTICE OF INTENTION TO CHANGE PLANS           |                                     | SUBSEQUENT REPORT OF SHOOTING OR ACIDIZING |   |
| NOTICE OF INTENTION TO TEST WATER SHUT-OFF    |                                     | SUBSEQUENT REPORT OF ALTERING CASING       |   |
| NOTICE OF INTENTION TO REDRILL OR REPAIR WELL |                                     | SUBSEQUENT REPORT OF REDRILLING OR REPAIR  |   |
| NOTICE OF INTENTION TO SHOOT OR ACIDIZE       |                                     | SUBSEQUENT REPORT OF ABANDONMENT           |   |
| NOTICE OF INTENTION TO PULL OR ALTER CASING   |                                     | SUPPLEMENTARY WELL HISTORY                 |   |
| NOTICE OF INTENTION TO ABANDON WELL           |                                     |  |   |

(INDICATE ABOVE BY CHECK MARK NATURE OF REPORT, NOTICE, OR OTHER DATA)

April 5, 1963

**Beautiful Mountain**

Well No. **1** is located **640** ft. from **[N]** line and **640** ft. from **[E]** line of sec. **29**

**NE/4 NE/4 Section 29**  
(1/4 Sec. and Sec. No.)

**27N**  
(Twp.)

**19W**  
(Range)

**N&PM**  
(Meridian)

**Wildcat**

(Field)

**San Juan**

(County or Subdivision)

**New Mexico**

(State or Territory)

The elevation of the derrick floor above sea level is **5744** ft.

DETAILS OF WORK

(State names of and expected depths to objective sands; show sizes, weights, and lengths of proposed casings; indicate mudding jobs, cementing points, and all other important proposed work)

It is intended to drill a well through the **Entrada Formation** using rotary tools and mud circulation. Possible productive intervals will be perforated and sand fractured--**1250'-1300'**.

Estimated Total Depth **1300'**.

Casing Program:

**8-5/8" at 25' with 25 sacks cement circulated to surface.**

**5-1/2" at 1300' with 100 sacks cement.**

The **NE/4 NE/4** of Section 29 is dedicated to this well.

**NE/4 NE/4 Section 29 Navajo Tribal Contract 14-20-603-307**



I understand that this plan of work must receive approval in writing by the Geological Survey before operations may be commenced.

Company **El Paso Natural Gas Products Company**

Address **Post Office Box 1540**

**Farmington, New Mexico**

By **Original Signed by Wayne W. Dallas**

Title **Drilling and Production Superintendent**

# NEW MEXICO OIL CONSERVATION COMMISSION

## Well Location and Acreage Dedication Plat

### SECTION A.

Date April 8, 1963

Operator El Paso Natural Gas Products Company

Lease San Juan

Well No. 1 Unit Letter A Section 29 Township 27 North Range 19 West NMPM

Located 660 Feet From North Line, 660 Feet From East Line

County San Juan G. L. Elevation 5738 Dedicated Acreage 40 Acres

Name of Producing Formation San Juan Pool San Juan

1. Is the Operator the only owner\* in the dedicated acreage outlined on the plat below? Yes X No       

2. If the answer to question One is "No," have the interests of all the owners been consolidated by communitization agreement or otherwise? Yes        No        If answer is "Yes," Type of Consolidation       

3. If the answer to question Two is "No," list all the owners and their respective interests below:

OWNER

LAND DESCRIPTION

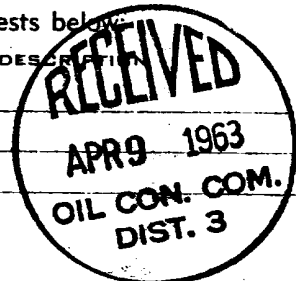

### SECTION B.

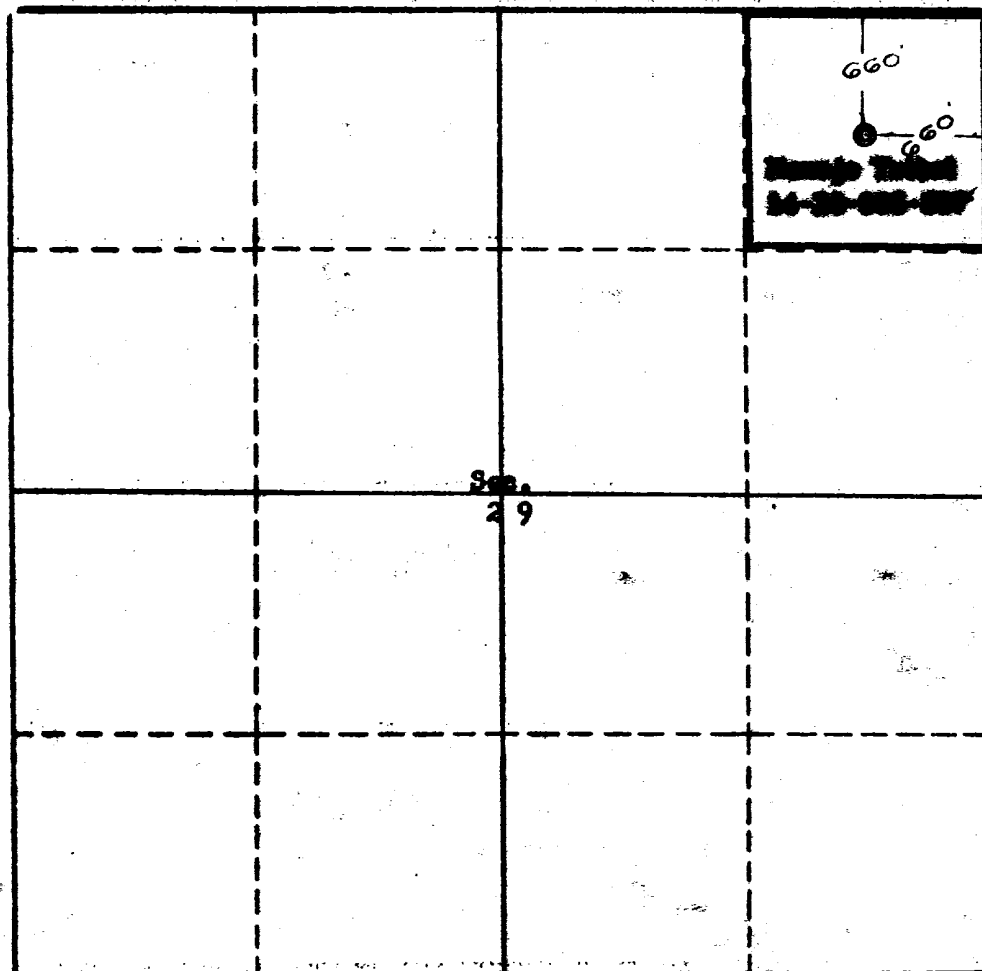

This is to certify that the information in Section A above is true and complete to the best of my knowledge and belief.

El Paso Natural Gas Products Co.

(OPERATOR)

Original Signed by Wayne W. Diller  
(REPRESENTATIVE)

P.O. Box 2042, Farmington, N. M.

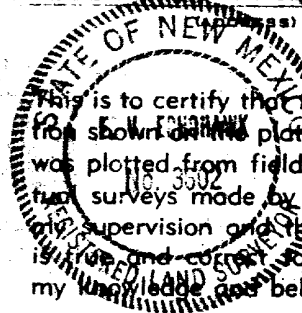

This is to certify that the well location shown on the plat in Section B was plotted from field notes of actual surveys made by me or under my supervision and that the same is true and correct to the best of my knowledge and belief.

Date Surveyed March 22, 1963

Four States Engineering Co.  
FARMINGTON, NEW MEXICO

Emil T. Czerwinski  
REGISTERED ENGINEER OR  
LAND SURVEYOR

Certificate No. 3602

