

5-USGS  
1-WD  
1-D  
1-F

(SUBMIT IN TRIPLICATE)

Budget Bureau No. 42-R368.4.  
Approval expires 12-31-60.

			X

UNITED STATES  
DEPARTMENT OF THE INTERIOR  
GEOLOGICAL SURVEY

Land Office \_\_\_\_\_  
Lease No. **NM-056564**  
Unit \_\_\_\_\_  
Campbell Federal "B"

SUNDRY NOTICES AND REPORTS ON WELLS

NOTICE OF INTENTION TO DRILL.....	<b>XX</b>	SUBSEQUENT REPORT OF WATER SHUT-OFF.....	
NOTICE OF INTENTION TO CHANGE PLANS.....		SUBSEQUENT REPORT OF SHOOTING OR ACIDIZING.....	
NOTICE OF INTENTION TO TEST WATER SHUT-OFF.....		SUBSEQUENT REPORT OF ALTERING CASING.....	
NOTICE OF INTENTION TO RE-DRILL OR REPAIR WELL.....		SUBSEQUENT REPORT OF RE-DRILLING OR REPAIR.....	
NOTICE OF INTENTION TO SHOOT OR ACIDIZE.....		SUBSEQUENT REPORT OF ABANDONMENT.....	
NOTICE OF INTENTION TO PULL OR ALTER CASING.....		SUPPLEMENTARY WELL HISTORY.....	
NOTICE OF INTENTION TO ABANDON WELL.....			

(INDICATE ABOVE BY CHECK MARK NATURE OF REPORT, NOTICE, OR OTHER DATA)

May 11, 1962

Well No. 1 is located 790 ft. from N line and 790 ft. from E line of sec. 28  
NE/4 NE/4 Sec. 28 27N 12W NMPM  
(1/4 Sec. and Sec. No.) (Twp.) (Range) (Meridian)  
Basin Dakota San Juan New Mexico  
(Field) (County or Subdivision) (State or Territory)

The elevation of the derrick floor above sea level is 5823.8 ft. G.L.

DETAILS OF WORK

(State names of and expected depths to objective sands; show sizes, weights, and lengths of proposed casings; indicate mudding jobs, cementing points, and all other important proposed work)

Propose to drill with rotary tools to an estimated depth of 6050' or to test the Dakota formation. Casing program will be as follows:

10 3/4" 32.75# surface casing set @ approx. 200' w/150 sx cement.

4 1/2" 10.50# set at total depth w/300 sx or cement to cover the Gail formation.

Will perforate and sand-water frac the Dakota formation.

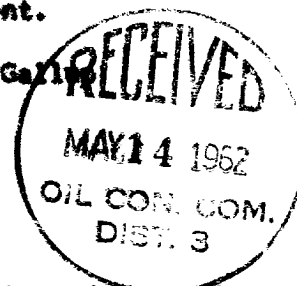

I understand that this plan of work must receive approval in writing by the Geological Survey before operations may be commenced.

Company Southwest Production Company

Address 207 Petr. Club Plaza

Farmington, N. M.

By Original signed by Carl W. Smith

Title Superintendent

*ok*

## NEW MEXICO OIL CONSERVATION COMMISSION

## Well Location and Acreage Dedication Plat

## Section A.

Date 5/11/62

Operator SOUTHWEST PRODUCTION COMPANY Lease Campbell Federal "B"  
 Well No. 1 Unit Letter A Section 28 Township 27 NORTH Range 12 WEST, NMPM  
 Located 790 Feet From the NORTH Line, 790 Feet From the EAST Line  
 County SAN JUAN G. L. Elevation 5823.8 Dedicated Acreage 1/320 Acres  
 Name of Producing Formation Dakota Pool Basin Dakota

1. Is the Operator the only owner in the dedicated acreage outlined on the plat below?  
 Yes ☒ No ☐
2. If the answer to question one is "no", have the interests of all the owners been consolidated by communitization agreement or otherwise? Yes ☐ No ☐ If answer is "yes", Type of Consolidation.
3. If the answer to question two is "no", list all the owners and their respective interests below:

Owner

Land Description

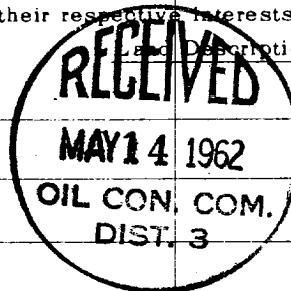

## Section B.

Note: All distances must be from outer boundaries of section.

This is to certify that the information in Section A above is true and complete to the best of my knowledge and belief.

**Southwest Production Company**

Original signed by (Operator)  
 Carl W. Smith

(Representative)

**207 Petr. Club Plaza**

(Address)

**Farmington, N. M.**

Ref: GLO plat dated 19 July 1915

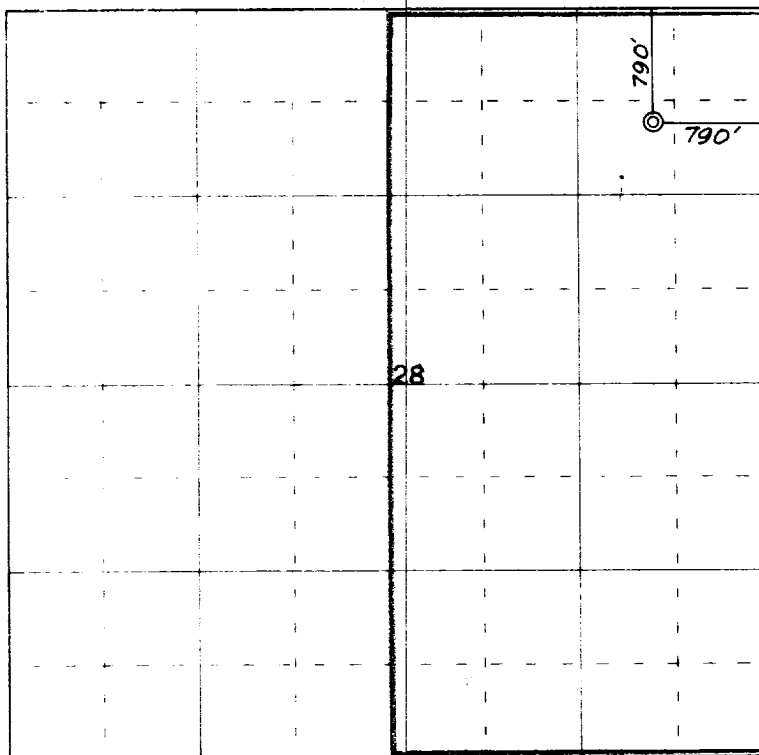

0 330 660 990 1320 1650 1980 2310 2640 2000 1500 1000 500 0

Scale 4 inches equal 1 mile



This is to certify that the above plat was prepared from field notes of actual surveys made by me or under my supervision and that the same are true and correct to the best of my knowledge and belief.

Date Surveyed 9 May 1962

*James P. Leese*  
 Registered Professional Engineer and/or Land Surveyor  
**James P. Leese** N. Mex. Reg. No. 1463  
 San Juan, New Mexico