

5-USGS

1-WD

1-D

1-F

(SUBMIT IN TRIPLICATE)

Budget Bureau No. 42-R358.4.  
Approval expires 12-31-60.

Land Office .....

Lease No. **SF-079114-A**

Unit .....

**Campbell Federal**

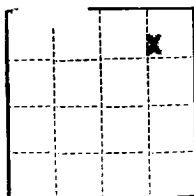

UNITED STATES  
DEPARTMENT OF THE INTERIOR  
GEOLOGICAL SURVEY

**SUNDRY NOTICES AND REPORTS ON WELLS**

NOTICE OF INTENTION TO DRILL.....	<input checked="" type="checkbox"/>	SUBSEQUENT REPORT OF WATER SHUT-OFF.....
NOTICE OF INTENTION TO CHANGE PLANS.....	<input type="checkbox"/>	SUBSEQUENT REPORT OF SHOOTING OR ACIDIZING.....
NOTICE OF INTENTION TO TEST WATER SHUT-OFF.....	<input type="checkbox"/>	SUBSEQUENT REPORT OF ALTERING CASING.....
NOTICE OF INTENTION TO RE-DRILL OR REPAIR WELL.....	<input type="checkbox"/>	SUBSEQUENT REPORT OF RE-DRILLING OR REPAIR.....
NOTICE OF INTENTION TO SHOOT OR ACIDIZE.....	<input type="checkbox"/>	SUBSEQUENT REPORT OF ABANDONMENT.....
NOTICE OF INTENTION TO PULL OR ALTER CASING.....	<input type="checkbox"/>	SUPPLEMENTARY WELL HISTORY.....
NOTICE OF INTENTION TO ABANDON WELL.....	<input type="checkbox"/>	

(INDICATE ABOVE BY CHECK MARK NATURE OF REPORT, NOTICE, OR OTHER DATA)

**8/2**, 19**61**

Well No. **#5** is located **790** ft. from **[N]** line and **790** ft. from **[E]** line of sec. **27**

**NE/4 NE/4 Sec. 27** (1/4 Sec. and Sec. No.) **77N** (Twp.) **12W** (Range) **106PM** (Meridian)

**Basin Dakota** (Name) **San Juan** (County or Subdivision) **New Mexico** (State or Territory)

The elevation of the derrick floor above sea level is **5864** ft. **GL**

**DETAILS OF WORK**

(State names of and expected depths to objective sands; show sizes, weights, and lengths of proposed casings; indicate mudding jobs, cementing points, and all other important proposed work)

Propose to drill with rotary tools to an approximate depth of 6100 feet or to test the Dakota formation. Casing program will be as follows:

10 3/4" 32.50# surface set @ approximately 200' with 160 sz cement.  
4 1/2" 10.30# set at total depth with 475 sz cement, or cement to cover the Gallup formation.

Will perforate and sand-water frac the Dakota formation.

I understand that this plan of work must receive approval in writing by the Geological Survey before operations may be commenced.

Company **Southwest Production Company**

Address **207 Petr. Club Plaza**

**Farmington, New Mexico**

Original signed by  
**Carl W. Smith**

Title **Production Superintendent**

NUMBER OF COPIES RECEIVED	
DISTRIBUTION	
SANTA FE	
FILE	
U.S.G.S	
LAND OFFICE	
TRANSPORTER	OIL
	GAS
PRORATION OFFICE	
OPERATOR	

**NEW MEXICO OIL CONSERVATION COMMISSION**  
**WELL LOCATION AND ACREAGE DEDICATION PLAT**  
 SEE INSTRUCTIONS FOR COMPLETING THIS FORM ON THE REVERSE SIDE

FORM C-128  
 Revised 5/1/57

**SECTION A**

Operator <b>SOUTHWEST PRODUCTION COMPANY</b>		Lease <b>CAMPBELL FEDERAL SF-079114-A</b>		Well No. <b>5</b>
Unit Letter <b>A</b>	Section <b>27</b>	Township <b>27 NORTH</b>	Range <b>12 WEST</b>	County <b>SAN JUAN</b>
Actual Footage Location of Well: <b>790</b> feet from the <b>NORTH</b> line and <b>790</b> feet from the <b>EAST</b> line				
Ground Level Elev. <b>5864.0</b>	Producing Formation <b>DAKOTA</b>	Pool <b>BASIN DAKOTA</b>	Dedicated Acreage: <b>1/320</b> Acres	

Ref: GLO plat dated 19 July 1915

- Is the Operator the only owner in the dedicated acreage outlined on the plat below? YES ☒ NO \_\_\_\_ . ("Owner" means the person who has the right to drill into and to produce from any pool and to appropriate the production either for himself or for himself and another. (65-3-29 (e) NMSA 1935 Comp.)
- If the answer to question one is "no," have the interests of all the owners been consolidated by common action agreement or otherwise? YES \_\_\_\_ NO \_\_\_\_ . If answer is "yes," Type of Consolidation \_\_\_\_
- If the answer to question two is "no," list all the owners and their respective interests below

Owner	Land Description

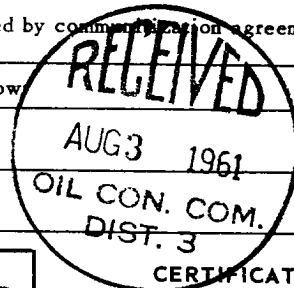

**SECTION B**

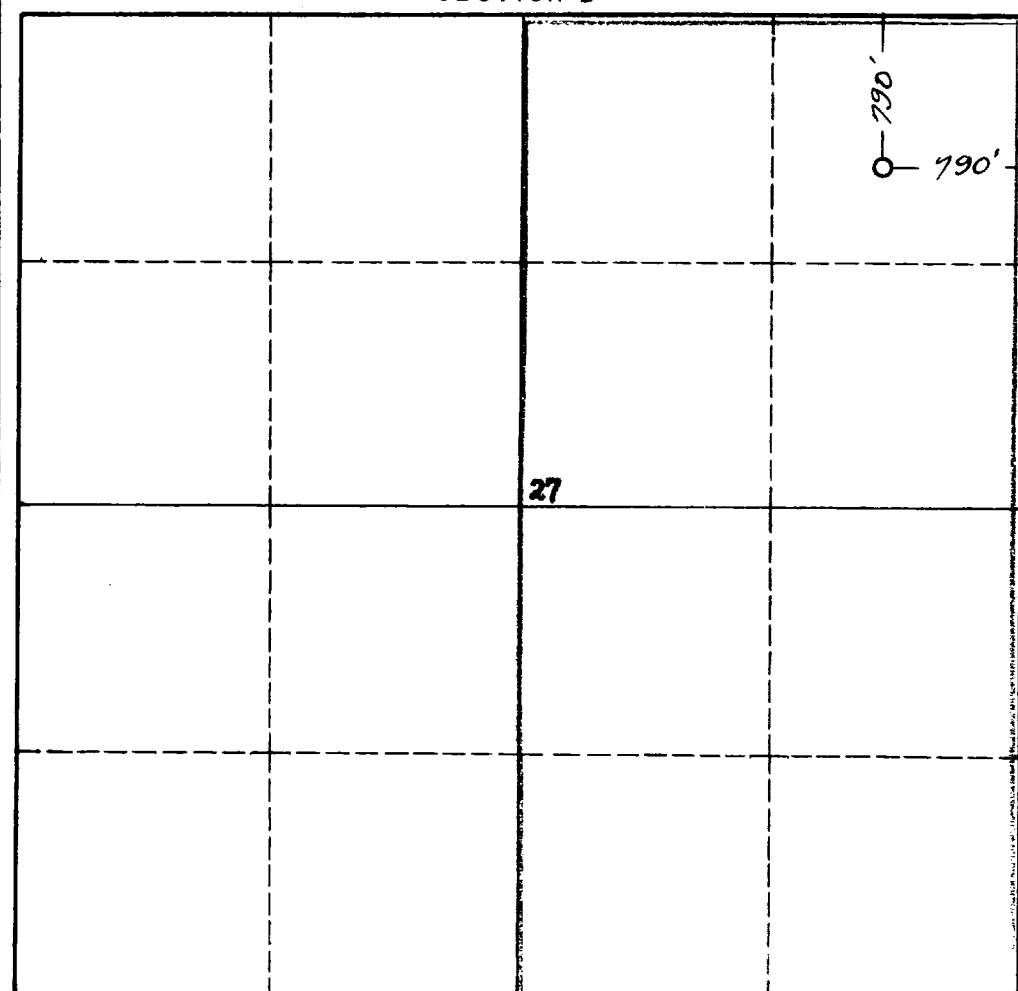

I hereby certify that the information in SECTION A above is true and complete to the best of my knowledge and belief.

Name	Original signed by <b>Carl W. Smith</b>
Position	<b>Production Superintendent</b>
Company	<b>Southwest Production Co.</b>
Date	<b>8/2/61</b>

I hereby certify that the well location shown on the plat in SECTION B was plotted from field notes of actual surveys made by me or under my supervision, and that the same is true and correct to the best of my knowledge and belief.

Date Surveyed	<b>1 August 1961</b>
Registered Professional Engineer and/or Land Surveyor	<b>James P. Leese</b>
Certificate No.	<b>1463</b>
<b>San Juan Engineering Company</b>	

0 330 660 990 1320 1650 1980 2310 2640 2000 1500 1000 500 0

## INSTRUCTIONS FOR COMPLETION OF FORM C-128

1. Operator shall furnish and certify to the information called for in Section A.
2. Operator shall outline the dedicated acreage for *both* oil and gas wells on the plat in Section B.
3. A registered professional engineer or land surveyor registered in the State of New Mexico or approved by the Commission shall show on the plat the location of the well and certify this information in the space provided.
4. All distances shown on the plat must be from the outer boundaries of the Section.
5. If additional space is needed for listing owners and their respective interests as required in question 3 of Section A, please use space below.