

Sec. 29

(SUBMIT IN TRIPLICATE)

UNITED STATES  
DEPARTMENT OF THE INTERIOR  
GEOLOGICAL SURVEY

Indian Agency \_\_\_\_\_  
Navajo

Allettee \_\_\_\_\_  
11-20-0603-6361  
Lease No. \_\_\_\_\_

SUNDRY NOTICES AND REPORTS ON WELLS

NOTICE OF INTENTION TO DRILL	<input checked="" type="checkbox"/>	SUBSEQUENT REPORT OF WATER SHUT-OFF	
NOTICE OF INTENTION TO CHANGE PLANS		SUBSEQUENT REPORT OF SHOOTING OR ACIDIZING	
NOTICE OF INTENTION TO TEST WATER SHUT-OFF		SUBSEQUENT REPORT OF ALTERING CASING	
NOTICE OF INTENTION TO REDRILL OR REPAIR WELL		SUBSEQUENT REPORT OF REDRILLING OR REPAIR	
NOTICE OF INTENTION TO SHOOT OR ACIDIZE		SUBSEQUENT REPORT OF ABANDONMENT	
NOTICE OF INTENTION TO PULL OR ALTER CASING		SUPPLEMENTARY WELL HISTORY	
NOTICE OF INTENTION TO ABANDON WELL			

(INDICATE ABOVE BY CHECK MARK NATURE OF REPORT, NOTICE, OR OTHER DATA)

U. S. GEOLOGICAL SURVEY  
FARMINGTON, NEW MEXICO

Cottonwood Navajo

May 16, 1962

Well No. 1 is located 810 ft. from [N] line and 660 ft. from [E] line of sec. 29

NE 1/4 Sec. 29 (1/4 Sec. and Sec. No.) T27N R15W NMFM (Twp.) (Range) (Meridian)  
Wildcat San Juan County New Mexico (Field) (County or Subdivision) (State or Territory)

The elevation of the derrick floor above sea level is 5577 ft.

DETAILS OF WORK

(State names of and expected depths to objective sands; show sizes, weights, and lengths of proposed casings; indicate mudlogging, cementing points, and all other important proposed work)

We propose to drill this well with rotary tools to an estimated depth of 11,000' to test the Gallup formation. Approximately 250' of 8 5/8" O.D. surface casing will be run and cemented to the surface. If commercial production is encountered a string of production casing will be run and cemented and the well completed.

I understand that this plan of work must receive approval in writing by the Geological Survey before operations may be commenced.

Company Continental Oil Company

Address P. O. Box 3312

Durango, Colorado

Original Signed By:  
H. D. HALEY

By \_\_\_\_\_

Title District Superintendent

NUMBER OF COPIES RECEIVED:	
DISTRIBUTION	
SANTA FE	
FILE	
U.S.G.S.	
LAND OFFICE	
TRANSPORTER	OIL GAS
PRODUCTION OFFICE	
OPERATOR	

**NEW MEXICO OIL CONSERVATION COMMISSION**  
**WELL LOCATION AND ACREAGE DEDICATION PLAT**  
 SEE INSTRUCTIONS FOR COMPLETING THIS FORM ON THE REVERSE SIDE

FORM C-128  
Revised 5/1/57

**SECTION A**

Operator <b>Continental Oil Company</b>		Lease <b>Cottonwood Navajo</b>		Well No. <b>1</b>
Unit Letter <b>A</b>	Section <b>29</b>	Township <b>27N</b>	Range <b>19W</b>	County <b>San Juan</b>
Actual Footage Location of Well: <b>810</b> feet from the <b>E</b> line and <b>660</b> feet from the <b>E</b> line				
Ground Level Elev. <b>5556'</b>	Producing Formation <b> Gallup</b>	Pool <b>Undesignated</b>	Dedicated Acreage: <b>46</b> Acres	

1. Is the Operator the only owner in the dedicated acreage outlined on the plat below? YES ☒ NO ☐ . ("Owner" means the person who has the right to drill into and to produce from any pool and to appropriate the production either for himself or for himself and another. (65-3-29 (e) NMSA 1935 Comp.)
2. If the answer to question one is "no," have the interests of all the owners been consolidated by communitization agreement or otherwise? YES ☐ NO ☐ . If answer is "yes," Type of Consolidation \_\_\_\_\_
3. If the answer to question two is "no," list all the owners and their respective interests below:

Owner	Land Description

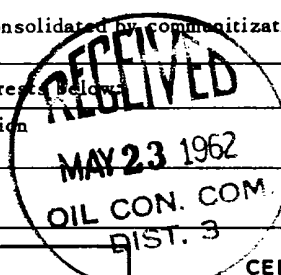

**SECTION B**

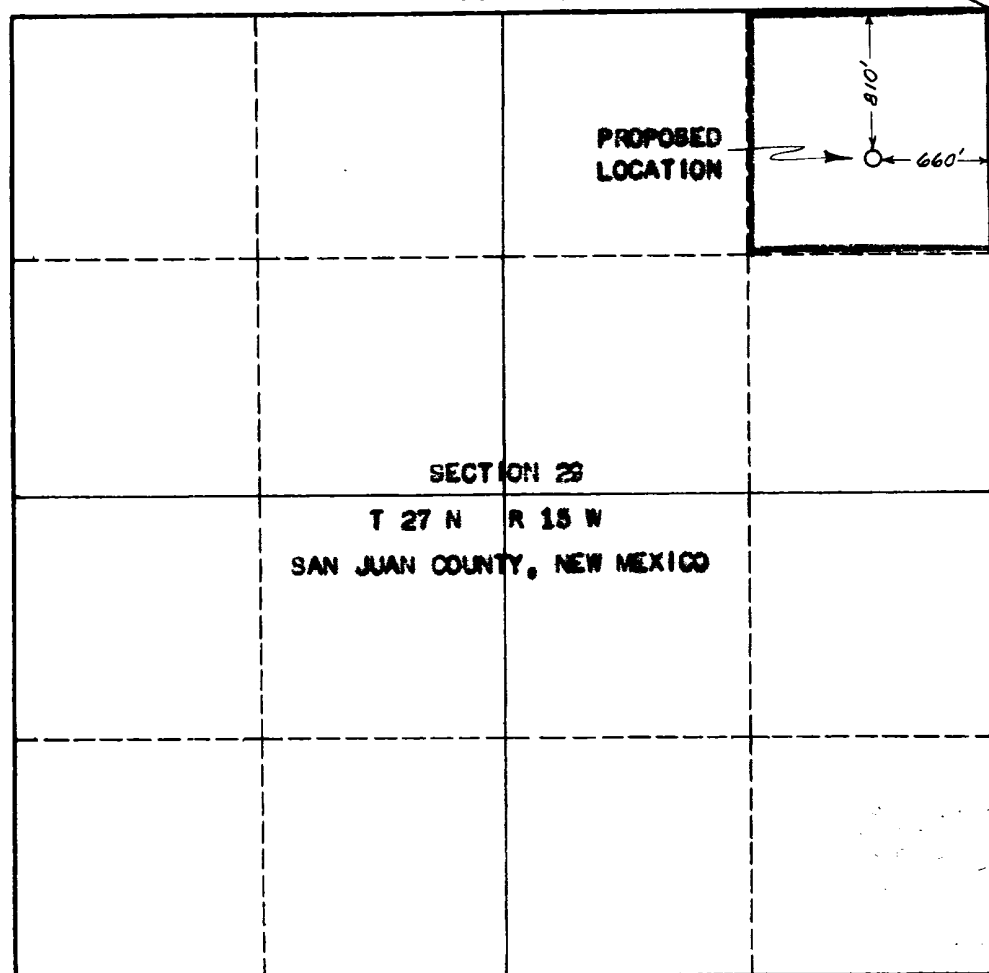

**CERTIFICATION**

I hereby certify that the information in SECTION A above is true and complete to the best of my knowledge and belief. Original Signed By:  
**H. D. HALEY**

Name	<b>H. D. Haley</b>
Position	<b>District Superintendent</b>
Company	<b>Continental Oil Company</b>
Date	<b>May 16, 1962</b>

I hereby certify that the well location shown on the plat in SECTION B was plotted from field notes of actual surveys made by me or under my supervision, and that the same is true and correct to the best of my knowledge and belief.

Date Surveyed	<b>April 18, 1962</b>
Registered Professional Engineer and/or Land Surveyor	<i>W. M. Clark</i>
Certificate No.	<b>73184</b>

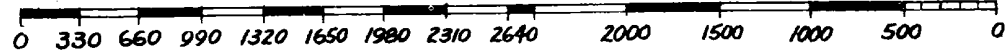

## INSTRUCTIONS FOR COMPLETION OF FORM C-128

1. Operator shall furnish and certify to the information called for in Section A.
2. Operator shall outline the dedicated acreage for *both* oil and gas wells on the plat in Section B.
3. A registered professional engineer or land surveyor registered in the State of New Mexico or approved by the Commission shall show on the plat the location of the well and certify this information in the space provided.
4. All distances shown on the plat must be from the outer boundaries of the Section.
5. If additional space is needed for listing owners and their respective interests as required in question 3 of Section A, please use space below.