



COPY TO O.C.C.

UNITED STATES  
 DEPARTMENT OF THE INTERIOR  
 GEOLOGICAL SURVEY  
 P. O. Box 965  
 Farmington, New Mexico



April 28, 1955

J. Glenn Turner  
 Box 728  
 Farmington, New Mexico

Re: New Mexico Oil 393

Gentlemen:

Receipt is acknowledged of your "Notice of Intention to Drill" dated April 28, 1955 covering your well No. 4-21 Cleveland in SW $\frac{1}{4}$  sec. 21, T. 27 N., R. 9 W., N. M. P. M., San Juan County, New Mexico, Fulcher-Kutz pool (ext.).

Your proposed work is hereby approved subject to compliance with the provisions of the "Oil and Gas Operating Regulations" revised May 25, 1942, a copy of which will be sent to you on request, and subject to the following conditions:

1. Drilling operations so authorized are subject to the attached sheet for general conditions of approval.
2. Furnish copies of all logs.

Very truly yours,

(Orig. Signed by P. J. ...  
 ...)

(Orig. Signed by ...  
**A. P. Kleeman**  
 Acting District Engineer

APKleeman:ac

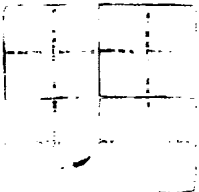



1947  
1948  
1949  
1950  
1951  
1952  
1953  
1954  
1955  
1956  
1957  
1958  
1959  
1960  
1961  
1962  
1963  
1964  
1965  
1966  
1967  
1968  
1969  
1970  
1971  
1972  
1973  
1974  
1975  
1976  
1977  
1978  
1979  
1980  
1981  
1982  
1983  
1984  
1985  
1986  
1987  
1988  
1989  
1990  
1991  
1992  
1993  
1994  
1995  
1996  
1997  
1998  
1999  
2000  
2001  
2002  
2003  
2004  
2005  
2006  
2007  
2008  
2009  
2010  
2011  
2012  
2013  
2014  
2015  
2016  
2017  
2018  
2019  
2020  
2021  
2022  
2023  
2024  
2025

2025

2025

Form 9-331a  
(Feb. 1951)

(SUBMIT IN TRIPLICATE)

Land Office New Mexico

Lease No. 011393

Unit SW/4

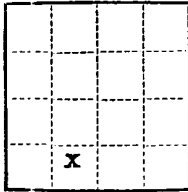

UNITED STATES  
DEPARTMENT OF THE INTERIOR  
GEOLOGICAL SURVEY

SUNDRY NOTICES AND REPORTS ON WELLS

NOTICE OF INTENTION TO DRILL.....	<input checked="" type="checkbox"/>	SUBSEQUENT REPORT OF WATER SHUT-OFF.....	
NOTICE OF INTENTION TO CHANGE PLANS.....		SUBSEQUENT REPORT OF SHOOTING OR ACIDIZING.....	
NOTICE OF INTENTION TO TEST WATER SHUT-OFF.....		SUBSEQUENT REPORT OF ALTERING CASING.....	
NOTICE OF INTENTION TO RE-DRILL OR REPAIR WELL.....		SUBSEQUENT REPORT OF RE-DRILLING OR REPAIR.....	
NOTICE OF INTENTION TO SHOOT OR ACIDIZE.....		SUBSEQUENT REPORT OF ABANDONMENT.....	
NOTICE OF INTENTION TO PULL OR ALTER CASING.....		SUPPLEMENTARY WELL HISTORY.....	
NOTICE OF INTENTION TO ABANDON WELL.....			

(INDICATE ABOVE BY CHECK MARK NATURE OF REPORT, NOTICE, OR OTHER DATA)

April 28, 1955, 19

Turner - Cleveland

Well No. 4-21 is located 990 ft. from N line and 1650 ft. from W line of sec. 21

SW/4 Sec. 21 T. 27 N. R. 9 W. N. M. P. M.  
(1/4 Sec. and Sec. No.) (Twp.) (Range) (Meridian)

Fulcher Kutz (Ext) San Juan County New Mexico  
(Field) (County or Subdivision) (State or Territory)

The elevation ~~6245~~ above sea level is 6245 ft. (Ungraded ground level)

DETAILS OF WORK

(State names of and expected depths to objective sands; show sizes, weights, and lengths of proposed casings; indicate mudding jobs, cementing points, and all other important proposed work)

Propose to spud with cable tools; then drill with rotary drills to the top of the Pictured Cliffs Formation - expected between 1,900 feet and 2,200 feet below surface. Completion with cable tools and sand oil fracturing or shooting with solidified nitro glycerine as conditions warrant.

Casing program: 90' length of 3 1/2" x 8' and 2 1/2" casing, cemented to surface, using at least 25 sacks of cement.

5 1/2" O.D. 1 1/2" J-55 sealers casing to be set on top of fractured Cliffs formation cemented with 100 sacks regular cement.

1" tubing to be set within 20' from of total depth for production.

I understand that this plan of work must receive approval in writing by the Geological Survey before operations may be commenced.  
J. Glenn Fisher

Company Box 728 - Farmington, New Mexico.

Address State Office: 17th St., Mercantile Bank Bldg.

By G. Deason Neal  
Agent in Farmington

Title \_\_\_\_\_

Company J. Glen Turner

Lease TURNER CLEVELAND Well No. 4-21

Sec. 21 T. 27 N R. 9 W N.M.P.M.

Location 930 feet from south line; 1650 feet from west line; being NW $\frac{1}{4}$  SE $\frac{1}{4}$  SW $\frac{1}{4}$

Elevation: 6245 GL.

San Juan County New Mexico

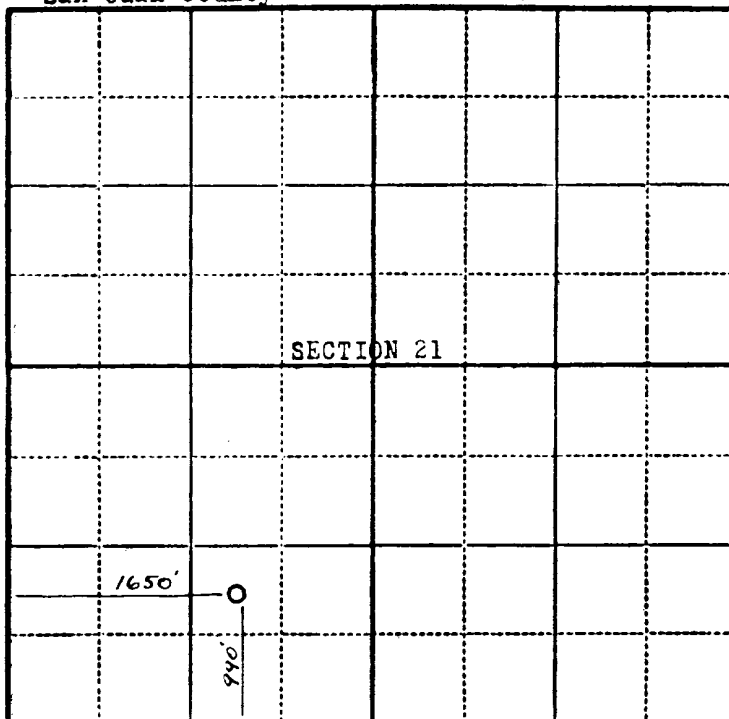

Scale—4 inches equal 1 mile.

This is to certify that the above plat was prepared from field notes of actual surveys made by me or under my supervision and that the same are true and correct to the best of my knowledge and belief.

*Stephen H. Kinney*  
STEPHEN H. KINNEY  
Registered Professional  
Engineer and Land Surveyor

Surveyed April 22, 1955

Seal:

RECORDED  
U. S. GEOLOGICAL SURVEY  
FARMINGTON, NEW MEXICO