

(SUBMIT IN TRIPLICATE)

UNITED STATES
DEPARTMENT OF THE INTERIOR
GEOLOGICAL SURVEY

Land Office _____
Lease No. 07-952
Unit _____

SUNDRY NOTICES AND REPORTS ON WELLS

NOTICE OF INTENTION TO DRILL	<input checked="" type="checkbox"/>	SUBSEQUENT REPORT OF WATER SHUT-OFF
NOTICE OF INTENTION TO CHANGE PLANS		SUBSEQUENT REPORT OF SHOOTING OR ACIDIZING
NOTICE OF INTENTION TO TEST WATER SHUT-OFF		SUBSEQUENT REPORT OF ALTERING CASING
NOTICE OF INTENTION TO RE-DRILL OR REPAIR WELL		SUBSEQUENT REPORT OF REDRILLING OR REPAIR
NOTICE OF INTENTION TO SHOOT OR ACIDIZE		SUBSEQUENT REPORT OF ABANDONMENT
NOTICE OF INTENTION TO PULL OR ALTER CASING		SUPPLEMENTARY WELL HISTORY
NOTICE OF INTENTION TO ABANDON WELL		

(INDICATE ABOVE BY CHECK MARK NATURE OF REPORT, NOTICE, OR OTHER DATA)

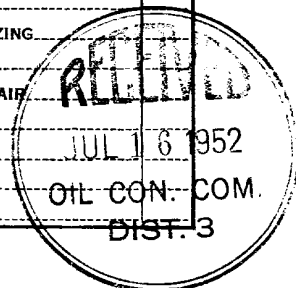

June 17, 1952

Well No. 1 is located 990 ft. from N line and 990 ft. from E line of sec. 23

Sec. 23 (1/4 Sec. and Sec. No.) 27 (Twp.) 10 (Range) N (Meridian)
Fulcher-Kutz (cat) (Field) 27 (County or Subdivision) N (State or Territory)

The elevation of the derrick floor above sea level is _____ ft. to be furnished later.

DETAILS OF WORK

(State names of and expected depths to objective sands; show sizes, weights, and lengths of logging points, and all other important proposed work)

ILLEGIBLE

I understand that this plan of work must receive approval in writing by the Geological Survey before operations may be commenced.

Company _____

Address _____

By [Signature]

Title _____



JUN 17 1952
U.S. GEOLOGICAL SURVEY
FEDERAL BUREAU OF REVENUE

Company J. Glenn Turner
Lease Santa Fe 07252 Well No. Turner-Cordon No. 1

Sec. 23 T. 27 N. R. 10 W., N.M.P.M.

Location 990' from the South line and 990' from the East line.

San Juan County

New Mexico

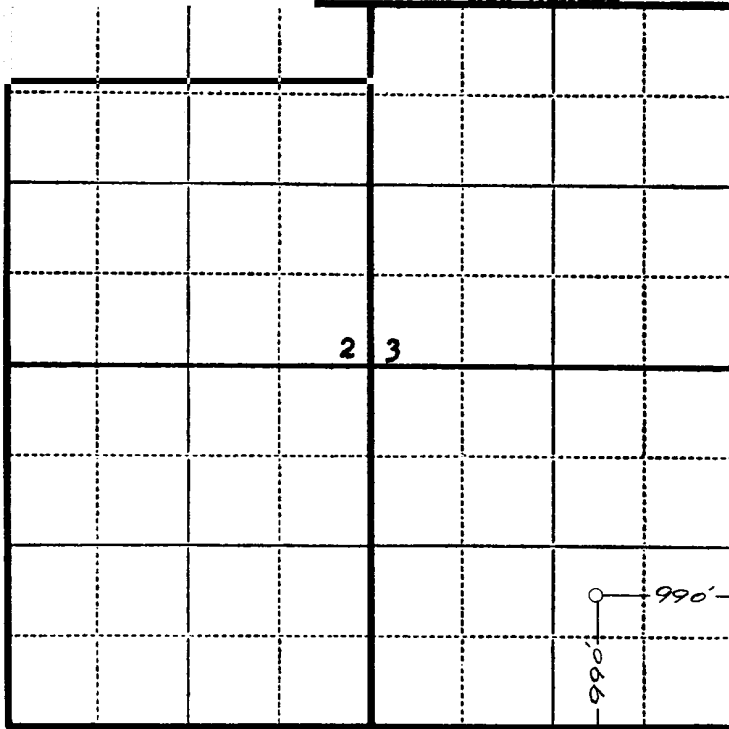

Scale—4 inches equals 1 mile.

This is to certify that the above plat was prepared from field notes of actual surveys made by me or under my supervision and that the same are true and correct to the best of my knowledge and belief.

Charles J. Finklea

Seal:

Registered Professional
Engineer and Land Surveyor.

Charles J. Finklea
N. Mex. Reg. No. 1302

Surveyed June 15, 19 52