

STATE OF NEW MEXICO
OIL CONSERVATION
COMMISSION

DISTRICT NO. 3
Phone 99 P. O. Box 697
AZTEC, NEW MEXICO

(SUBMIT IN TRIPLICATE)

UNITED STATES
DEPARTMENT OF THE INTERIOR
GEOLOGICAL SURVEY

Land Office 688946
Lease No. 079872
Unit _____

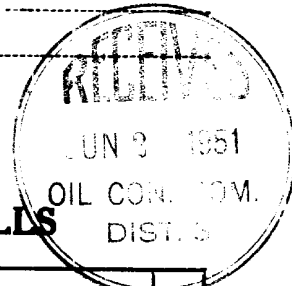

SUNDRY NOTICES AND REPORTS ON WELLS

NOTICE OF INTENTION TO DRILL	SUBSEQUENT REPORT OF WATER SHUT-OFF
NOTICE OF INTENTION TO CHANGE PLANS	SUBSEQUENT REPORT OF SHOOTING OR ACIDIZING
NOTICE OF INTENTION TO TEST WATER SHUT-OFF	SUBSEQUENT REPORT OF ALTERING CASING
NOTICE OF INTENTION TO RE-DRILL OR REPAIR WELL	SUBSEQUENT REPORT OF REDRILLING OR REPAIR
NOTICE OF INTENTION TO SHOOT OR ACIDIZE	SUBSEQUENT REPORT OF ABANDONMENT
NOTICE OF INTENTION TO PULL OR ALTER CASING	SUPPLEMENTARY WELL HISTORY
NOTICE OF INTENTION TO ABANDON WELL	

(INDICATE ABOVE BY CHECK MARK NATURE OF REPORT, NOTICE, OR OTHER DATA)

Bolack #2
C-SW NE SE

May 25 1951

Well No. 2 is located 1650 ft. from XX line and 990 ft. from NE line of sec. 21
SE/4 21 27N 11W N.M.P.M.

W. KUTZ CANYON

(Twp.)

SAN JUAN

(Meridian)

NEW MEXICO

(Field)

(County or Subdivision)

(State or Territory)

NOT DETERMINED.

The elevation of the derrick floor above sea level is 6355 ft.

DETAILS OF WORK

(State names of and expected depths to objective sands; show sizes, weights, and lengths of proposed casings; indicate mudding jobs, cementing points, and all other important proposed work)

1. Drill surface hole and run and set approximately 60' 8-5/8" surface casing and cement to surface.
2. Test surface casing, cement plug and drill to base of Pictured Cliffs sandstone at approximately 2100'.
3. Run electric log.
4. Run and set approximately 2000' of 5 1/2" H-40 1 1/4# casing on reduced hole shoulder in Pictured Cliffs sandstone and cement with 150 sacks of cement.
5. Move off rotary tools, test production string cement plug, drill cement plug, clean out to bottom and shoot with nitro shot.
6. Clean out after shot and complete well ready for production.

I understand that this plan of work must receive approval in writing by the Geological Survey before operations may be commenced.

THE FRONTIER REFINING COMPANY

Company

410 BOSTON BUILDING

Address

DENVER, COLORADO

By

K. C. Forcade, Geologist

Title

RECEIVED
DEPARTMENT OF THE INTERIOR
WASHINGTON, D.C. 20500
(U.S. GOVERNMENT PRINTING OFFICE)

PLAN TO PURCHASE A CAR SOME TIME

[illegible]

(INFORM ABOVE BY CHIEF, NATURE OF REPORT, NOTICE OF OTHER DATA)

[Faint, mostly illegible text from bleed-through or reverse side]

At a level above sea level is

DETAILS OF WORK

1. The first of these is the fact that the Government has not been able to secure the necessary funds to carry out its policy of non-interference. This is due to the fact that the Government has not been able to secure the necessary funds to carry out its policy of non-interference.

Journal of Management Education 36(7) 809-824



Company Frontier Refining Company

Lease Alice Bolack Well No. 2

Sec. 21 T. 27 N. R. 11 W., N.M.P.M.

Location 1650' from the South line and 990' from the East line.

San Juan County

New Mexico

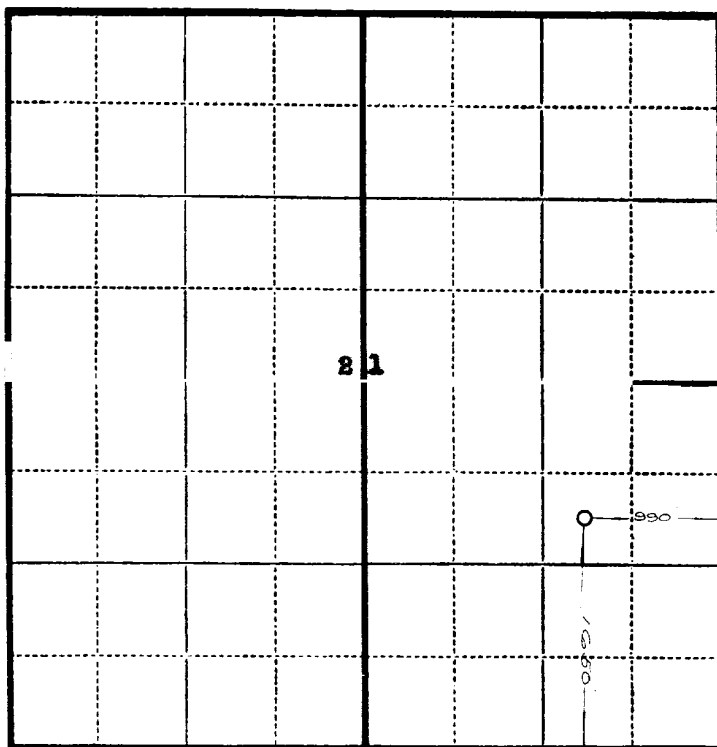

Scale—4 inches equals 1 mile.

This is to certify that the above plat was prepared from field notes of actual surveys made by me or under my supervision and that the same are true and correct to the best of my knowledge and belief.

Charles J. Finklea

Seal:

Registered Professional
Engineer and Land Surveyor.

Charles J. Finklea
N. Mex. Reg. No. 1302

Surveyed May 25, 1951