

(SUBMIT IN TRIPLICATE)

UNITED STATES  
DEPARTMENT OF THE INTERIOR  
GEOLOGICAL SURVEY

Land Office Santa Fe  
Lease No. SP 080168-A  
Unit \_\_\_\_\_

SUNDRY NOTICES AND REPORTS ON WELLS

NOTICE OF INTENTION TO DRILL.....	<input checked="" type="checkbox"/>	SUBSEQUENT REPORT OF WATER SHUT-OFF.....	
NOTICE OF INTENTION TO CHANGE PLANS.....		SUBSEQUENT REPORT OF SHOOTING OR ACIDIZING.....	
NOTICE OF INTENTION TO TEST WATER SHUT-OFF.....		SUBSEQUENT REPORT OF ALTERING CASING.....	
NOTICE OF INTENTION TO RE-DRILL OR REPAIR WELL.....		SUBSEQUENT REPORT OF RE-DRILLING OR REPAIR.....	
NOTICE OF INTENTION TO SHOOT OR ACIDIZE.....		SUBSEQUENT REPORT OF ABANDONMENT.....	
NOTICE OF INTENTION TO PULL OR ALTER CASING.....		SUPPLEMENTARY WELL HISTORY.....	
NOTICE OF INTENTION TO ABANDON WELL.....			

(INDICATE ABOVE BY CHECK MARK NATURE OF REPORT, NOTICE, OR OTHER DATA)

October 23, 1961

H. O. Watson  
Well No. 2 is located 1850 ft. from N line and 790 ft. from W line of sec. 22  
NW/4 Sec. 22 27 N 12 W N.M.P.M.  
(1/4 Sec. and Sec. No.) (Twp.) (Range) (Meridian)  
Basin Dakota San Juan New Mexico  
(Field) (County or Subdivision) (State or Territory)

The elevation of the ground level above sea level is 5828 ft.

DETAILS OF WORK

(State names of and expected depths to objective sands; show sizes, weights, and lengths of proposed casings; indicate mudding jobs, cementing points, and all other important proposed work)

Drill and complete subject well as follows:

1. Drill 12-1/4" hole to 200'. Set 8-5/8" OD, 24#, J-55, STAC casing at 200' and circulate cement to surface. WOC 12 hours and pressure test casing after WOC 8 hours.
2. Drill 7-7/8" hole to TD of approximately 6095'.
3. Run ES-Resistivity and Gamma Ray Sonic logs.
4. Run 4-1/2" OD, 10.5# casing through lowest pay. Set stage collar 50' below base of Pictured Cliff and cement in two stages. First stage: 200 sacks 50-50 Pozmix 6% gal. Second stage: 50 sacks 50-50 Pozmix 6% gal. WOC. Pressure test casing.
5. Perforate, fracture, and clean up well. Run potential test and clean location.

I understand that this plan of work must receive approval in writing by the Geological Survey before operations may be commenced.

Company Tenneco Corporation, acting by and thru its managing agent, Tenneco Oil Co.

Address P. O. Box 1714

Durango, Colorado

By L. B. Flumb

Title District Production Superintendent

NUMBER OF COPIES RECEIVED	
DISTRIBUTION	
SANTA FE	
FILE	
U.S.G.S	
LAND OFFICE	
TRANSPORTER	OIL
	GAS
PROBATION OFFICE	
OPERATOR	

**NEW MEXICO OIL CONSERVATION COMMISSION**  
**WELL LOCATION AND ACREAGE DEDICATION PLAT**  
 SEE INSTRUCTIONS FOR COMPLETING THIS FORM ON THE REVERSE SIDE

FORM C-128  
 Revised 5/1/57

**SECTION A**

Operator <b>PERNICO OIL COMPANY</b>		Lease <b>H. C. WATSON</b>		Well No. <b>2</b>
Unit Letter <b>E</b>	Section <b>22</b>	Township <b>27 North</b>	Range <b>12 West</b>	County <b>San Juan</b>
Actual Footage Location of Well: <b>1850</b> feet from the <b>North</b> line and <b>790</b> feet from the <b>West</b> line				
Ground Level Elev. <b>5827.8 ungraded</b>	Producing Formation <b>Dakota</b>	Pool <b>Basin Dakota</b>	Dedicated Acreage <b>320</b> Acres	

1. Is the Operator the only owner in the dedicated acreage outlined on the plat below? YES ☒ NO ☐ ("Owner" means the person who has the right to drill into and to produce from any pool and to appropriate the production either for himself or for himself and another. 165-3-29 (a) NMSA 1925 Comp.)
2. If the answer to question one is "no," have the interests of all the owners been consolidated by community or agreement or otherwise? YES ☐ NO ☐ If answer is "yes," Type of Consolidation \_\_\_\_\_
3. If the answer to question two is "no," list all the owners and their respective interests below:

Owner	Land Description

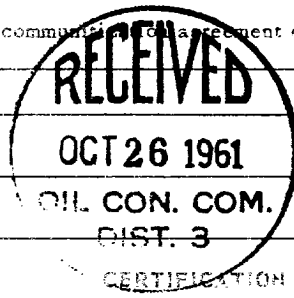

**SECTION B**

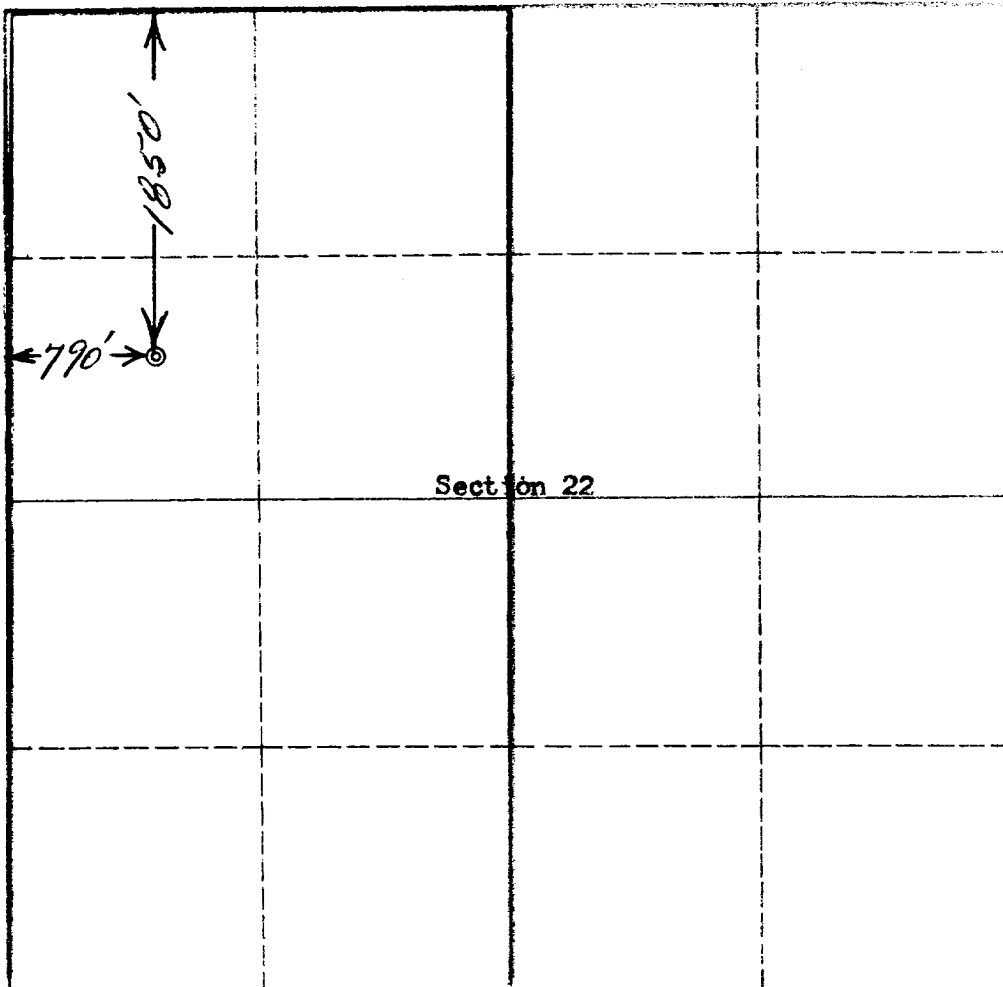

I hereby certify that the information in SECTION A above is true and complete to the best of my knowledge and belief.

Name **L. B. Plumb**  
 Position **Dist. Production Supt.**  
 Company **Perenco Corp. acting by & thru its managing agent, Perenco Oil Company**  
 Date **October 23, 1961**

I hereby certify that the well location shown on the plat in SECTION B was plotted from field notes of actual surveys made by me or under my supervision, and that the same is true and correct to the best of my knowledge and belief.

Date Surveyed **19 October 1961**  
 Registered Professional Engineer and/or Land Surveyor  
**Robert H. [Signature]**  
**San Juan Engineering Co.**  
 Certificate No. **2463**

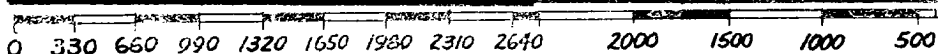

## INSTRUCTIONS FOR COMPLETION OF FORM C-128

1. Operator shall furnish and certify to the information called for in Section A.
2. Operator shall outline the dedicated acreage for *both* oil and gas wells on the plat in Section B.
3. A registered professional engineer or land surveyor registered in the State of New Mexico or approved by the Commission shall show on the plat the location of the well and certify this information in the space provided.
4. All distances shown on the plat must be from the outer boundaries of the Section.
5. If additional space is needed for listing owners and their respective interests as required in question 3 of Section A, please use space below.