



COPY TO O.C.G.

UNITED STATES
DEPARTMENT OF THE INTERIOR
GEOLOGICAL SURVEY
P. O. Box 965
Farmington, New Mexico

IN REPLY REFER TO:



April 28, 1955

J. Glenn Turner
Box 728
Farmington, New Mexico

Re: New Mexico 011393

Gentlemen:

Receipt is acknowledged of your "Notice of Intention to Drill" dated April 27, 1955 covering your well No. 1-20 Cleveland in NE $\frac{1}{4}$ sec. 20, T. 27 N., R. 9 W., N. M. P. M., San Juan County, New Mexico, Fulcher-Kuts pool.

Your proposed work is hereby approved subject to compliance with the provisions of the "Oil and Gas Operating Regulations" revised May 25, 1942, a copy of which will be sent to you on request, and subject to the following conditions:

1. Drilling operations so authorized are subject to the attached sheet for general conditions of approval.
2. Furnish copies of all logs.

Very truly yours,

(Orig. Sgd.) A. F. Kleeman

A. F. Kleeman
District Engineer

AFKleeman:ac

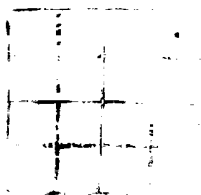

UNITED STATES DEPARTMENT OF THE ARMY
HEADQUARTERS, ARMY
WASHINGTON, D. C. 20315

0-0-0

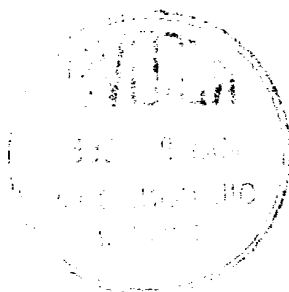

(SUBMIT IN TRIPLICATE)

UNITED STATES
DEPARTMENT OF THE INTERIOR
GEOLOGICAL SURVEYLand Office New Mexico
Lease No. 011393
Unit NE/4

SUNDRY NOTICES AND REPORTS ON WELLS

NOTICE OF INTENTION TO DRILL.....	<input checked="" type="checkbox"/>	SUBSEQUENT REPORT OF WATER SHUT-OFF.....
NOTICE OF INTENTION TO CHANGE PLANS.....	<input type="checkbox"/>	SUBSEQUENT REPORT OF SHOOTING OR ACIDIZING.....
NOTICE OF INTENTION TO TEST WATER SHUT-OFF.....	<input type="checkbox"/>	SUBSEQUENT REPORT OF ALTERING CASING.....
NOTICE OF INTENTION TO RE-DRILL OR REPAIR WELL.....	<input type="checkbox"/>	SUBSEQUENT REPORT OF RE-DRILLING OR REPAIR.....
NOTICE OF INTENTION TO SHOOT OR ACIDIZE.....	<input type="checkbox"/>	SUBSEQUENT REPORT OF ABANDONMENT.....
NOTICE OF INTENTION TO PULL OR ALTER CASING.....	<input type="checkbox"/>	SUPPLEMENTARY WELL HISTORY.....
NOTICE OF INTENTION TO ABANDON WELL.....	<input type="checkbox"/>	

(INDICATE ABOVE BY CHECK MARK NATURE OF REPORT, NOTICE, OR OTHER DATA)

RECEIVED
APR 27 1955
U.S. GEOLOGICAL SURVEY
FARMINGTON, NEW MEXICO

April 27, 1955, 19

Farmer - Cleveland

Well No. 1-20 is located 1090 ft. from N line and 990 ft. from E line of sec. 20

NE/4 Sec. 20

(1/4 Sec. and Sec. No.)

T 27 N

(Twp.)

R 9 W

(Range)

N.M.P.M.

(Meridian)

So. Blanco Pictured Cliffs

(Field)

San Juan County

(County or Subdivision)

New Mexico

(State or Territory)

The elevation of ~~subsurface~~ above sea level is 6,413 ft. (Ungraded ground level)

DETAILS OF WORK

(State names of and expected depths to objective sands; show sizes, weights, and lengths of proposed casings; indicate mudding jobs, cementing points, and all other important proposed work)

Propose to plug with cable tools; then drill with rotary tools to the top of the Pictured Cliffs Formation - expected between 1,900 feet and 2,200 feet below surface. Completion with cable tools - and sand oil separating or shooting with solidified oil or glycerin as conditions warrant.

Casing program: 10 feet of 6-5/8" air cased. and 2nd casing. (Circulate cement to surface, using at least 25 sacks of cement.)

5-1/2" 11.3 lb. 4.95 seamiles casing to be set on top of Pictured Cliffs formation cemented with 300 sacks regular cement.

1" tubing to be set and run 20 feet of total depth for production.

I understand that this plan of work must receive approval in writing by the Geological Survey before operations may be commenced.

J. Allen Turner

Company 1228 Farmington, New Mexico.Address 1228 1/2 Ave: 12th St. Farmington New Mexico.

By

Title

C. E. Turner
Agent for Farmington

Company J. Glen Turner

Lease TURNER CLEVELAND

Well No. 1-20

Sec. 20 T. 27 N R. 9 W N.M.P.M.

Location 1090 feet from north line; 990 feet from
east line; being in SW $\frac{1}{4}$ NE $\frac{1}{4}$ NE $\frac{1}{4}$

Elevation: 6413 GL

San Juan County

New Mexico

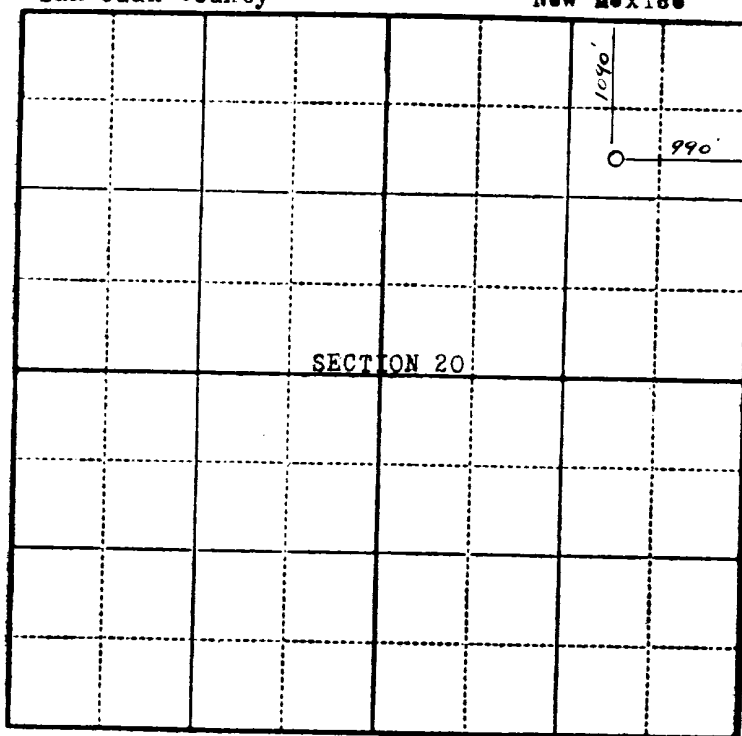

Scale—4 inches equal 1 mile.

This is to certify that the above plat was prepared from field notes of actual surveys made by me or under my supervision and that the same are true and correct to the best of my knowledge and belief.

Stephen H. Kinney

STEPHEN H. KINNEY
Registered Professional
Engineer and Land Surveyor

Surveyed April 22 1955

Seal:

RECEIVED

APR 28 1955

U. S. GEOLOGICAL SURVEY
FARMINGTON, NEW MEXICO