



COPY TO O.C.C.

UNITED STATES
DEPARTMENT OF THE INTERIOR
GEOLOGICAL SURVEY

P. O. Box 965
Farmington, New Mexico

April 28, 1955



J. Glenn Turner
Box 728
Farmington, New Mexico

Re: New Mexico 011393

Gentlemen:

Receipt is acknowledged of your "Notice of Intention to Drill" dated April 28, 1955 covering your well No. 1-21 Cleveland in NE $\frac{1}{4}$ sec. 21, T. 27 N., R. 9 W., N. M. P. M., San Juan County, New Mexico, Fulcher-Kuts (ext).

Your proposed work is hereby approved subject to compliance with the provisions of the "Oil and Gas Operating Regulations" revised May 25, 1942, a copy of which will be sent to you on request, and subject to the following conditions:

1. Drilling operations so authorized are subject to the attached sheet for general conditions of approval.
2. Furnish copies of all logs.

Very truly yours,

(Orig. Sgd.) A. P. Kleeman

A. P. Kleeman
Acting District Engineer

APKleeman:ac

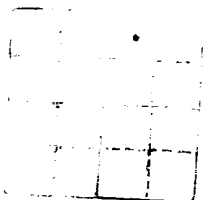

UNITED STATES
DEPARTMENT OF THE INTERIOR
BUREAU OF GEOLOGICAL SURVEY



WATER RESOURCES DIVISION
WASHINGTON, D. C.

REPORT OF THE
COMMISSIONER OF THE GEOLOGICAL SURVEY

FOR THE YEAR 1900

AND
FOR THE YEAR 1901

AND
FOR THE YEAR 1902

AND
FOR THE YEAR 1903

AND
FOR THE YEAR 1904

AND
FOR THE YEAR 1905

AND
FOR THE YEAR 1906

AND
FOR THE YEAR 1907

AND
FOR THE YEAR 1908

AND
FOR THE YEAR 1909

AND
FOR THE YEAR 1910

AND
FOR THE YEAR 1911

AND
FOR THE YEAR 1912

AND
FOR THE YEAR 1913

AND
FOR THE YEAR 1914

AND
FOR THE YEAR 1915

		X	

(SUBMIT IN TRIPPLICATE)

UNITED STATES
DEPARTMENT OF THE INTERIOR
GEOLOGICAL SURVEY

Land Office New Mexico
Lease No. 011393
Unit NE/4

SUNDRY NOTICES AND REPORTS ON WELLS

NOTICE OF INTENTION TO DRILL	<input checked="" type="checkbox"/>	SUBSEQUENT REPORT OF WATER SHUT-OFF	
NOTICE OF INTENTION TO CHANGE PLANS		SUBSEQUENT REPORT OF SHOOTING OR ACIDIZING	
NOTICE OF INTENTION TO TEST WATER SHUT-OFF		SUBSEQUENT REPORT OF ALTERING CASING	
NOTICE OF INTENTION TO RE-DRILL OR REPAIR WELL		SUBSEQUENT REPORT OF RE-DRILLING OR REPAIR	
NOTICE OF INTENTION TO SHOOT OR ACIDIZE		SUBSEQUENT REPORT OF ABANDONMENT	
NOTICE OF INTENTION TO PULL OR ALTER CASING		SUPPLEMENTARY WELL HISTORY	
NOTICE OF INTENTION TO ABANDON WELL			

(INDICATE ABOVE BY CHECK MARK NATURE OF REPORT, NOTICE, OR OTHER DATA)

April 28, 1955

19

Turner - Cleveland

Well No. 1-21 is located 990 ft. from N line and 1636 ft. from E line of sec. 21NE/4 Sec. 21
(1/4 Sec. and Sec. No.)T 27 N
(Twp.)R 9 W
(Range)N. M. P. M.
(Meridian)Fulcher Kutz (Ext) San Juan County
(Field) (County or Subdivision)New Mexico
(State or Territory)The elevation ~~above sea level~~ above sea level is 6225 ft. (Ungraded ground level)

DETAILS OF WORK

(State names of and expected depths to objective sands; show sizes, weights, and lengths of proposed casings; indicate mudding jobs, cementing points, and all other important proposed work)

Propose to spud with cable tool, using all with rotary tools to the top of the Pictured Cliffs formation - corrected between 1,900 feet and 2,200 feet below surface. Completion with cable tool - and sand oil fracturing or shooting with sandified water glass as conditions require.

Casing program - 40 feet of 2 1/2" x 3/4" 20# casing. Circulate cement to surface using at least 15 sacks of cement.

5 1/2" x 20" 20# 155 sections casing to be run on top of Pictured Cliffs formation cemented with 100 sacks regular cement.

1" tubing to be run within 40 feet of true depth for production.

I understand that this plan of work must receive approval in writing by the Geological Survey before operations may be commenced.

Company Turner - Cleveland
Address 1115 N. 1st St. Mercantile Bank Bldg
By [Signature]
Title Agent

Company J. Glen Turner

Lease TURNER CLEVELAND Well No. 1-21

Sec. 21 T. 27 N R. 9 W N.M.P.M.

Location 990 feet from north line; 1636 feet from east line; being in $SE\frac{1}{4}$ $NW\frac{1}{4}$ $NE\frac{1}{4}$

Elevation: 6225 GL

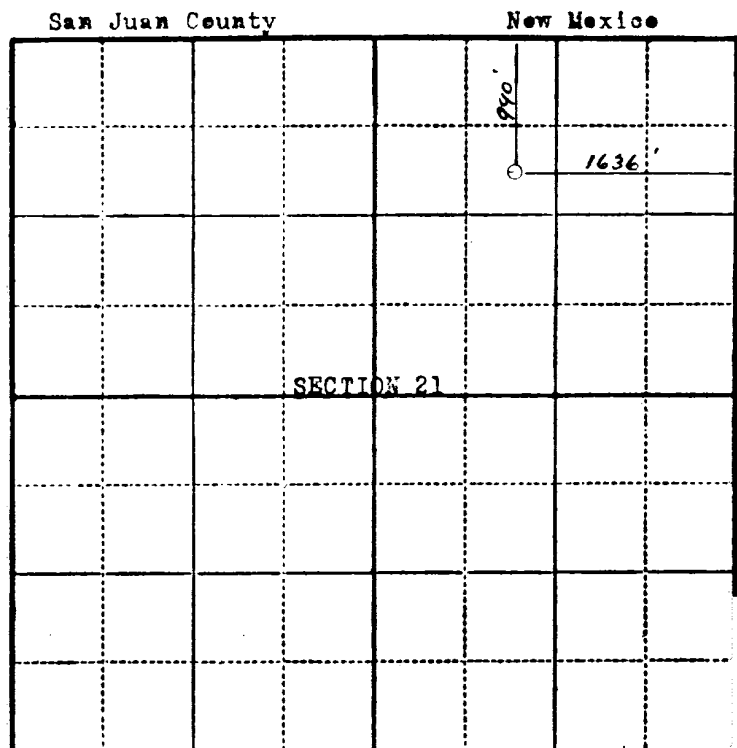

RECEIVED
APR 28 1955
U. S. GEOLOGICAL SURVEY
FARMINGTON, NEW MEXICO

Scale—4 inches equal 1 mile.

This is to certify that the above plat was prepared from field notes of actual surveys made by me or under my supervision and that the same are true and correct to the best of my knowledge and belief.

Stephen H. Kinney

STEPHEN H. KINNEY
Registered Professional
Engineer and Land Surveyor

Surveyed April 22, 1955

Seal: