

**Land Office**

**Lease No.**

Unit

UNITED STATES  
DEPARTMENT OF THE INTERIOR  
GEOLOGICAL SURVEY

RECOMMENDATIONS:

## SUNDRY NOTICES AND REPORTS ON WELLS

WELLS  
FARMINGTON NEW MEXICO

NOTICE OF INTENTION TO DRILL		SUBSEQUENT REPORT OF WATER SHUT-OFF	
NOTICE OF INTENTION TO CHANGE PLANS		SUBSEQUENT REPORT OF SHOOTING OR ACIDIZING	
NOTICE OF INTENTION TO TEST WATER SHUT-OFF		SUBSEQUENT REPORT OF ALTERING CASING	
NOTICE OF INTENTION TO RE-DRILL OR REPAIR WELL		SUBSEQUENT REPORT OF RE-DRILLING OR REPAIR	
NOTICE OF INTENTION TO SHOOT OR ACIDIZE		SUBSEQUENT REPORT OF ABANDONMENT	
NOTICE OF INTENTION TO PULL OR ALTER CASING		SUPPLEMENTARY WELL HISTORY	
NOTICE OF INTENTION TO ABANDON WELL			

(INDICATE ABOVE BY CHECK MARK NATURE OF REPORT, NOTICE, OR OTHER DATA)

Well No. #2 is located 1450 ft. from [N] line and 1450 ft. from [E] line of sec. 20  
NW 1/4 20 27N - 11W NMPM  
 (1/4 Sec. and Sec. No.) (Twp.) (Range) (Meridian)  
West Katz San Juan New Mexico  
 (Field) (County or Subdivision) (State or Territory)

The elevation of the derrick floor above sea level is 143 ft.

## DETAILS OF WORK

(State names of and expected depths to objective sands; show sizes, weights, and lengths of proposed casings; indicate mudding jobs, cementing points, and all other important proposed work)

To make it difficult to drill to test the  
bottom of the formation there will be  
casing and 30 ft. of 8" pipe will be set +  
cemented with cement. It is estimated to be 5 1/2" of 10  
pipe will be set through the formation + cemented  
in place. The well will be set + cemented in place  
to the bottom.

SEE  
THE  
ATTACHED

I understand that this plan of work must receive approval in writing by the Geological Survey before operations may be commenced.

Company F. W. & Y. Key

Address 201 1st St

By

**Title**



NEW MEXICO OIL CONSERVATION COMMISSION  
Well Location and Acreage Dedication Plat

Section A.

Date \_\_\_\_\_

Operator FRANK YOCKEY Lease Too Key  
Well No. \_\_\_\_\_ Unit Letter F Section 20 Township 27 NORTH Range 11 WEST, NMPM  
Located 1450 Feet From THE NORTH Line, 1450 Feet From THE WEST Line  
County SAN JUAN G. L. Elevation 6197.5 Dedicated Acreage 169 Acres  
Name of Producing Formation Pictured Cliffs Pool West Key

1. Is the Operator the only owner\* in the dedicated acreage outlined on the plat below?  
Yes X No \_\_\_\_\_.
2. If the answer to question one is "no," have the interests of all the owners been consolidated by communitization agreement or otherwise? Yes \_\_\_\_\_ No \_\_\_\_\_. If answer is "yes," Type of Consolidation \_\_\_\_\_
3. If the answer to question two is "no," list all the owners and their respective interests below:

Owner

Land Description

Section B

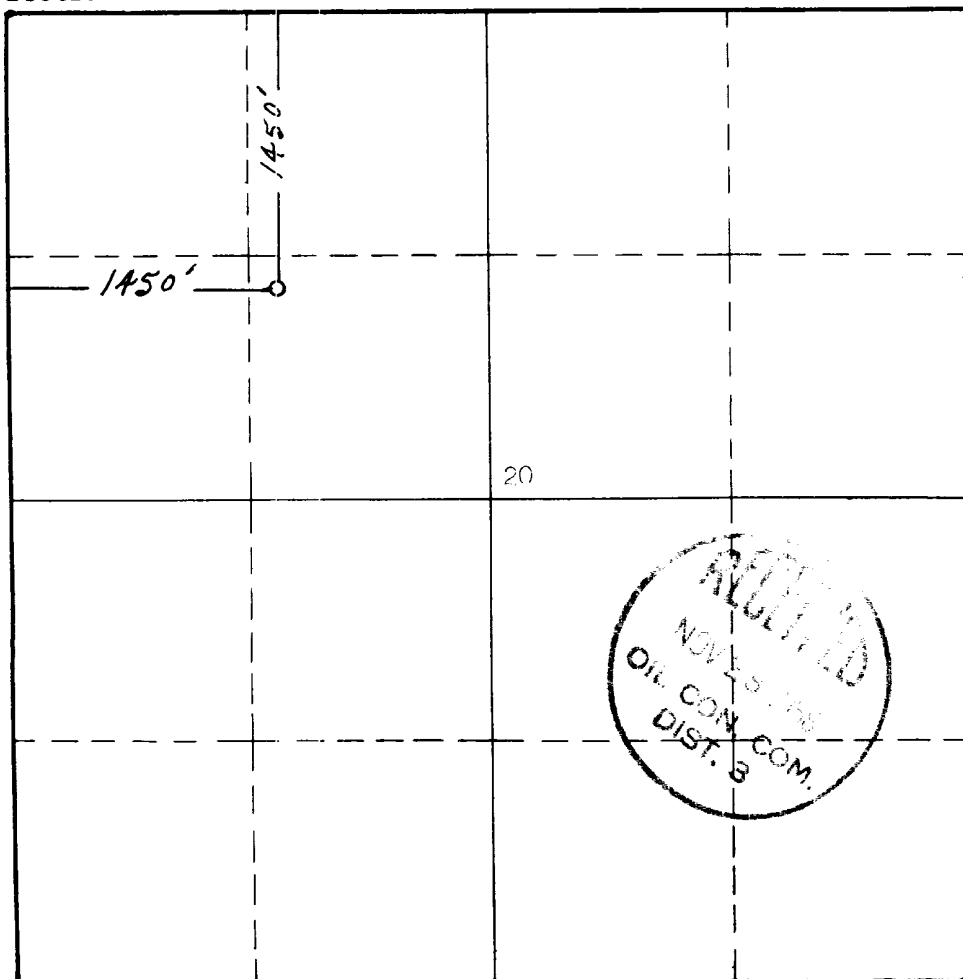

This is to certify that the information in Section A above is true and complete to the best of my knowledge and belief.

Frank Yockey  
(Operator)

Frank Yockey  
(Representative)

Box 2655 Farmington, N.M.  
Address

This is to certify that the well location shown on the plat in Section B was plotted from field notes of actual surveys made by me or under my supervision and that the same is true and correct to the best of my knowledge and belief.

Date Surveyed 20th Nov. 1958

James P. Leese  
Registered Professional  
Engineer and/or Land Surveyor.  
James P. Leese

Certificate No. 1463

(See instructions for completing this form on the reverse side)

INSTRUCTIONS FOR COMPLETION:

1. Operator shall furnish and certify to the information called for in Section A.
2. Operator shall outline the dedicated acreage for both oil and gas wells on the plat in Section B.
3. A registered professional engineer or land surveyor registered in the State of New Mexico or approved by the Commission shall show on the plat, the location of the well and certify this information in the space provided.
4. All distances shown on the plat must be from the outer boundaries of Section.
5. If additional space is needed for listing owners and their respective interests as required in question 3, Section A, please use space below

\* "Owner" means the person who has the right to drill into and to produce from any pool and to appropriate the production either for himself or for himself and another. (65-3-29 (e) NMSA 1953 Comp.)

---