

X			

(SUBMIT IN TRIPLICATE)

UNITED STATES
DEPARTMENT OF THE INTERIOR
GEOLOGICAL SURVEY

Land Office Santa Fe
Lease No. 078421
Unit _____

SUNDRY NOTICES AND REPORTS ON WELLS

NOTICE OF INTENTION TO DRILL	XXXX	SUBSEQUENT REPORT OF WATER SHUT-OFF
NOTICE OF INTENTION TO CHANGE PLANS		SUBSEQUENT REPORT OF SHOOTING OR ACIDIZING
NOTICE OF INTENTION TO TEST WATER SHUT-OFF		SUBSEQUENT REPORT OF ALTERING CASING
NOTICE OF INTENTION TO RE-DRILL OR REPAIR WELL		SUBSEQUENT REPORT OF RE-DRILLING OR REPAIR
NOTICE OF INTENTION TO SHOOT OR ACIDIZE		SUBSEQUENT REPORT OF ABANDONMENT
NOTICE OF INTENTION TO PULL OR ALTER CASING		SUPPLEMENTARY WELL HISTORY
NOTICE OF INTENTION TO ABANDON WELL		

(INDICATE ABOVE BY CHECK MARK NATURE OF REPORT, NOTICE, OR OTHER DATA)

RECEIVED
JUL 7 1960
U. S. GEOLOGICAL SURVEY
FARMINGTON, NEW MEXICO

Turner - McAdams
Well No. 2 is located 950 ft. from N line and 890 ft. from W line of sec. 20
NW/4 Section 20 T 27-N R 9-W N.M.P.M.
(1/4 Sec. and Sec. No.) (Twp.) (Range) (Meridian)
Angels' Peak Dakota Text. San Juan County New Mexico
(Field) (County or Subdivision) (State or Territory)

The elevation of the derrick floor above sea level is 6,393 ft.

DETAILS OF WORK

(State names of and expected depths to objective sands; show sizes, weights, and lengths of proposed casings; indicate mudding jobs, cementing points, and all other important proposed work)

Dakota T st. West half of Section 20 (320 acres) dedicated to well.
Casing Program: Set 8-5/8" at 350' with 300 sacks. Circulate to surface.
Set 5-1/2" on bottom - expected at 7280'. Cement with
200 sacks - more if needed.
D. V. Tool will be set through Pictured Cliffs zone.

If commercial production is indicated, well will be perforated, sand fractured, and tubing will be run.

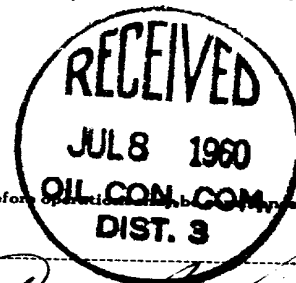

I understand that this plan of work must receive approval in writing by the Geological Survey before operations are begun.

Company J. Glenn Turner and William G. Webb

Address Box 728
Farmington, New Mexico.

Title C. Beeson Neal, Agent in
Farmington.



NEW MEXICO OIL CONSERVATION COMMISSION
WELL LOCATION AND ACREAGE DEDICATION PLAT

FORM C-128
Revised 5/1/57

SEE INSTRUCTIONS FOR COMPLETING THIS FORM ON THE REVERSE SIDE

SECTION A

Operator J. GLENN TURNER and WILLIAM G. WEBB		Lease McAdams		Well No. 2
Unit Letter D	Section 20	Township 27 NORTH	Range 9 WEST	County SAN JUAN
Actual Footage Location of Well: 950 feet from the NORTH line and 890 feet from the WEST line				
Ground Level Elev. 6383.0	Producing Formation Dakota		Pool Angels' Peak Dakota Extension	Dedicated Acreage: 320 Acres

1. Is the Operator the only owner in the dedicated acreage outlined on the plat below? YES ☒ NO ____ . ("Owner" means the person who has the right to drill into and to produce from any pool and to appropriate the production either for himself or for himself and another. (65-3-29 (e) NMSA 1935 Comp.)
2. If the answer to question one is "no," have the interests of all the owners been consolidated by communication agreement or otherwise? YES ____ NO ____ . If answer is "yes," Type of Consolidation ____
3. If the answer to question two is "no," list all the owners and their respective interests below:

Owner	Land Description

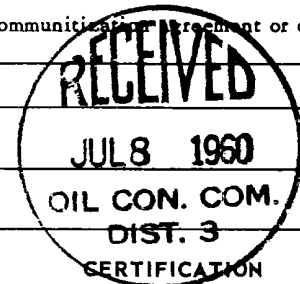

SECTION B

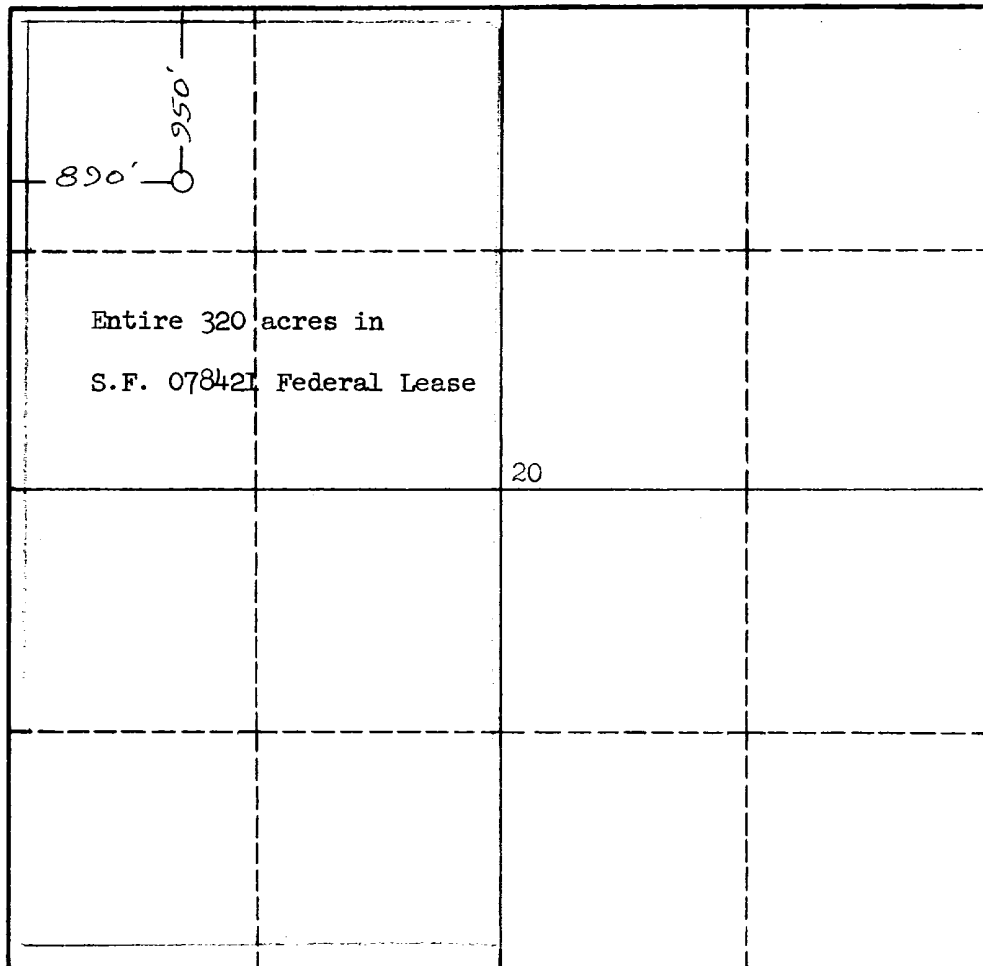

I hereby certify that the information in SECTION A above is true and complete to the best of my knowledge and belief.

Name <i>C. Beeson Neal</i>
Position C. Beeson Neal Agent in Farmington
Company J. Glenn Turner & William G. Webb.
Date July 7, 1960.

I hereby certify that the well location shown on the plat in SECTION B was plotted from field notes of actual surveys made by me or under my supervision, and that the same is true and correct to the best of my knowledge and belief.

Date Surveyed 29 June 1960
Registered Professional Engineer and/or Land Surveyor <i>James P. Leese</i> James P. Leese
Certificate No. 1463

0 330 660 990 1320 1650 1980 2310 2640 2000 1500 1000 500 0

INSTRUCTIONS FOR COMPLETION OF FORM C-128

1. Operator shall furnish and certify to the information called for in Section A.
2. Operator shall outline the dedicated acreage for *both* oil and gas wells on the plat in Section B.
3. A registered professional engineer or land surveyor registered in the State of New Mexico or approved by the Commission shall show on the plat the location of the well and certify this information in the space provided.
4. All distances shown on the plat must be from the outer boundaries of the Section.
5. If additional space is needed for listing owners and their respective interests as required in question 3 of Section A, please use space below.