

| | | | | |
|---|--|--|--|--|
| X | | | | |
| | | | | |
| | | | | |
| | | | | |
| | | | | |

(SUBMIT IN TRIPLICATE)

UNITED STATES
DEPARTMENT OF THE INTERIOR
GEOLOGICAL SURVEY

Land Office **Santa Fe**
Lease No. **SR 080168**
Unit _____

SUNDRY NOTICES AND REPORTS ON WELLS

| | | | |
|--|-------------------------------------|--|---|
| NOTICE OF INTENTION TO DRILL | <input checked="" type="checkbox"/> | SUBSEQUENT REPORT OF WATER SHUT-OFF | RECEIVED JUN 29 1962 U. S. GEOLOGICAL SURVEY ALBUQUERQUE, NEW MEXICO |
| NOTICE OF INTENTION TO CHANGE PLANS | | SUBSEQUENT REPORT OF SHOOTING OR ACIDIZING | |
| NOTICE OF INTENTION TO TEST WATER SHUT-OFF | | SUBSEQUENT REPORT OF ALTERING CASING | |
| NOTICE OF INTENTION TO RE-DRILL OR REPAIR WELL | | SUBSEQUENT REPORT OF RE-DRILLING OR REPAIR | |
| NOTICE OF INTENTION TO SHOOT OR ACIDIZE | | SUBSEQUENT REPORT OF ABANDONMENT | |
| NOTICE OF INTENTION TO PULL OR ALTER CASING | | SUPPLEMENTARY WELL HISTORY | |
| NOTICE OF INTENTION TO ABANDON WELL | | | |

(INDICATE ABOVE BY CHECK MARK NATURE OF REPORT, NOTICE, OR OTHER DATA)

H. O. Watson Gas Unit "A" June 28, 1962
 Well No. **1** is located **790** ft. from **(N)** line and **990** ft. from **(W)** line of sec. **21**
NW/4 Sec. 21 **27N** **12W** **10PM**
 (1/4 Sec. and Sec. No.) (Twp.) (Range) (Meridian)
Basin Dakota **San Juan** **New Mexico**
 (Field) (County or Subdivision) (State or Territory)

The elevation of the **Ground Level** ~~surface~~ above sea level is **5780** ft.

DETAILS OF WORK

(State names of and expected depths to objective sands; show sizes, weights, and lengths of proposed casings; indicate mudding jobs, cementing points, and all other important proposed work)

We propose to drill above well as follows:

1. Drill 12 1/4" hole to 250'.
2. Run and cement 8 5/8" OD 24# J-55 casing. Circulate cement to surface.
3. Drill 7 7/8" hole to 5750' and 6 3/4" hole from 5750' to TD (approx. 6050').
4. Run logs.
5. Run and cement 4 1/2" OD 9.5# J-55 casing. Cement in 2 stages with stage collar 50' below base of Pictured Cliffs formation.
6. Perforate and stimulate formation.
7. Potential well and clean location.

I understand that this plan of work must receive approval in writing by the Geological Survey before operations may be commenced.

Company **Tenneco Oil Company**

Address **P. O. Box 1714**

Durango, Colorado

By *[Signature]* **L.B. Plumb**

Title **District Production Superintendent**

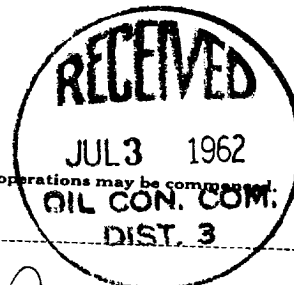

NEW MEXICO OIL CONSERVATION COMMISSION

Well Location and Acreage Dedication Plat

Section A.

Date June 28, 1962

Operator TENNECO OIL COMPANY Lease H. O. WATSON GAS UNIT "A"
 Well No. 1 Unit Letter D Section 21 Township 27 North Range 12 West NMPM
 Located 790 Feet From North Line 990 Feet From West Line
 County San Juan G. L. Elevation 5780 ungraded Dedicated Acreage 320 Acres
 Name of Producing Formation Dakota Pool Basin Dakota

1. Is the Operator the only owner in the dedicated acreage outlined on the plat below?
 Yes x No _____
2. If the answer to question one is "no", have the interests of all the owners been consolidated by communitization agreement or otherwise? Yes _____ No _____. If answer is "yes", Type of Consolidation.
3. If the answer to question two is "no", list all the owners and their respective interests below:

OwnerLand Description

RECEIVED

JUN 29 1962

Section B.

This is to certify that the information in Section A above is true and complete to the best of my knowledge and belief.

Tenneco Oil CompanyOperatorL. B. Plumb(Representative)P. O. Box 1714(Address)Durango, Colorado

Note: All distances must be from outer boundaries of section.

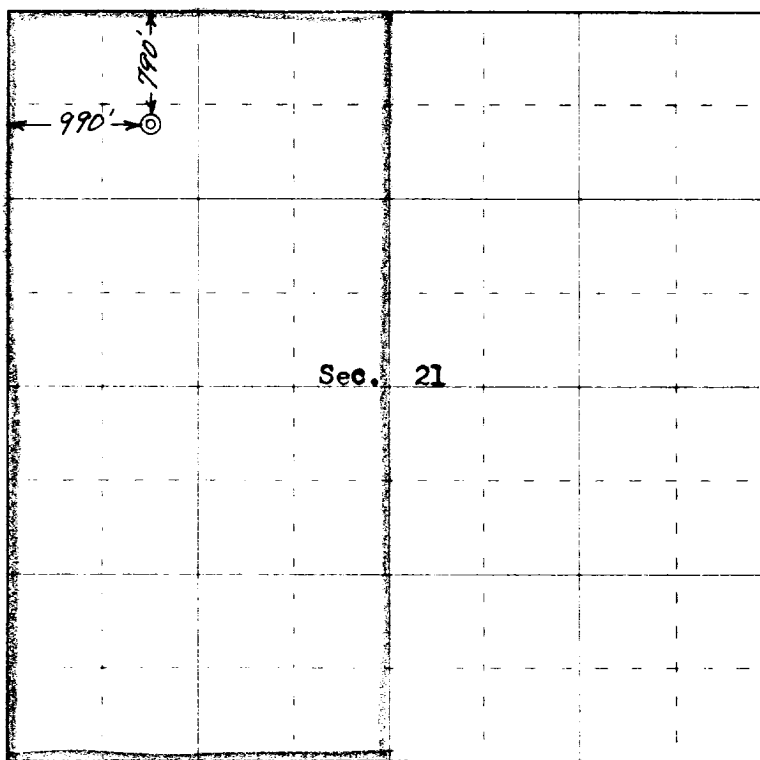
U. S. GEOLOGICAL SURVEY
FARMINGTON, NEW MEXICO

0 330 660 990 1320 1650 1980 2310 2640 2000 15 10 5 0

Scale 4 inches equal 1 mile

RECEIVED

JUL 3 1962

OIL CON. COM.

DIST. 3

This is to certify that the above plat was prepared from field notes of actual surveys made by me or under my supervision and that the same are true and correct to the best of my knowledge and belief.

(Seal)

Date Surveyed 23 June 1962Robert H. Ernst

Registered Professional Engineer and/or Land Surveyor

Robert H. Ernst, PE & LS 2463

Farmington, New Mexico
 San Juan Engineering Company