

(SUBMIT IN TRIPLICATE)

UNITED STATES
DEPARTMENT OF THE INTERIOR
GEOLOGICAL SURVEY

Land Office New Mexico
Lease No. 03380
Unit Florance

SUNDRY NOTICES AND REPORTS ON WELLS

RECEIVED

| | | |
|--|-------------------------------------|--|
| NOTICE OF INTENTION TO DRILL | <input checked="" type="checkbox"/> | SUBSEQUENT REPORT OF WATER SHUT-OFF |
| NOTICE OF INTENTION TO CHANGE PLANS | | SUBSEQUENT REPORT OF SHOOTING OR ACIDIZING |
| NOTICE OF INTENTION TO TEST WATER SHUT-OFF | | SUBSEQUENT REPORT OF ALTERING CASINGS |
| NOTICE OF INTENTION TO RE-DRILL OR REPAIR WELL | | SUBSEQUENT REPORT OF RE-DRILLING OR REPAIR |
| NOTICE OF INTENTION TO SHOOT OR ACIDIZE | | SUBSEQUENT REPORT OF ABANDONMENT |
| NOTICE OF INTENTION TO PULL OR ALTER CASING | | SUPPLEMENTARY WELL HISTORY |
| NOTICE OF INTENTION TO ABANDON WELL | | |

(INDICATE ABOVE BY CHECK MARK NATURE OF REPORT, NOTICE, OR OTHER DATA)

February 4, 1958

Well No. 9-D (EM) is located 1090 ft. from SW line and 1090 ft. from EX line of sec. 17

SW Sec. 17 (1/4 Sec. and Sec. No.) 27N (Twp.) 6W (Range) N.M.P.M. (Meridian)

Blanco MV - So. Blanco P. Co. (Field) San Juan (County or Subdivision) New Mexico (State or Territory)

The elevation of the derrick floor above sea level is 6802 ft.

DETAILS OF WORK

(State names of and expected depths to objective sands; show sizes, weights, and lengths of proposed casings; indicate mudding jobs, cementing points, and all other important proposed work)

It is intended to drill & dual complete a well in the Pictured Cliffs formation & Mesa Verde formation. Mud circulation will be used thru the Pictured Cliffs formation & set intermediate casing. Gas circulation will be used thru the Mesa Verde & a production liner will be set. Possible productive intervals will be perforated & fractured. Estimated Total Depth 5314'.

Casing Program:

10 3/4" at 170' with 150 sacks cement circulated to the surface.

7 5/8" at 4929' with 250 sacks cement.

5 1/2" liner at 5314' with 110 sacks cement.

The W/2 of Section 17 is dedicated to the Mesa Verde.

The SW/4 of Section 17 is dedicated to the Pictured Cliffs.

W/2: EM 03380

I understand that this plan of work must receive approval in writing by the Geological Survey before operations may be commenced.

Company El Paso Natural Gas Company

Address Box 997

Farmington, New Mexico

By Original Signed D. C. Johnston

Title Petroleum Engineer

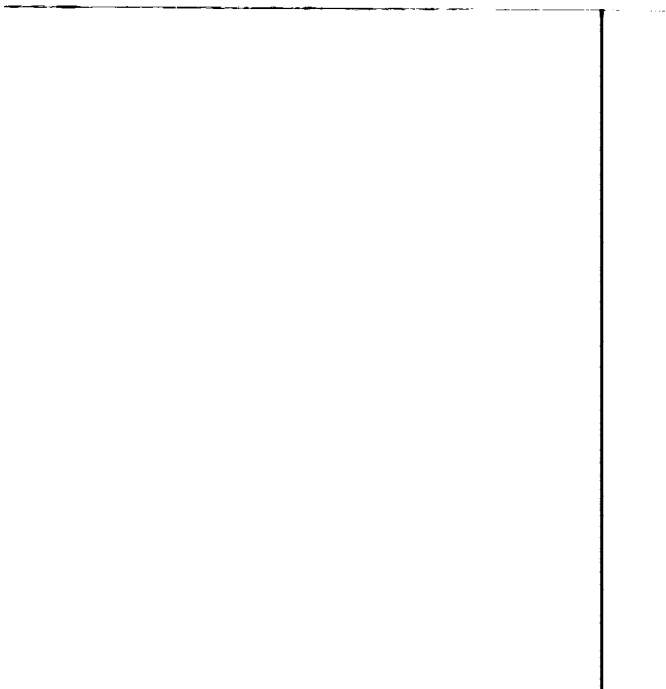

$$W_{\text{eff}} = 1.0 \text{ and } \sigma_{\text{eff}} = 0.5 \text{ for } \sigma_{\text{eff}} = 1.0 \text{ and } W_{\text{eff}} = 0.5$$

1. *Chlorophyll a* (Chl *a*)

By clicking the **Operator** tab, the user is able to view the details of the operator without having to click on the "Operator" link in the left-hand navigation pane.

Y.

Yes _____ No _____
 If the answer to question one is "No", then the respondent will be asked to select directly "agreement" from the "Agreement or Disagreement" section of the survey. If answer one is "Yes", the "Type of Correlation" section will be asked.

| Owner | Legal Description |
|--|-------------------|
| 1. If no answer to question two is "null", then all the property interest is owned | |

See page 13.

I declare under penalty of perjury that the information
in Section A above is true and complete
to the best of my knowledge and belief.

Box 997 Representative

Farmington, New Mexico

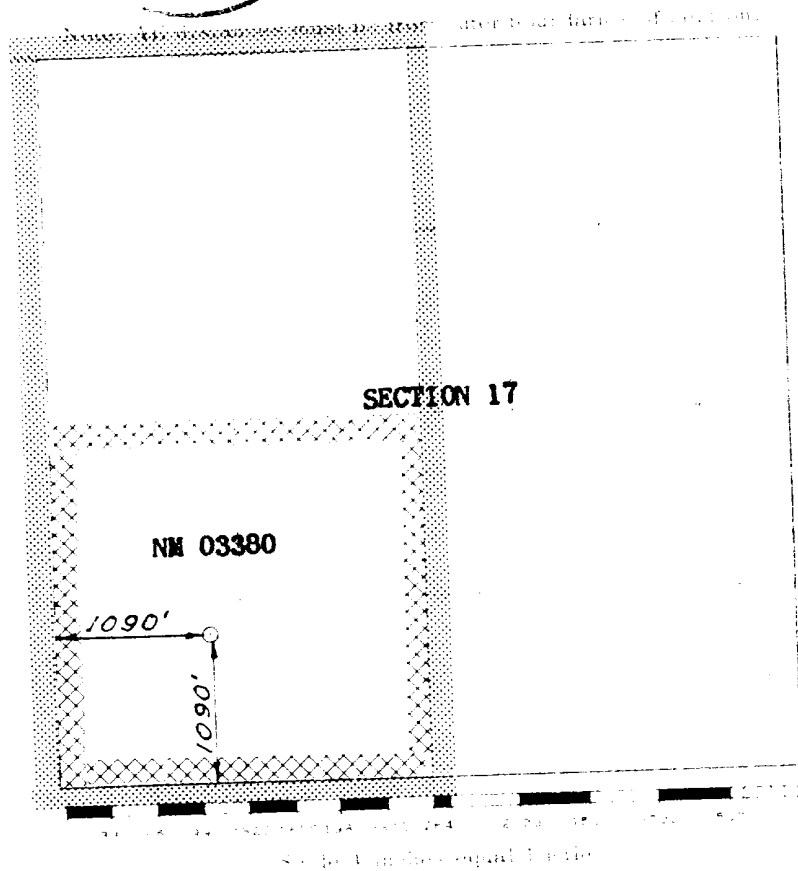

This report is only that which was requested from the Bureau of Animal Services
making no effort to make any other attempt to determine any other facts and is not to the best
of my knowledge and belief.

JANUARY 17, 1957

1. 1. 1.

1. *Journal of the American Medical Association*, 1990; 263: 1001-1005.

1. *Chlorophyll a* (Chl *a*)

OCTOBER 17, 1957

David E. Wilson
1000 Street 1, Phoenix, Arizona 85001