

SANTA FE

Land Office 000002-ALease 21 of Section 17 is
Designated Drilling UnitSTATE OF NEW MEXICO
OIL CONSERVATION
COMMISSIONDISTRICT NO. 3
Phone 99 P. O. Box 697
AZTEC, NEW MEXICO(SUBMIT IN TRIPLICATE)
UNITED STATES
DEPARTMENT OF THE INTERIOR
GEOLOGICAL SURVEY

RECEIVED

NOV 23 1951

OIL CON. COM.

DIST. 3

NOTICE OF INTENTION TO DRILL.....	SUBSEQUENT REPORT OF WATER SHUT-OFF.....
NOTICE OF INTENTION TO CHANGE PLANS.....	SUBSEQUENT REPORT OF SHOOTING OR ACIDIZING.....
NOTICE OF INTENTION TO TEST WATER SHUT-OFF.....	SUBSEQUENT REPORT OF ALTERING CASING.....
NOTICE OF INTENTION TO RE-DRILL OR REPAIR WELL.....	SUBSEQUENT REPORT OF REDRILLING OR REPAIR.....
NOTICE OF INTENTION TO SHOOT OR ACIDIZE.....	SUBSEQUENT REPORT OF ABANDONMENT.....
NOTICE OF INTENTION TO PULL OR ALTER CASING.....	SUPPLEMENTARY WELL HISTORY.....
NOTICE OF INTENTION TO ABANDON WELL.....	

(INDICATE ABOVE BY CHECK MARK NATURE OF REPORT, NOTICE, OR OTHER DATA)

Schmidtloger #11
C 24 RE 22

November 21

21

Well No. 11 is located 2600 ft. from N line and 990 ft. from W line of sec. 17
270 (Twp.) San Juan (Meridian) New Mexico
 (Field) (County or Subdivision) (State or Territory)
 NOT DETERMINED

The elevation of the derrick floor above sea level is _____ ft.

DETAILS OF WORK

(State names of and expected depths to objective sands; show sizes, weights, and lengths of proposed casings; indicate mudding jobs, cementing points, and all other important proposed work)

1. Drill surface hole and run and set approximately 100' 8-5/8" surface casing and cement to surface.
2. Test surface casing, cement plug and drill to base of Pictured Cliffs sandstone at approximately 2000'.
3. Run electric log to total depth.
4. Run and set approximately 1900' of 5 1/2" H-40 14/ casing on top of Pictured Cliffs sandstone and cement with 150 sacks of cement.
5. Move off rotary tools, test production string cement plug, drill cement plug, clean out to bottom and shoot with nitro shot.
6. Clean out after shot and complete well ready for production.

I understand that this report must be approved by the Geological Survey before operations may be commenced.

Company 410 BOSTON BUILDINGAddress DENVER, COLORADOBy L. C. Farnes, Geologist

Title _____

ACITAVESZOS
KORCENI 100

DEPARTMENT OF THE INTERIOR
BUREAU OF RECLAMATION
WASHINGTON, D. C.

3-10-57

1. STATE OF TEXAS
2. COUNTY OF DALLAS
3. IN SENATE
4. January 10, 1907
5. REPORT OF
6. THE COMMISSIONERS OF THE
7. LAND OFFICE
8. FOR THE YEAR 1906
9. AND
10. THE REPORT OF THE
11. COMMISSIONER OF THE
12. LAND OFFICE
13. FOR THE YEAR 1905
14. AND
15. THE REPORT OF THE
16. COMMISSIONER OF THE
17. LAND OFFICE
18. FOR THE YEAR 1904
19. AND
20. THE REPORT OF THE
21. COMMISSIONER OF THE
22. LAND OFFICE
23. FOR THE YEAR 1903
24. AND
25. THE REPORT OF THE
26. COMMISSIONER OF THE
27. LAND OFFICE
28. FOR THE YEAR 1902
29. AND
30. THE REPORT OF THE
31. COMMISSIONER OF THE
32. LAND OFFICE
33. FOR THE YEAR 1901
34. AND
35. THE REPORT OF THE
36. COMMISSIONER OF THE
37. LAND OFFICE
38. FOR THE YEAR 1900
39. AND
40. THE REPORT OF THE
41. COMMISSIONER OF THE
42. LAND OFFICE
43. FOR THE YEAR 1899
44. AND
45. THE REPORT OF THE
46. COMMISSIONER OF THE
47. LAND OFFICE
48. FOR THE YEAR 1898
49. AND
50. THE REPORT OF THE
51. COMMISSIONER OF THE
52. LAND OFFICE
53. FOR THE YEAR 1897
54. AND
55. THE REPORT OF THE
56. COMMISSIONER OF THE
57. LAND OFFICE
58. FOR THE YEAR 1896
59. AND
60. THE REPORT OF THE
61. COMMISSIONER OF THE
62. LAND OFFICE
63. FOR THE YEAR 1895
64. AND
65. THE REPORT OF THE
66. COMMISSIONER OF THE
67. LAND OFFICE
68. FOR THE YEAR 1894
69. AND
70. THE REPORT OF THE
71. COMMISSIONER OF THE
72. LAND OFFICE
73. FOR THE YEAR 1893
74. AND
75. THE REPORT OF THE
76. COMMISSIONER OF THE
77. LAND OFFICE
78. FOR THE YEAR 1892
79. AND
80. THE REPORT OF THE
81. COMMISSIONER OF THE
82. LAND OFFICE
83. FOR THE YEAR 1891
84. AND
85. THE REPORT OF THE
86. COMMISSIONER OF THE
87. LAND OFFICE
88. FOR THE YEAR 1890
89. AND
90. THE REPORT OF THE
91. COMMISSIONER OF THE
92. LAND OFFICE
93. FOR THE YEAR 1889
94. AND
95. THE REPORT OF THE
96. COMMISSIONER OF THE
97. LAND OFFICE
98. FOR THE YEAR 1888
99. AND
100. THE REPORT OF THE
101. COMMISSIONER OF THE
102. LAND OFFICE
103. FOR THE YEAR 1887
104. AND
105. THE REPORT OF THE
106. COMMISSIONER OF THE
107. LAND OFFICE
108. FOR THE YEAR 1886
109. AND
110. THE REPORT OF THE
111. COMMISSIONER OF THE
112. LAND OFFICE
113. FOR THE YEAR 1885
114. AND
115. THE REPORT OF THE
116. COMMISSIONER OF THE
117. LAND OFFICE
118. FOR THE YEAR 1884
119. AND
120. THE REPORT OF THE
121. COMMISSIONER OF THE
122. LAND OFFICE
123. FOR THE YEAR 1883
124. AND
125. THE REPORT OF THE
126. COMMISSIONER OF THE
127. LAND OFFICE
128. FOR THE YEAR 1882
129. AND
130. THE REPORT OF THE
131. COMMISSIONER OF THE
132. LAND OFFICE
133. FOR THE YEAR 1881
134. AND
135. THE REPORT OF THE
136. COMMISSIONER OF THE
137. LAND OFFICE
138. FOR THE YEAR 1880
139. AND
140. THE REPORT OF THE
141. COMMISSIONER OF THE
142. LAND OFFICE
143. FOR THE YEAR 1879
144. AND
145. THE REPORT OF THE
146. COMMISSIONER OF THE
147. LAND OFFICE
148. FOR THE YEAR 1878
149. AND
150. THE REPORT OF THE
151. COMMISSIONER OF THE
152. LAND OFFICE
153. FOR THE YEAR 1877
154. AND
155. THE REPORT OF THE
156. COMMISSIONER OF THE
157. LAND OFFICE
158. FOR THE YEAR 1876
159. AND
160. THE REPORT OF THE
161. COMMISSIONER OF THE
162. LAND OFFICE
163. FOR THE YEAR 1875
164. AND
165. THE REPORT OF THE
166. COMMISSIONER OF THE
167. LAND OFFICE
168. FOR THE YEAR 1874
169. AND
170. THE REPORT OF THE
171. COMMISSIONER OF THE
172. LAND OFFICE
173. FOR THE YEAR 1873
174. AND
175. THE REPORT OF THE
176. COMMISSIONER OF THE
177. LAND OFFICE
178. FOR THE YEAR 1872
179. AND
180. THE REPORT OF THE
181. COMMISSIONER OF THE
182. LAND OFFICE
183. FOR THE YEAR 1871
184. AND
185. THE REPORT OF THE
186. COMMISSIONER OF THE
187. LAND OFFICE
188. FOR THE YEAR 1870
189. AND
190. THE REPORT OF THE
191. COMMISSIONER OF THE
192. LAND OFFICE
193. FOR THE YEAR 1869
194. AND
195. THE REPORT OF THE
196. COMMISSIONER OF THE
197. LAND OFFICE
198. FOR THE YEAR 1868
199. AND
200. THE REPORT OF THE
201. COMMISSIONER OF THE
202. LAND OFFICE
203. FOR THE YEAR 1867
204. AND
205. THE REPORT OF THE
206. COMMISSIONER OF THE
207. LAND OFFICE
208. FOR THE YEAR 1866
209. AND
210. THE REPORT OF THE
211. COMMISSIONER OF THE
212. LAND OFFICE
213. FOR THE YEAR 1865
214. AND
215. THE REPORT OF THE
216. COMMISSIONER OF THE
217. LAND OFFICE
218. FOR THE YEAR 1864
219. AND
220. THE REPORT OF THE
221. COMMISSIONER OF THE
222. LAND OFFICE
223. FOR THE YEAR 1863
224. AND
225. THE REPORT OF THE
226. COMMISSIONER OF THE
227. LAND OFFICE
228. FOR THE YEAR 1862
229. AND
230. THE REPORT OF THE
231. COMMISSIONER OF THE
232. LAND OFFICE
233. FOR THE YEAR 1861
234. AND
235. THE REPORT OF THE
236. COMMISSIONER OF THE
237. LAND OFFICE
238. FOR THE YEAR 1860
239. AND
240. THE REPORT OF THE
241. COMMISSIONER OF THE
242. LAND OFFICE
243. FOR THE YEAR 1859
244. AND
245. THE REPORT OF THE
246. COMMISSIONER OF THE
247. LAND OFFICE
248. FOR THE YEAR 1858
249. AND
250. THE REPORT OF THE
251. COMMISSIONER OF THE
252. LAND OFFICE
253. FOR THE YEAR 1857
254. AND
255. THE REPORT OF THE
256. COMMISSIONER OF THE
257. LAND OFFICE
258. FOR THE YEAR 1856
259. AND
2

1. The first step in the process of the investigation is the identification of the problem. This is done by the investigator who is responsible for the investigation. The investigator must identify the problem and the scope of the investigation. The investigator must also identify the objectives of the investigation and the methods to be used. The investigator must also identify the resources available for the investigation.

Figure 1. The effect of the concentration of the *Agrobacterium* suspension on the transformation efficiency of *Agrobacterium* strains.

100-443887-100



Company The Frontier Refining Co.

Lease _____ Well No. _____

Sec. 17 T. 27 N., R. 11 W., N.M.P.M.

Location 1650' from the South line and 990'
from the East line.

San Juan County

New Mexico

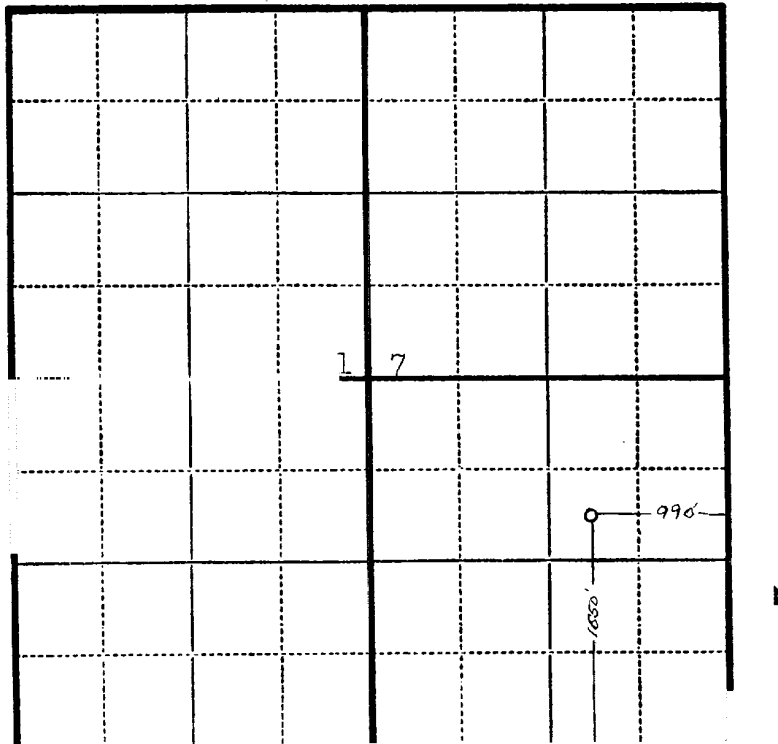

Scale—4 inches equals 1 mile.

This is to certify that the above plat was prepared from field notes of actual surveys made by me or under my supervision and that the same are true and correct to the best of my knowledge and belief.

Charles J. Finklea

Seal:

Registered Professional
Engineer and Land Surveyor.

Charles J. Finklea
N. Mex. Reg. No. 1302

Surveyed October 14, 1951