

(SUBMIT IN TRIPLICATE)

UNITED STATES
DEPARTMENT OF THE INTERIOR
GEOLOGICAL SURVEY

Land Office Santa Fe

Lease No. 078094

Unit NE of Sec. 15
Designated Drilling Unit.

SUNDRY NOTICES AND REPORTS ON WELLS

NOTICE OF INTENTION TO DRILL	<input checked="" type="checkbox"/>	SUBSEQUENT REPORT OF WATER SHUT-OFF
NOTICE OF INTENTION TO CHANGE PLANS	<input type="checkbox"/>	SUBSEQUENT REPORT OF SHOOTING OR ACIDIZING
NOTICE OF INTENTION TO TEST WATER SHUT-OFF	<input type="checkbox"/>	SUBSEQUENT REPORT OF ALTERING CASING
NOTICE OF INTENTION TO RE-DRILL OR REPAIR WELL	<input type="checkbox"/>	SUBSEQUENT REPORT OF REDRILLING OR REPAIR
NOTICE OF INTENTION TO SHOOT OR ACIDIZE	<input type="checkbox"/>	SUBSEQUENT REPORT OF ABANDONMENT
NOTICE OF INTENTION TO PULL OR ALTER CASING	<input type="checkbox"/>	SUPPLEMENTARY WELL HISTORY
NOTICE OF INTENTION TO ABANDON WELL	<input type="checkbox"/>	

(INDICATE ABOVE BY CHECK MARK NATURE OF REPORT, NOTICE, OR OTHER DATA)

March 16

DIST. 3

Well No. 2 is located 1650 ft. from N line and 1650 ft. from E line of sec. 15

Sec. 15 (4 Sec. and Sec. No.) 27N (Twp.) 11W (Range) S.M.P.M. (Meridian)

South Mesa Pool(Ext) (Field) San Juan (County or Subdivision) New Mexico (State or Territory)

The elevation of the derrick floor above sea level is 6327 ft. (GL)

DETAILS OF WORK

(State names of and expected depths to objective sands; show sizes, weights, and lengths of proposed casings; indicate mudding jobs, cementing points, and all other important proposed work)

It is proposed to drill a well to the Top of Pictured Cliffs formation with Rotary as follows: Estimated TD: 2100'.

SURFACE CASING: 10-3/4" OD casing set at 100' and cemented to the surface with 75 sacks cement. Cement to be circulated. WOC 48 hours.

PRODUCTION CASING: 5-1/2" OD casing set on top of Pictured Cliffs and cemented with 50 of regular Portland cement. Casing to be equipped with Larkin Cementrol Shoe, Larkin Clapper Type F1 Col and and 2 Centralizers. Run Temp Sur to locate Top of Cement. WOC 72 hours.

I understand that this plan of work must receive approval in writing by the Geological Survey before operations may be commenced.

Company British American Oil Producing Co.

Address P. O. Box 3187

Oklahoma City, Okla.

By J. J. Callahan
Title Field Engineer

Company British American Oil Producing Co.

Lease Fullerton Well No. 2

Sec. 15 T. 27 N., R. 11 W., N.M.P.M.

Location 1650' from the North line and 1650' from
the East line.



San Juan County

New Mexico

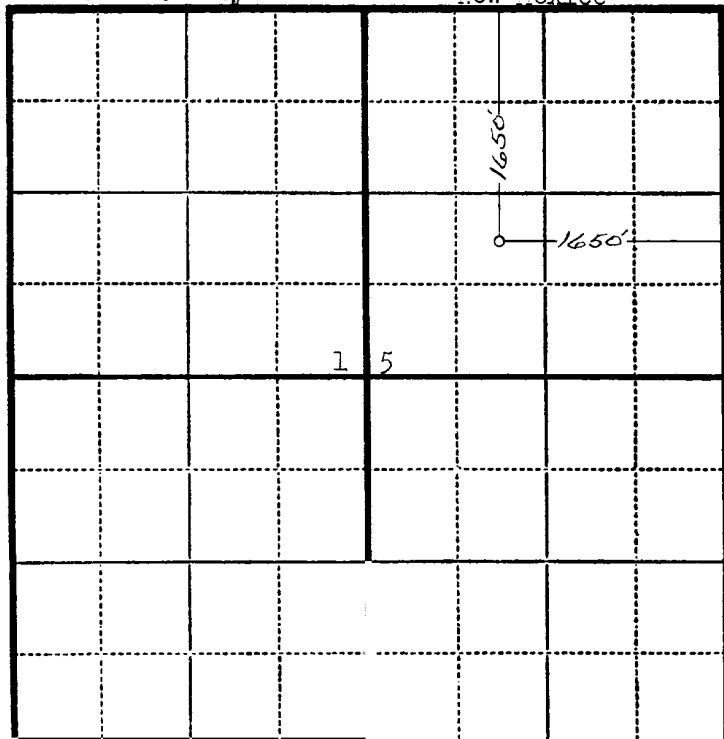

N
|

Scale—4 inches equals 1 mile.

This is to certify that the above plat was prepared from field notes of actual surveys made by me or under my supervision and that the same are true and correct to the best of my knowledge and belief.

Charles J. Finklea

Seal:

Registered Professional Charles J. Finklea
Engineer and Land Surveyor. N. Mex. Reg. No. 1302

Surveyed March 8, 1952

NEW MEXICO
OIL CONSERVATION COMMISSION

Gas Well Plat

Date March 2, 1954

James D. Hancock & Company, Ltd.

Fullerton

2

Operator

Lease

Well No.

Name of Producing Formation Pictured Cliffs Pool West Arita

No. Acres Dedicated to the Well 160

Indicate land status and show ownership Federal

SECTION 15 TOWNSHIP 27 N RANGE 11 W

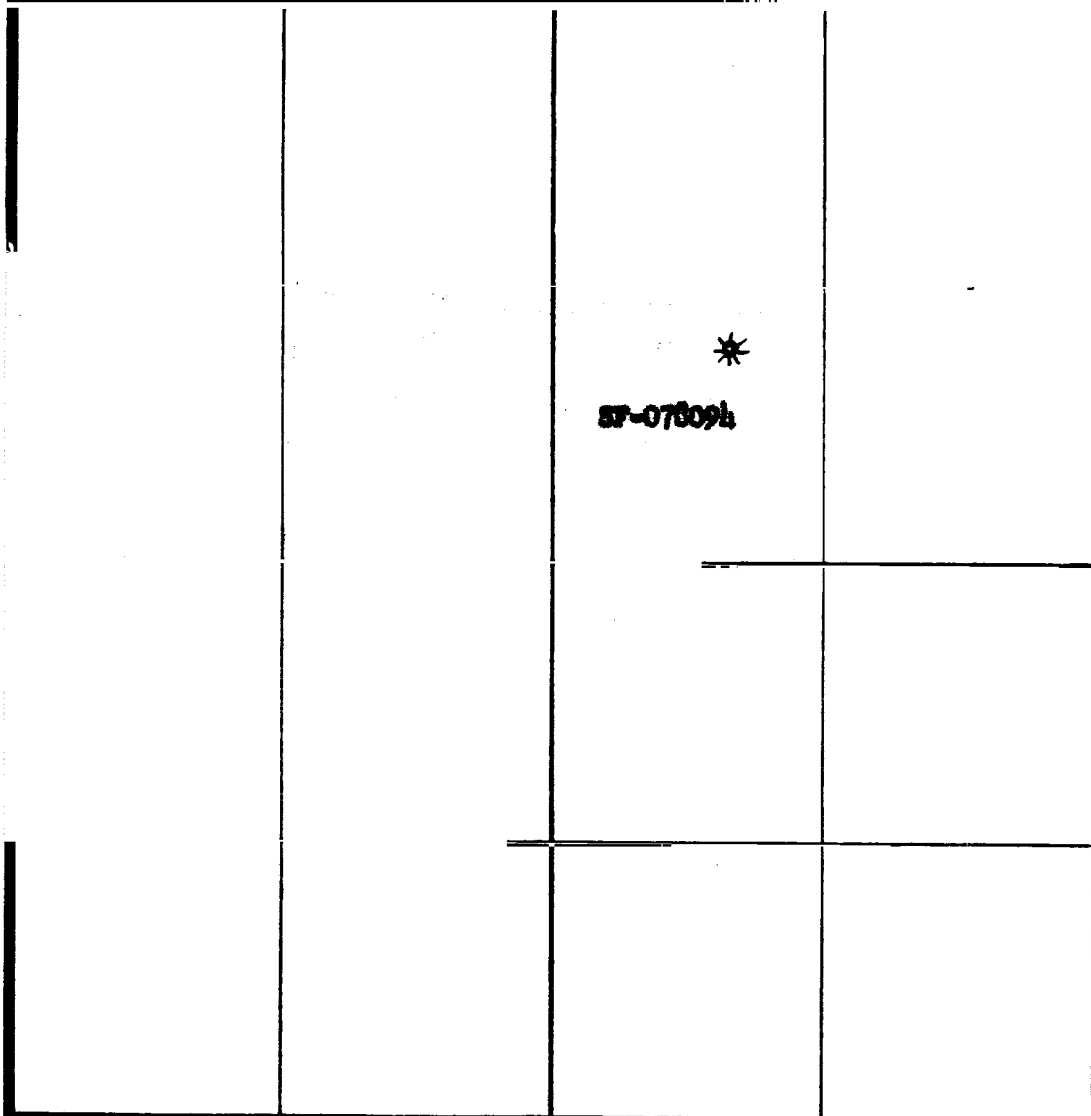

I hereby certify that the information given above is true and complete to the best of my knowledge.

Name J. H. L. L. L.

Position Manager

Representing James D. Hancock & Company, Ltd.

Address 1521 Fidelity Union Life Building
Dallas, Texas

(over)

OIL CONSERVATION COMMISSION

AZTEC DISTRICT OFFICE

No. Copies Received 3

DISTRIBUTION

	NO. FURNISHED	
Operator		
Santa Fe	1	
Proration Office		
State Land Office		
M. & G. S.	1	
Transporter		
File	1	✓

Remade case

F.Loc. 1650/N; 1650/E Elev. 6327 GL Spd. 3/29/52 Comp. 5/5/52 TD 2133 PB
 Casing 30-3/4 @ 108 W 85 Sx. Int. @ W Sx. Pr. 5 1/2 @ 2054 W 200 Sx. T. 1 @ 2127
 Csg. Perf. Prod. Stim. Shot 170 qts 2133-2064

I.P. 1500 ~~8078~~ MCF/D After 3 Hrs. SICP 461 PSI After 3 Days GOR Grav. 1st Del. 5/27/52 SUG

TOPS		NITD	X	Well Log	X	TEST				DATA		
				Plot	X	Schd.	PC	Q	PW	PD	D	Ref. No.
Kirtland		C-102		Electric Log		53					427	
Fruitland		C-103		C-110	XX	54	378	285	251	189	365	
Pictured Cliffs	2051		X		6/22/55	353	214	229	177	267		
Cliff House					8/16/56	323	307	186	161	338		
Menefee		Ditr		Dfa		5/15/57	304	215	170	152	340	
Point Lookout		Datr		Dac		4/5/58	208	238	140	131	322	
Mancos		Remarks Former operator J D Hancock " " Western Devel					204	235	171	155	321	
Tocito						4/23/58	160	235	172	132	301	
Dakota						5/16/58	255	124	174	124	331	
Morrison						5/16/58	204	174	176	128	304	
Entrada						4/23/58	204	174	176	128	304	
						4/23/58	204	174	176	128	304	
						4/23/58	204	174	176	128	304	
PCD	4286				160							

P
 o
 W Kutz PC Co. SJ S 15 T 27N R 11W U G Over Jan. | Feb. | Mar. | Apr. | May | June | July | Aug. | Sept. | Oct. | Nov. | Dec.
Brit-Amer Lse Fullerton No. 2

F. Loc. 1650/N; 1650/E Elev. 6327 L. Spd. 3/29/52 Comp. 5/5/52 TD 2133 PB
 Casing S. 10-3/4 W 108 Sx. Int. 85 @ W Sx. Pr. 5 1/2 @ 2054 W 200 Sx. T. 1 @ 2127
 Csg. Perf. Prod. Stim.

Shot 170 qts 2133-2064

L.P. 1500 ~~1500~~ MCF/D After 3 Hrs. Sic. P. 461 PSI After 3 Days GOR Grav. 1st Del. 5/27/52 SUG

TOPS		NITD	X	Well Log	X	TEST DATA					
Kirtland		C-102		Plat	A	Schd.	PC	Q	PW	PD	D
Fruitland		C-103		Electric Log							427
Pictured Cliffs	2051	C-104	X	C-110	X		378	285	251	189	365
Cliff House		Remarks Former operator Jas D. Hancock									338
Menefee											
Point Lookout											
Mancos											
Tocito											
Dakota											
Morrison											
Entrada											
✓ F&D	4256										

P
 ° W. Kutz co. San Juan s 15 T 27N R 11W U G Oper. W. Dev Co. se. Fullerton 2
 °

Feb. Mar. Apr. May June July Aug. Sept. Oct. Nov. Dec.
 1 G Oper. Brit. Am. Oil Lse. Fullerton No. 2

15-27-11