

UNITED STATES
DEPARTMENT OF THE INTERIOR
GEOLOGICAL SURVEY

APPLICATION FOR PERMIT TO DRILL, DEEPEN, OR PLUG BACK

1a. TYPE OF WORK

DRILL ☒DEEPEN ☐PLUG BACK ☐

b. TYPE OF WELL

OIL
WELL ☒GAS
WELL ☐

OTHER

SINGLE
ZONE ☒MULTIPLE
ZONE ☐

2. NAME OF OPERATOR

MIAMI OIL PRODUCERS, INC.

3. ADDRESS OF OPERATOR

P. O. Drawer 2040, Abilene, Texas

4. LOCATION OF WELL (Report location clearly and in accordance with any State requirements.)*

At surface 660' from NE corner

At proposed prod. zone 660' from NE corner

14. DISTANCE IN MILES AND DIRECTION FROM NEAREST TOWN OR POST OFFICE*

14 miles SW of Farmington, New Mexico

16. DISTANCE FROM PROPOSED*

LOCATION TO NEAREST
PROPERTY OR LEASE LINE, FT.
(Also to nearest drlg. unit line, if any)

660

16. NO. OF ACRES IN LEASE

960

17. NO. OF ACRES ASSIGNED
TO THIS WELL

40

18. DISTANCE FROM PROPOSED LOCATION*
TO NEAREST WELL, DRILLING, COMPLETED,
OR APPLIED FOR, ON THIS LEASE, FT.

-0-

19. PROPOSED DEPTH

5300'

20. ROTARY OR CABLE TOOLS

Rotary

21. ELEVATIONS (Show whether DF, RT, GR, etc.)

5982.3' GL

22. APPROX. DATE WORK WILL START*
Immediately upon
approval

23.

PROPOSED CASING AND CEMENTING PROGRAM

SIZE OF HOLE	SIZE OF CASING	WEIGHT PER FOOT	SETTING DEPTH	QUANTITY OF CEMENT
12 $\frac{1}{2}$ "	8-5/8"	24#	150'	75 sx
6 $\frac{3}{4}$ "	4-1/2"	9.5#	5300'	250 sx

We will drill 12 $\frac{1}{2}$ " hole and set 150' of surface casing with 75 sx of cement, reduce hole size to 6 $\frac{3}{4}$ " to TD of approximately 5300'. Adequate mud will be used at all times. We will core 50' in the Lower Gallup formation, expected to be topped at approximately 5089', and will drill stem test if any oil show is encountered. If productive, 4 $\frac{1}{2}$ " 9.5# casing will be set with adequate cement. If non-productive, we will plug and abandon in accordance with all State and Federal regulations. List of expected formation tops:

Pictured Cliffs	1214'
Lewis	1414'
Mesaverde	2069'
Point Lookout	3809'
Mancos	4009'
Upper Gallup	4919'
Lower Gallup	5089'

IN ABOVE SPACE DESCRIBE PROPOSED PROGRAM: If proposal is to deepen or plug back, give data on present productive zone and proposed new productive zone. If proposal is to drill or deepen directionally, give pertinent data on subsurface locations and measured and true vertical depths. Give blowout preventer program, if any.

24.

SIGNED

Jack Stivers

TITLE

Vice President

DATE

June 11, 1964

(This space for Federal or State office use)

PERMIT NO.

APPROVAL DATE

APPROVED BY

TITLE

DATE

CONDITIONS OF APPROVAL, IF ANY:

*See Instructions On Reverse Side

NEW MEXICO OIL CONSERVATION COMMISSION

Well Location and Acreage Dedication Plat

Section A.

Date June 6, 1964

Operator MIAMI OIL PRODUCERS, INC Lessee OJO ALAMO
 Well No. 1 Unit Letter A Section 14 Township 27 NORTH Range 14 WEST NMPM
 Located 660 Feet From the NORTH Line, 660 Feet From the EAST Line
 County SAN JUAN G. L. Elevation 5982.3' Dedicated Acreage 40 Acres
 Name of Producing Formation Lower Gallup Pool Wildcat

1. Is the Operator the only owner in the dedicated acreage outlined on the plat below?
 Yes Yes No _____
2. If the answer to question one is "no", have the interests of all the owners been consolidated by communitization agreement or otherwise? Yes _____ No _____. If answer is "yes", Type of Consolidation.

3. If the answer to question two is "no", list all the owners and their respective interests below:

OwnerLand Description

Section B.

This is to certify that the information in Section A above is true and complete to the best of my knowledge and belief.

Miami Oil Producers, Inc.

(Operator)

(Representative)

Drawer 2040, Abilene, Texas

(Address)

Note: All distances must be from outer boundaries of section.

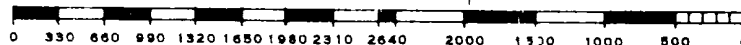
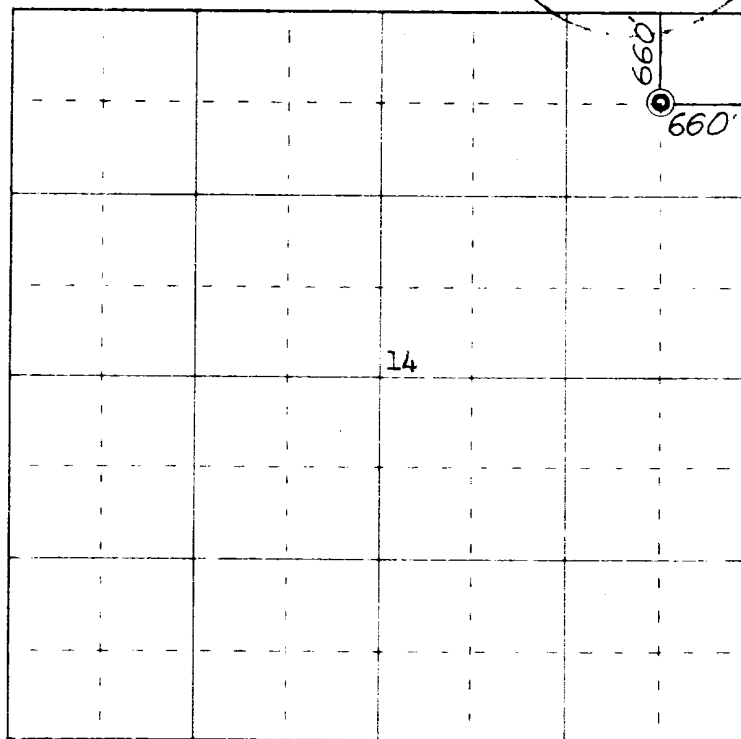

Scale 4 inches equal 1 mile

This is to certify that the above plat was prepared from field notes of actual surveys made by me or under my supervision and that the same are true and correct to the best of my knowledge and belief.

Date Surveyed June 6, 1964

James P. Leese
 Registered Professional Engineer and/or Land Surveyor
 James P. Leese, N. Mex. Reg. No. 1463



UNITED STATES
DEPARTMENT OF THE INTERIOR
GEOLOGICAL SURVEY

APPLICATION FOR PERMIT TO DRILL, DEEPEN, OR PLUG BACK

1a. TYPE OF WORK DRILL ☒ DEEPEN ☐ PLUG BACK ☐

b. TYPE OF WELL

OIL
WELL ☒GAS
WELL ☐OTHER ☐SINGLE
ZONE ☒MULTIPLE
ZONE ☐

2. NAME OF OPERATOR

MIAMI OIL PRODUCERS, INC.

3. ADDRESS OF OPERATOR

P. O. Drawer 2040, Abilene, Texas

4. LOCATION OF WELL (Report location clearly and in accordance with any State requirements.)*

At surface 660' from NE corner

At proposed prod. zone 660' from NE corner

14. DISTANCE IN MILES AND DIRECTION FROM NEAREST TOWN OR POST OFFICE*

14 miles SW of Farmington, New Mexico

10. DISTANCE FROM PROPOSED*

LOCATION TO NEAREST
PROPERTY OR LEASE LINE, FT.
(Also to nearest drilg. unit line, if any)

660

16. NO. OF ACRES IN LEASE

960

17. NO. OF ACRES ASSIGNED
TO THIS WELL

40

18. DISTANCE FROM PROPOSED LOCATION*

TO NEAREST WELL, DRILLING, COMPLETED,
OR APPLIED FOR, ON THIS LEASE, FT.

-0-

19. PROPOSED DEPTH

5300'

20. ROTARY OR CABLE TOOLS

Rotary

21. ELEVATIONS (Show whether DF, RT, GR, etc.)

5982.3' GL

22. APPROX. DATE WORK WILL START*
Immediately upon
approval

23. PROPOSED CASING AND CEMENTING PROGRAM

SIZE OF HOLE	SIZE OF CASING	WEIGHT PER FOOT	SETTING DEPTH	QUANTITY OF CEMENT
12 1/4"	8-5/8"	24#	150'	75 sx
6 3/4"	4-1/2"	9.5#	5300'	250 sx

We will drill 12 1/4" hole and set 150' of surface casing with 75 sx of cement, reduce hole size to 6 3/4" to TD of approximately 5300'. Adequate mud will be used at all times. We will core 50' in the Lower Gallup formation, expected to be topped at approximately 5089', and will drill stem test if any oil show is encountered. If productive, 4 1/2" 9.5# casing will be set with adequate cement. If non-productive, we will plug and abandon in accordance with all State and Federal regulations. List of expected formation tops:

Pictured Cliffs	1214'
Lewis	1414'
Mesaverde	2069'
Point Lookout	3809'
Mancos	4009'
Upper Gallup	4919'
Lower Gallup	5089'

IN ABOVE SPACE DESCRIBE PROPOSED PROGRAM: If proposal is to deepen or plug back, give data on present productive zone and proposed new productive zone. If proposal is to drill or deepen directionally, give pertinent data on subsurface locations and measured and true vertical depths. Give blowout preventer program, if any.

24.

SIGNED

Jack Oliver

TITLE

Vice President

DATE

June 11, 1964

(This space for Federal or State office use)

PERMIT NO.

APPROVAL DATE

APPROVED BY

APPROVED

CONDITIONS OF APPROVAL, IF ANY:

JUN 11 1964

P. T. McGRATH
DISTRICT ENGINEER

TITLE

DATE

*See Instructions On Reverse Side

[illegible]

1. 2. 3.

1. Lower College Student

Note: All lists are subject to change without notice.

Miami Oil Producers, Inc.
 Jack Rivers
 Drawer 2040, Abilene, Texas

[illegible]Scale 1 index = $\frac{1}{2}(1 + 2 + 3 + 4 + 5)$

It is to be clearly stated that the above plot was prepared from the findings of Action surveys and by means of direct supervision and that the same is to be used to direct to the best of my knowledge and belief.

Date received Jan 6, 1964

James E. Lease