

NEW MEXICO OIL CONSERVATION COMMISSION
Well Location and Acreage Dedication Plat

Section A.

Date May 28, 1963

Operator PUBCO PETROLEUM CO. Lease TIDEWATER FEDERAL
Well No. 1-7 Unit letter M Section 7 Township 27 N Range 13 W NMPN
Located 660 Feet From south Line, 660 Feet From west Line
County San Juan G. L. Elevation 6003 Dedicated Acreage 40 Acres
Name of Producing Formation Gallup Pool Wildcat

1. Is the Operator the only owner* in the dedicated acreage outlined on the plat below?
Yes _____ No X _____.
2. If the answer to question one is "no," have the interests of all the owners been consolidated by communitization agreement or otherwise? Yes X No _____. If answer is "yes," Type of Consolidation Farmout from Tidewater
3. If the answer to question two is "no," list all the owners and their respective interests below:

Owner

Land Description

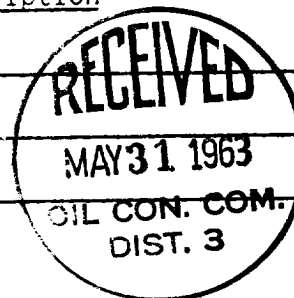

Section B

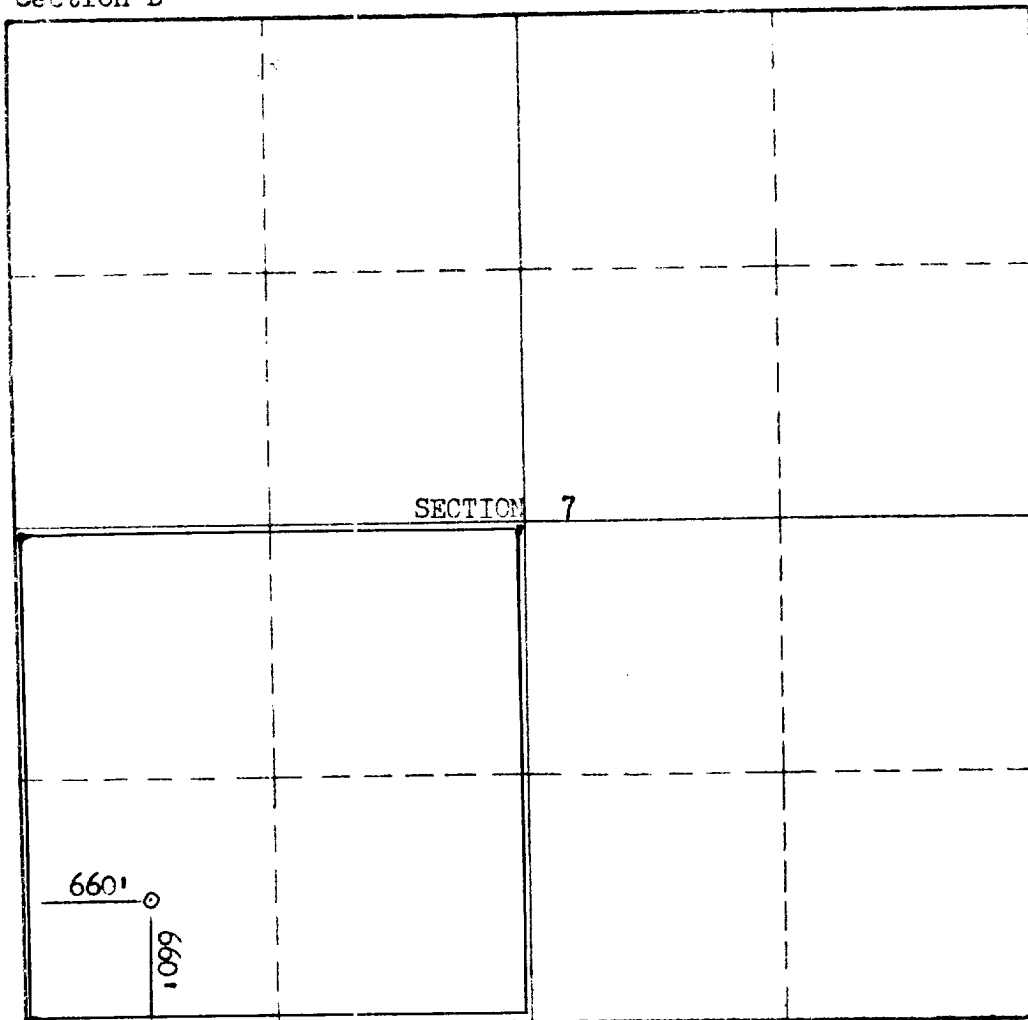

This is to certify that the information in Section A above is true and complete to the best of my knowledge and belief.

PUBCO PETROLEUM CORP.
(Operator)

[Signature]
(Representative)

Box P, Aztec, New Mexico
Address

This is to certify that the well location shown on the plat in Section B was plotted from field notes of actual surveys made by me or under my supervision and that the same is true and correct to the best of my knowledge and belief.

Date Surveyed May 22, 1963
[Signature]
STEPHEN H. KINNEY,

Registered Professional
Engineer and/or Land Surveyor.

Certificate No. 803