

(SUBMIT IN TRIPLICATE)

UNITED STATES  
DEPARTMENT OF THE INTERIOR  
GEOLOGICAL SURVEY

Land Office Santa Fe  
Lease No. SP - 2274  
Unit Whitely

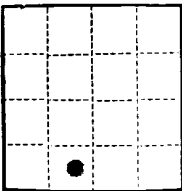

SUNDRY NOTICES AND REPORTS ON WELLS

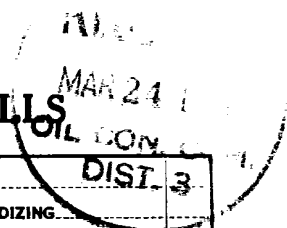

NOTICE OF INTENTION TO DRILL	<input checked="" type="checkbox"/>	SUBSEQUENT REPORT OF WATER SHUT-OFF	
NOTICE OF INTENTION TO CHANGE PLANS		SUBSEQUENT REPORT OF SHOOTING OR ACIDIZING	
NOTICE OF INTENTION TO TEST WATER SHUT-OFF		SUBSEQUENT REPORT OF ALTERING CASING	
NOTICE OF INTENTION TO RE-DRILL OR REPAIR WELL		SUBSEQUENT REPORT OF RE-DRILLING OR REPAIR	
NOTICE OF INTENTION TO SHOOT OR ACIDIZE		SUBSEQUENT REPORT OF ABANDONMENT	
NOTICE OF INTENTION TO PULL OR ALTER CASING		SUPPLEMENTARY WELL HISTORY	
NOTICE OF INTENTION TO ABANDON WELL			

(INDICATE ABOVE BY CHECK MARK NATURE OF REPORT, NOTICE, OR OTHER DATA)

March 21, 1961

Well No. 6-D is located 1140 ft. from S line and 1590 ft. from W line of sec. 8

SW 1/4, Section 8  
(1/4 Sec. and Sec. No.)

27N  
(Twp.)

9W  
(Range)

N.M.P.M.  
(Meridian)

Santa Fe  
(Field)

San Juan  
(County or Subdivision)

New Mexico  
(State or Territory)

The elevation of the derrick floor above sea level is 6130 ft. (Green: Elevation)

DETAILS OF WORK

(State names of and expected depths to objective sands; show sizes, weights, and lengths of proposed casings; indicate mudding jobs, cementing points, and all other important proposed work)

Propose To:

Set 300 feet of surface casing and cement to surface.

Drill with rotary to approximately 645 feet or through Dakota formation. Set 4 1/2" production casing at total depth and cement with 270 cu. Set two-stage cement collar 100 feet below Pictured Cliffs formation and cement with 170 cu.

Perforate Dakota formation and sand-water free with 80,000# sand 80,000 gals. water. Run 2 1/8" tubing.

South one-half, 360 acres, Section 8 dedicated to well.

I understand that this plan of work must receive approval in writing by the Geological Survey before operations may be commenced.

Company Agree Oil and Gas Company

Address P. O. Drawer 370

Farmington, New Mexico

ORIGINAL SIGNED BY JOE C. SALMON

By Joe C. Salmon  
District Superintendent

Title \_\_\_\_\_

# NEW MEXICO OIL CONSERVATION COMMISSION

## Well Location and Acreage Dedication Plat

### SECTION A.

Date March 17, 1961

Operator Aztec Oil and Gas Company Lease Whitley  
Well No. 6-D Unit Letter N Section 8 Township 27N Range 9W N.M.P.M.  
Located 1140 Feet From South Line, 1590 Feet From West Line  
County San Juan G. L. Elevation 6339 Dedicated Acreage 320 Acres  
Name of Producing Formation Dakota Pool Basin

1. Is the Operator the only owner\* in the dedicated acreage outlined on the plat below? Yes ☒ No ☐
2. If the answer to question One is "No," have the interests of all the owners been consolidated by communization agreement or otherwise? Yes ☐ No ☐ If answer is "Yes," Type of Consolidation
3. If the answer to question Two is "No," list all the owners and their respective interests below:

OWNER

LAND DESCRIPTION

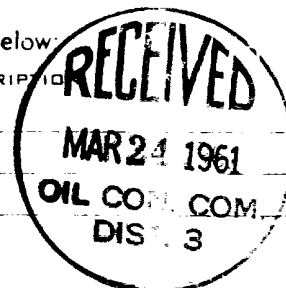

### SECTION B.

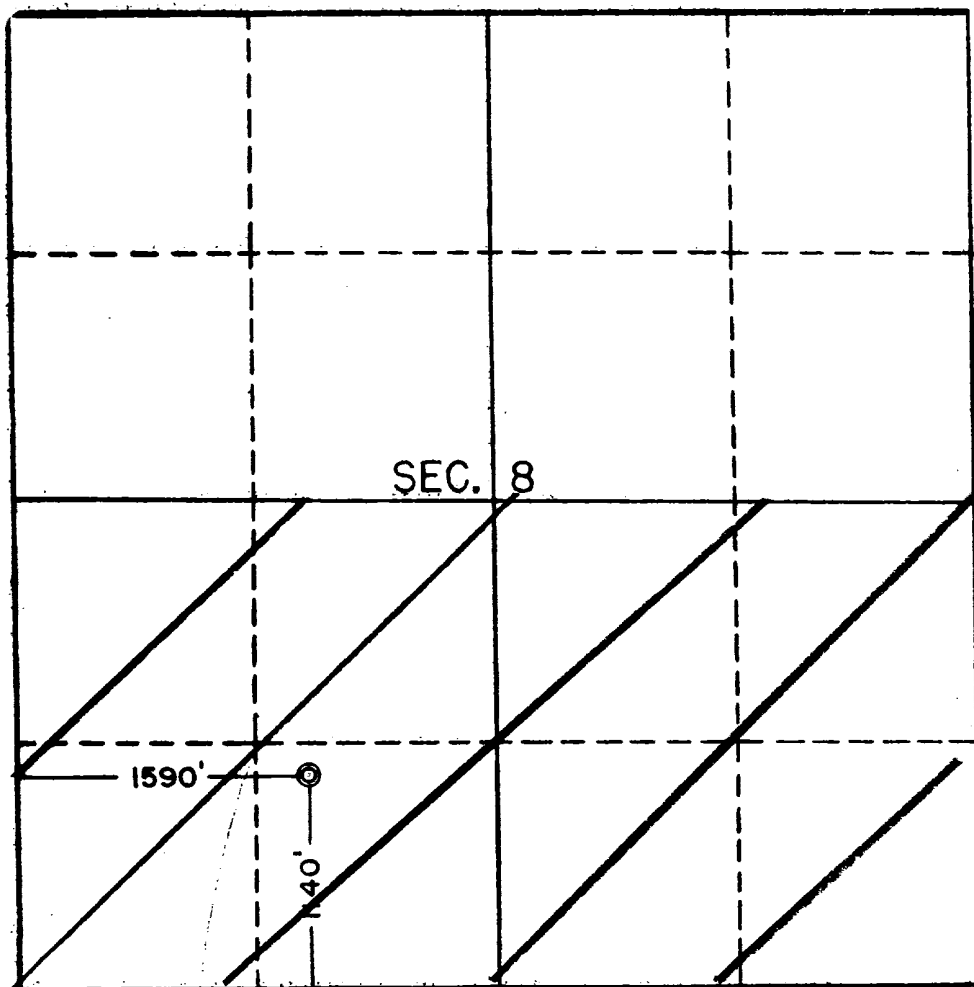

This is to certify that the information in Section A above is true and complete to the best of my knowledge and belief.

Aztec Oil and Gas Company  
OPERATOR

ORIGINAL SIGNED BY JOE C. SALMON

(REPRESENTATIVE)

Drawer 570, Farmington, N.M.  
(ADDRESS)

This is to certify that the well location shown on the plat in Section B was plotted from field notes of actual survey made by me or under my supervision and the same is true and correct to the best of my knowledge and belief.

Date Surveyed 10-3-60

Four States Engineering Co.  
FARMINGTON, NEW MEXICO

C. L. Poter  
REGISTERED ENGINEER OR  
LAND SURVEYOR

Certificate No. 3084

