

(JUNE 1980)

UNITED STATES  
DEPARTMENT OF THE INTERIOR  
BUREAU OF LAND MANAGEMENT

SUNDRY NOTICES AND REPORTS ON WELLS

Do not use this form for proposals to drill or to deepen or reentry to a different reservoir.  
Use "APPLICATION FOR PERMIT-" for such proposals

FORM APPROVED

Budget Bureau No. 1004-0135

Expires: March 31, 1993

5. Lease Designation and Serial No.

I-149-IND-8464

6. If Indian, Allottee or Tribe Name

Navajo Tribe

7. If Unit or CA, Agreement Designation

Nellie Platero Lease

8. Well Name and No.

9. API Well No.

10. Field and Pool, or Exploratory Area

11. County or Parish, State

San Juan County, New Mexico

SUBMIT IN TRIPLICATE

1. Type of Well

☐ Oil  
Well

☐ Gas  
Well

☒ Other

Gas Gathering Line

2. Name of Operator

Texaco E&P Inc.

3. Address and Telephone No.

3300 N. Butler, Farmington, New Mexico 87401 (505)325-4397

4. Location of Well (Footage, Sec., T., R., M., or Survey Description)

K Sec. 11 T27N, R09W

070 FARMINGTON, NM

RECEIVED  
BLM

95 MAY 10 AM 11:19

12. CHECK APPROPRIATE BOX(s) TO INDICATE NATURE OF NOTICE, REPORT, OR OTHER DATA

TYPE OF SUBMISSION

☒

Notice of Intent

☐

Subsequent Report

☐

Final Abandonment Notice

TYPE OF ACTION

☐

Abandonment

☐

Recompletion

☐

Plugging Back

☐

Casing Repair

☐

Altering Casing

☐

Other

☐

Change of Plans

☒

New Construction

☐

Non-Routine Fracturing

☐

Water Shut-Off

☐

Conversion to Injection

☐

Dispose Water

(Note: Report results of multiple completion on well  
Completion or Recombination Report and Log form)

13. Describe Proposed or Completed Operations (Clearly state all pertinent details, and give pertinent dates, including estimated date of starting and proposed work. If well is directionally drilled, give subsurface locations and measured and true vertical depths for all markers and zones pertinent to this work.)

Texaco E&P Inc. requests approval to lay a gas gathering line on the subject lease. This line will stay within the bounds of the lease and will service only wells on this lease. All construction will be contained within the SW 1/4 of Section 11, T27N-R09W.

This 945' line will consist of two segments. The first segment will be 415' in length from Nellie Platero #6 to Nellie Platero #3 and will be buried partially within the road ROW. The second segment will be 530' in length and buried within an existing EL Paso pipeline ROW located between Nellie Platero #5 and Nellie Platero #3.

Provisions and Materials:

- '945' of 2" & 2 1/2" wrapped, schedule 40, steel line pipe. Connections will be welded.
- Pipeline crossing will be marked and buried to 48"
- Line will be pressure tested to 1000 psi... (Anticipated working pressure will be 70 psi)
- Maximum width of disturbance will be 30'

Archaeological clearance has been received. Please refer to Archaeological Report from Moore Anthropological Research - Technical Report No. 95-002.

14. I hereby certify that the foregoing is true and correct

Signed

JCA

Title Operations Manager

APPROVED

(This space for Federal or State office use)

Approved by

Title

SEP  
Date

5 1995

Conditions of approval, if any:

DISTRICT MANAGER

18 U.S.C. Section 1001, makes it a crime for any person knowingly and willfully to make to any department or agency of the United States any false, fictitious or fraudulent statements or representations as to any matter within its jurisdiction.

opies: BLM /5 BIA /2

NMOCD

LNS

RECEIVED  
SEP - 8 1995  
OIL CON. DIV.  
DIST. 3

**Flowline Installation (Nellie Platero Lease)**

To consolidate compression, Texaco proposes to install two (2) flowlines on the Nellie Platero lease.

Lease locations involved:

LEASE	NUMBER	AP NUM	TYPE	G1	G2	SP	SEC	TWNS	RANGE	LEGAL	TO	LEASE NUM	STATE	COUNTY
NELLIE PLATERO	3	3004506637	GAS	NE	SW	K	11	T27N	R09W	1650' FSU/1650' FWL	2185	1-149-IND-8464	NM	SAN JUAN
NELLIE PLATERO	5	3004513040	GAS	SE	SW	N	11	T27N	R09W	900' FSU/1770' FWL	4505	1-149-IND-8464	NM	SAN JUAN
NELLIE PLATERO	6	3004523627	GAS	NW	SW	L	11	T27N	R09W	1560' FSU/1120' FWL	3282	1-149-IND-8464	NM	SAN JUAN

Proposed flowline installations:

<u>From Location</u>	<u>To Location</u>	<u>Distance of Line<sup>1</sup></u>	<u>Total Disturbance</u> (Acre)	<u>Comments</u>
Nellie Platero #6	Nellie Platero #3	415'	0.14	Previously disturbed; Road ROW
Nellie Platero #5	Nellie Platero #3	530'	0.37	Previously disturbed; Pipeline ROW; Road Crossing
Total Acreage			0.51	

<sup>1</sup> Distance of Line is calculated point to point. Distance on well location has not been subtracted.

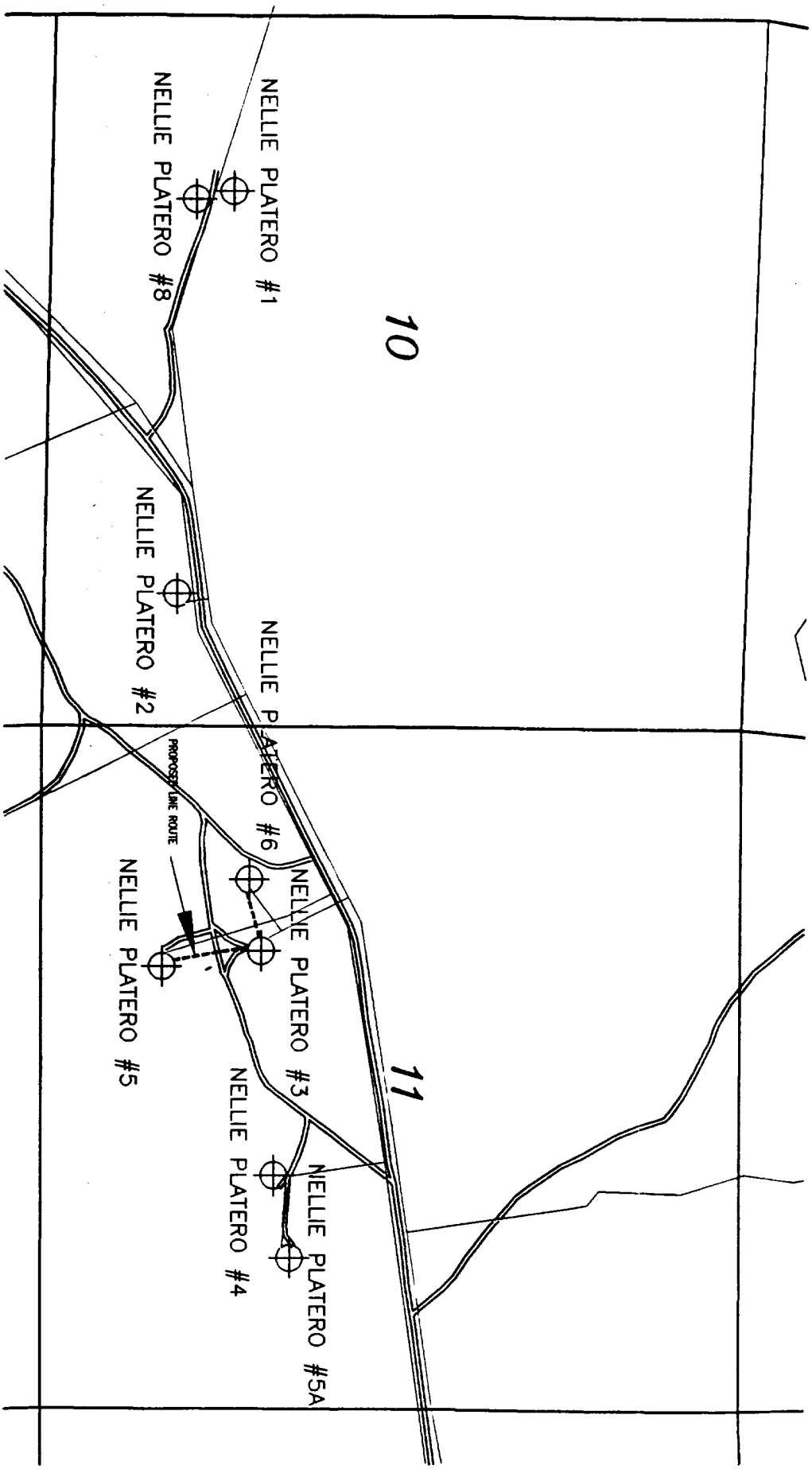

EXISTING EPNG LINES

<b>TEXACO</b>		FRANKFONTE OPERATING UNIT DENVER BRANCH DENVER, COLORADO
AREA: NELLIE PLATERO LEASE		
DATE: 10/11/77		
DESCRIPTION: WELL LOCATIONS		
DRAWN BY: J. A. B.	CHECKED BY: J. A. B.	APPROVED BY: J. A. B.
TITLED BY: J. A. B.	TITLED BY: J. A. B.	TITLED BY: J. A. B.