

All distances must be from the outer boundaries of the Section.

Operator Chevron U.S.A. Inc.		Lease Federal Fullerton		Well No. #7
Unit Letter K	Section 11	Township 27N	Range 11W	County San Juan
Actual Position Location of Well:				
1690	feet from the South	line and	1730	feet from the West
Ground Level Elev. 6129	Producing Formation Pictured Cliffs	Pool Kutz West Pictured Cliffs	Dedicated Acreage: 160 Acres	

1. Outline the acreage dedicated to the subject well by colored pencil or hatchure marks on the plat below.
2. If more than one lease is dedicated to the well, outline each and identify the ownership thereof (both as to working interest and royalty).
3. If more than one lease of different ownership is dedicated to the well, have the interests of all owners been consolidated by communitization, unitization, force-pooling, etc?

☐ Yes ☐ No If answer is "yes," type of consolidation _____

If answer is "no," list the owners and tract descriptions which have actually been consolidated. (Use reverse side of this form if necessary.) _____

No allowable will be assigned to the well until all interests have been consolidated (by communitization, unitization, forced-pooling, or otherwise) or until a non-standard unit, eliminating such interests, has been approved by the Division.

ORIGINAL PLAT ON FILE

Well will be plugged back from the Basin Dakota Pool.

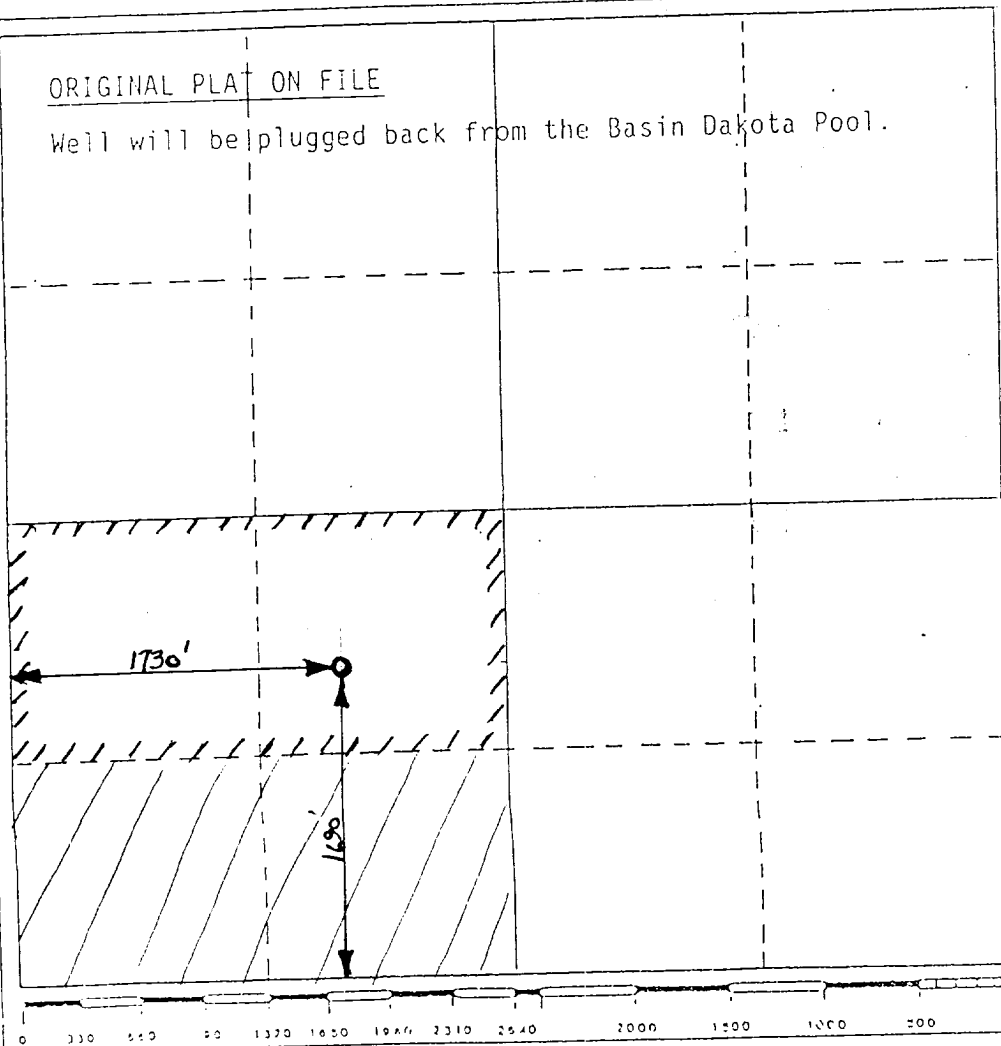

CERTIFICATION

I hereby certify that the information contained herein is true and complete to the best of my knowledge and belief.

J. S. Conley
Name
Petroleum Engineer
Position
Chevron USA
Company
11-9-87
Date

I hereby certify that the well location shown on this plat was plotted from field notes of actual surveys made by me or under my supervision, and that the same is true and correct to the best of my knowledge and belief.

Date Surveyed

Registered Land Surveyor

Certificate No.