

(SUBMIT IN TRIPLICATE)

UNITED STATES
DEPARTMENT OF THE INTERIOR
GEOLOGICAL SURVEY

Land Office **Santa Fe**
Lease No. **101-02254**
Unit **Whitely**

SUNDRY NOTICES AND REPORTS ON WELLS

NOTICE OF INTENTION TO DRILL	<input checked="" type="checkbox"/>	SUBSEQUENT REPORT OF WATER SHUT-OFF	
NOTICE OF INTENTION TO CHANGE PLANS		SUBSEQUENT REPORT OF SHOOTING OR ACIDIZING	
NOTICE OF INTENTION TO TEST WATER SHUT-OFF		SUBSEQUENT REPORT OF ALTERING CASING	
NOTICE OF INTENTION TO RE-DRILL OR REPAIR WELL		SUBSEQUENT REPORT OF RE-DRILLING OR REPAIR	
NOTICE OF INTENTION TO SHOOT OR ACIDIZE		SUBSEQUENT REPORT OF ABANDONMENT	
NOTICE OF INTENTION TO PULL OR ALTER CASING		SUPPLEMENTARY WELL HISTORY	
NOTICE OF INTENTION TO ABANDON WELL			

(INDICATE ABOVE BY CHECK MARK NATURE OF REPORT, NOTICE, OR OTHER DATA)

June 24, 1961

Well No. **Whitely 7-3** is located **1710** ft. from **S** line and **1350** ft. from **W** line of sec. **9**
NE 1/4, Section 9 **27N** **9W** **N.M.P.M.**
(1/4 Sec. and Sec. No.) (Twp.) (Range) (Meridian)
Dakota Dakota **San Juan** **New Mexico**
(Field) (County or Subdivision) (State or Territory)

The elevation of the derrick floor above sea level is **6197** ft. (Graded Ground Elevation)

DETAILS OF WORK

(State names of and expected depths to objective sands; show sizes, weights, and lengths of proposed casings; indicate mudding jobs, cementing points, and all other important proposed work)

Propose To:

Set 300 ft. of 8 5/8" surface casing and cement to surface.
Drill with rotary to approximate total depth of 6000 ft. or through Dakota formation. Set 4 1/2" production casing at total depth and cement with 250 cu. Set two-stage cement collar approximately 100 ft. below the Pictured Cliffs formation and cement with 150 cu.

Perforate Dakota formation and Sand-water zone with 80,000# sand and 80,000 gals. water. Run 2 1/8" tubing

West one-half, 360 acres, Section 9 dedicated to well.

I understand that this plan of work must receive approval in writing by the Geological Survey before operations may be commenced.

Company **Artes Oil and Gas Company**
Denver 370
Address **Farmington, New Mexico**

By **Joe C. Salmon**
Title **District Superintendent**

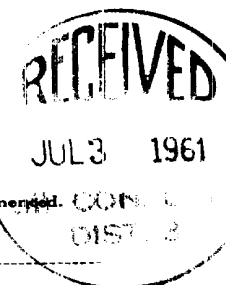

NEW MEXICO OIL CONSERVATION COMMISSION

Well Location and Acreage Dedication Plat

SECTION A.

Date **March 17, 1961**

Operator **Artec Oil and Gas Company** Lease **Whitley**
Well No. **7-D** Unit Letter **K** Section **9** Township **27N** Range **9W** NMPM
Located **1750** Feet From **South** Line, **1550** Feet From **West** Line
County **San Juan** G. L. Elevation **6197** Dedicated Acreage **320** Acres
Name of Producing Formation **Dakota** Pool **Basin**

1. Is the Operator the only owner* in the dedicated acreage outlined on the plat below? Yes ☒ No ☐
2. If the answer to question One is "No," have the interests of all the owners been consolidated by communitization agreement or otherwise? Yes ☐ No ☐ If answer is "Yes," Type of Consolidation _____
3. If the answer to question Two is "No," list all the owners and their respective interests below:

OWNER

LAND DESCRIPTION

SECTION B.

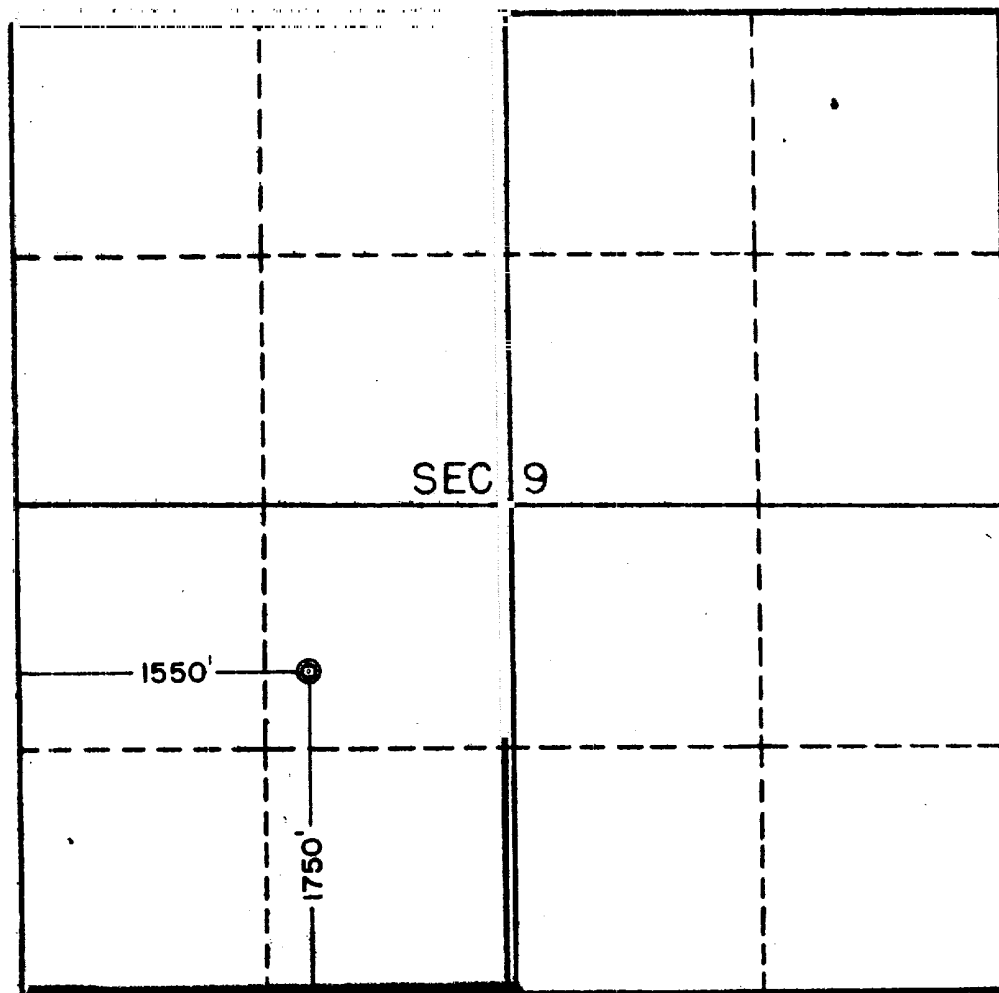

This is to certify that the information in Section A above is true and complete to the best of my knowledge and belief.

Artec Oil and Gas Company
(OPERATOR)

ORIGINAL SIGNED BY **JOE G. SALMON**
(REPRESENTATIVE)

Drawer 570, Farmington, N.M.
(ADDRESS)

This is to certify that the well location shown on the plat in Section B was plotted from field notes of actual surveys made by me or under my supervision and that the same is true and correct to the best of my knowledge and belief.

Date Surveyed **3-7-61**
Four States Engineering Co.
FARMINGTON, NEW MEXICO

J. L. Poter
REGISTERED ENGINEER OR
LAND SURVEYOR

Certificate No. **3084**



