

(SUBMIT IN TRIPLICATE)

UNITED STATES  
DEPARTMENT OF THE INTERIOR  
GEOLOGICAL SURVEY

Land Office Santa Fe  
Lease No. 077382  
Unit Letter L

JAN 14 1959

SUNDRY NOTICES AND REPORTS ON WELLS GEOLOGICAL SURVEY  
SANTA FE, NEW MEXICO

NOTICE OF INTENTION TO DRILL	<input checked="" type="checkbox"/>	SUBSEQUENT REPORT OF WATER SHUT-OFF	
NOTICE OF INTENTION TO CHANGE PLANS		SUBSEQUENT REPORT OF SHOOTING OR ACIDIZING	
NOTICE OF INTENTION TO TEST WATER SHUT-OFF		SUBSEQUENT REPORT OF ALTERING CASING	
NOTICE OF INTENTION TO RE-DRILL OR REPAIR WELL		SUBSEQUENT REPORT OF RE-DRILLING OR REPAIR	
NOTICE OF INTENTION TO SHOOT OR ACIDIZE		SUBSEQUENT REPORT OF ABANDONMENT	
NOTICE OF INTENTION TO PULL OR ALTER CASING		SUPPLEMENTARY WELL HISTORY	
NOTICE OF INTENTION TO ABANDON WELL			

(INDICATE ABOVE BY CHECK MARK NATURE OF REPORT, NOTICE, OR OTHER DATA)

January 9, 1959

Well No. 1 H is located 1630 ft. from S line and 870 ft. from W line of sec. 9

SW/4 Sec. 9 27N 10W NMPM  
(1/4 Sec. and Sec. No.) (Twp.) (Range) (Meridian)  
Angel Peak San Juan New Mexico  
(Field) (County or Subdivision) (State or Territory)

The elevation of the derrick floor above sea level is 6063 ft.

DETAILS OF WORK

(State names of and expected depths to objective sands; show sizes, weights, and lengths of proposed casings; indicate mudding jobs, cementing points, and all other important proposed work)

Well to be drilled into top of Morrison formation at approximately 6650' KB with rotary tools.

1. Set approx. 250' of 10 3/4" O.D. 32.75#, H-40 surface csg.
2. Drill into the Morrison formation using oil base mud.
3. Set approx. 6650' of 5 1/2" O.D., 15.5#, J-55 csg with cement staging. collars below the base of the Pictured Cliffs and the base of Gallup form.
4. Complete well as a Dakota gas well.
5. Expected tops:

Pictured Cliffs - 2100'  
Cliff House - 3400'  
Point Lookout - 4300'  
Mancoes - 4500'

Gallup - 5660'  
Tocito - 5970'  
Dakota - 6450'  
Morrison - 6630'



I understand that this plan of work must receive approval in writing by the Geological Survey before operations may be commenced.

Company Sunset International Petroleum Corporation

Address P. O. Box 1527

Denver, Colorado

By E. B. Mays

Title Division Production Manager



NEW MEXICO OIL CONSERVATION COMMISSION  
WELL LOCATION AND ACREAGE DEDICATION PLAT

FORM C-128  
Revised 5/1/57

SEE INSTRUCTIONS FOR COMPLETING THIS FORM ON THE REVERSE SIDE

SECTION A

Operator SUNSET INTERNATIONAL PETROLEUM CORP.		Lease Santa Fe 077382		Well No. 1-H
Unit Letter L	Section 9	Township 27 NORTH	Range 10 WEST	County SAN JUAN
Actual Footage Location of Well: 1830 feet from the SOUTH line and 870 feet from the WEST line				
Ground Level Elev. 6050.5	Producing Formation Dakota	Pool Angel Peak Dist. 3	Dedicated Acreage: 160 Acres	

1. Is the Operator the only owner in the dedicated acreage outlined on the plat below? YES ☒ NO \_\_\_\_ . ("Owner" means the person who has the right to drill into and to produce from any pool and to appropriate the production either for himself or for himself and another. (65-3-29 (e) NMSA 1935 Comp.)
2. If the answer to question one is "no," have the interests of all the owners been consolidated by communitization agreement or otherwise? YES \_\_\_\_ NO \_\_\_\_ . If answer is "yes," Type of Consolidation \_\_\_\_
3. If the answer to question two is "no," list all the owners and their respective interests below:

Owner	Land Description
	JAN 14 1959
	GEOLOGICAL SURVEY SANTA FE, NEW MEXICO

SECTION B

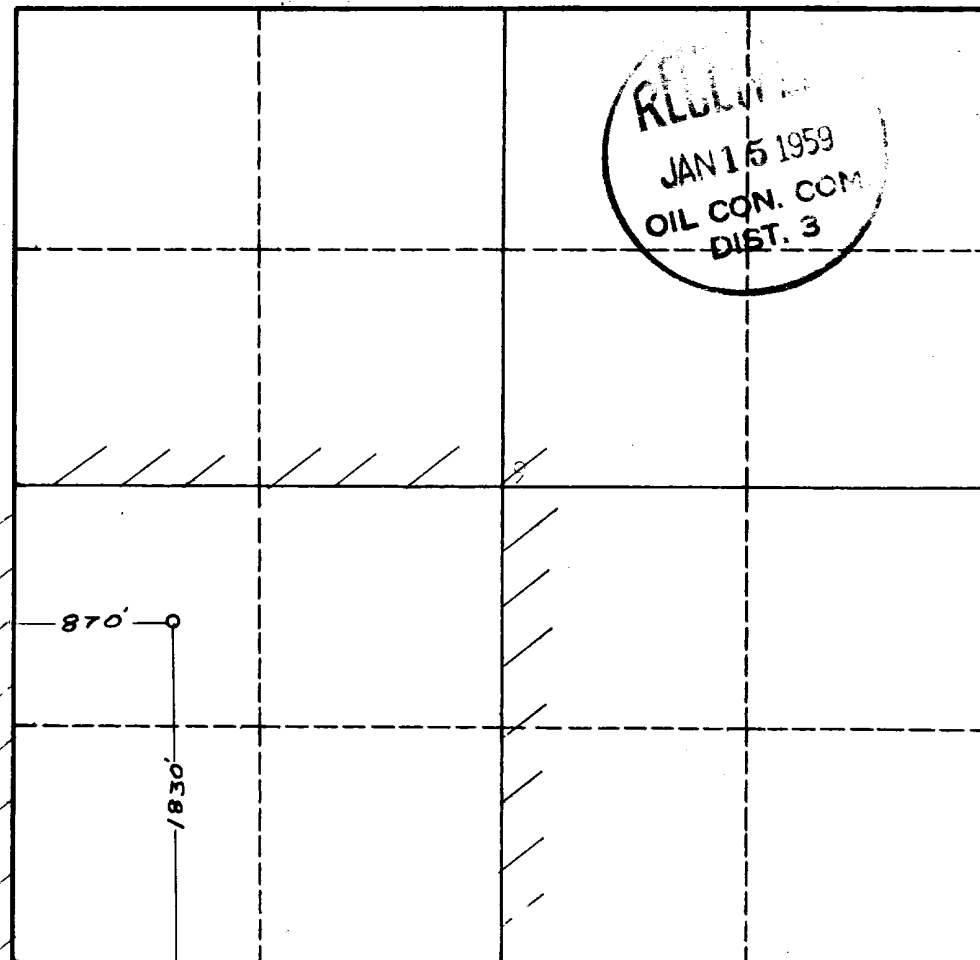

CERTIFICATION

I hereby certify that the information in SECTION A above is true and complete to the best of my knowledge and belief.

Name E. B. Mays  
Position Div. Production Mgr.  
Company Sunset International Pet. Corp.  
Date January 8, 1959

I hereby certify that the well location shown on the plat in SECTION B was plotted from field notes of actual surveys made by me or under my supervision, and that the same is true and correct to the best of my knowledge and belief.

Date Surveyed 3 January 1959  
Registered Professional Engineer and/or Land Surveyor James P. Leese  
Certificate No. 1463

## INSTRUCTIONS FOR COMPLETION OF FORM C-128

1. Operator shall furnish and certify to the information called for in Section A.
2. Operator shall outline the dedicated acreage for *both* oil and gas wells on the plat in Section B.
3. A registered professional engineer or land surveyor registered in the State of New Mexico or approved by the Commission shall show on the plat the location of the well and certify this information in the space provided.
4. All distances shown on the plat must be from the outer boundaries of the Section.
5. If additional space is needed for listing owners and their respective interests as required in question 3 of Section A, please use space below.

--	--	--