

NUMBER OF COPIES RECEIVED	
DISTRIBUTION	
SANTA FE	
FILE	
U.S.G.S	
LAND OFFICE	
TRANSPORTER	OIL GAS
PRODUCTION OFFICE	
OPERATOR	

NEW MEXICO OIL CONSERVATION COMMISSION
WELL LOCATION AND ACREAGE DEDICATION PLAT
 SEE INSTRUCTIONS FOR COMPLETING THIS FORM ON THE REVERSE SIDE

FORM C-128
 Revised 5/1/57

SECTION A

Operator SOUTHWEST PRODUCTION COMPANY		Lease 57-079116 EDGAR - FEDERAL		Well No. 1
Unit Letter G.	Section 12	Township 27 NORTH	Range 12 WEST	County SAN JUAN
Actual Footage Location of Well: 1650 feet from the NORTH line and 1650 feet from the EAST line				
Ground Level Elev. 6065.0	Producing Formation DAKOTA	Pool Undesignated		Dedicated Acreage: ** N/320 Acres

Ref: CIO plat dated 19 July 1915

1. Is the Operator the only owner in the dedicated acreage outlined on the plat below? YES ☒ NO ____ . ("Owner" means the person who has the right to drill into and to produce from any pool and to appropriate the production either for himself or for himself and another. (65-3-29 (e) NMSA 1935 Comp.)
2. If the answer to question one is "no," have the interests of all the owners been consolidated by community agreement or otherwise? YES ____ NO ____ . If answer is "yes," Type of Consolidation ____
3. If the answer to question two is "no," list all the owners and their respective interests below:

Owner	Land Description

SECTION B

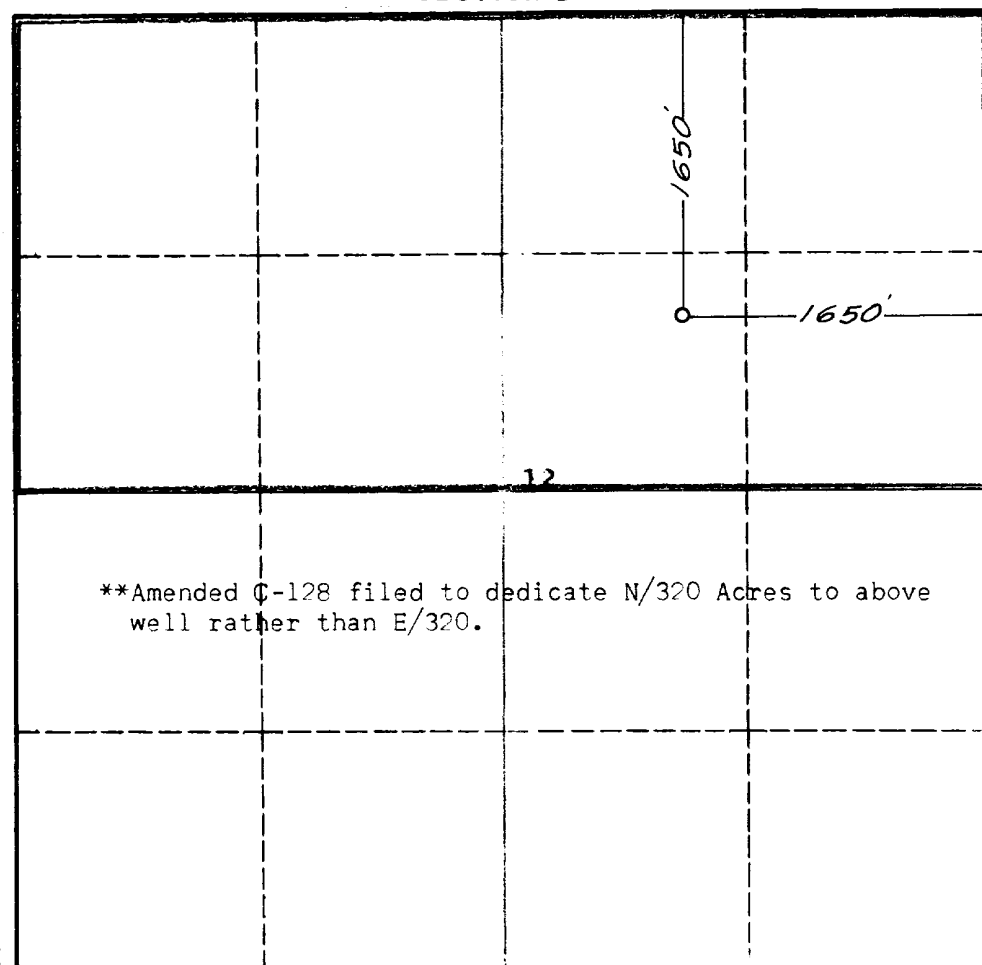

CERTIFICATION

I hereby certify that the information in SECTION A above is true and complete to the best of my knowledge and belief.

Name	Original signed by Carl W. Smith
Position	PRODUCTION SUPERINTENDENT
Company	Southwest Production Co.
Date	9/8/60

I hereby certify that the well location shown on the plat in SECTION B was plotted from field notes of actual surveys made by me or under my supervision, and that the same is true and correct to the best of my knowledge and belief.

Date Surveyed	5 September 1960
Registered Professional Engineer and/or Land Surveyor	<i>James P. Leese</i> James P. Leese
Certificate No.	1463

0 330 660 990 1320 1650 1980 2310 2640 2000 1500 1000 500 0

INSTRUCTIONS FOR COMPLETION OF FORM C-128

1. Operator shall furnish and certify to the information called for in Section A.
2. Operator shall outline the dedicated acreage for *both* oil and gas wells on the plat in Section B.
3. A registered professional engineer or land surveyor registered in the State of New Mexico or approved by the Commission shall show on the plat the location of the well and certify this information in the space provided.
4. All distances shown on the plat must be from the outer boundaries of the Section.
5. If additional space is needed for listing owners and their respective interests as required in question 3 of Section A, please use space below.

STATE OF NEW MEXICO	
OIL CONSERVATION COMMISSION	
ALBUQUERQUE DISTRICT OFFICE	
NUMBER OF COPIES RECEIVED	
BY DISTRIBUTION	
DATE	
TIME	
BY	
RECEIVED OFFICE	
TRANSPORTER	OIL
	GAS
REGISTRATION OFFICE	
OPERATOR	