

(SUBMIT IN TRIPLICATE)

UNITED STATES
DEPARTMENT OF THE INTERIOR
GEOLOGICAL SURVEYLand Office Santa FeLease No. S. F. 078357Unit Marshall, N. M.

SUNDRY NOTICES AND REPORTS ON WELLS

NOTICE OF INTENTION TO DRILL.....	<u>1</u>	SUBSEQUENT REPORT OF WATER SHUT-OFF.....	
NOTICE OF INTENTION TO CHANGE PLANS.....		SUBSEQUENT REPORT OF SHOOTING OR ACIDIZING.....	
NOTICE OF INTENTION TO TEST WATER SHUT-OFF.....		SUBSEQUENT REPORT OF ALTERING CASING.....	
NOTICE OF INTENTION TO RE-DRILL OR REPAIR WELL.....		SUBSEQUENT REPORT OF REDRILLING OR REPAIR.....	
NOTICE OF INTENTION TO SHOOT OR ACIDIZE.....		SUBSEQUENT REPORT OF ABANDONMENT.....	
NOTICE OF INTENTION TO PULL OR ALTER CASING.....		SUPPLEMENTARY WELL HISTORY.....	
NOTICE OF INTENTION TO ABANDON WELL.....			

(INDICATE ABOVE BY CHECK MARK NATURE OF REPORT, NOTICE, OR OTHER DATA)

January 15, 1953Well No. 1 is located 450 ft. from N line and 1650 ft. from E line of sec. 1

SW/4 Section 1 (1/4 Sec. and Sec. No.) T7S (Twp.) 46E (Range) 4N (Meridian)
Falcher (Field) Santa Fe County (County or Subdivision) New Mexico (State or Territory)

The elevation of the derrick floor above sea level is ft.

DETAILS OF WORK

(State names of and expected depths to objective sands; show sizes, weights, and lengths of proposed casings; indicate mudding jobs, cementing points, and all other important proposed work)

It is our intention to drill well No. 1 on the above described property to an approximate depth of 2300' to test the Pictured Cliffs formation.

Casing program is as follows:

200' of 13-3/8" OD 48# H-40 to be cemented with 150 sacks of regular cement.
 2000' of 7" OD 23.5# J-55 to be cemented with 200 sacks of regular cement.

SW/4 Section 1 is the designated drilling unit.

I understand that this plan of work must receive approval in writing by the Geological Survey before operations may be commenced.

Company Kelly Oil CompanyAddress Box 426Arington, New MexicoBy J. E. CooperTitle District Foreman

Company.....Skelly Oil Company.....

Lease.....Well No.....

Sec.....1....., T.....27 N....., R.....9 W....., N.M.P.M.....

Location.....990' from the South line and 1650' from the West line.

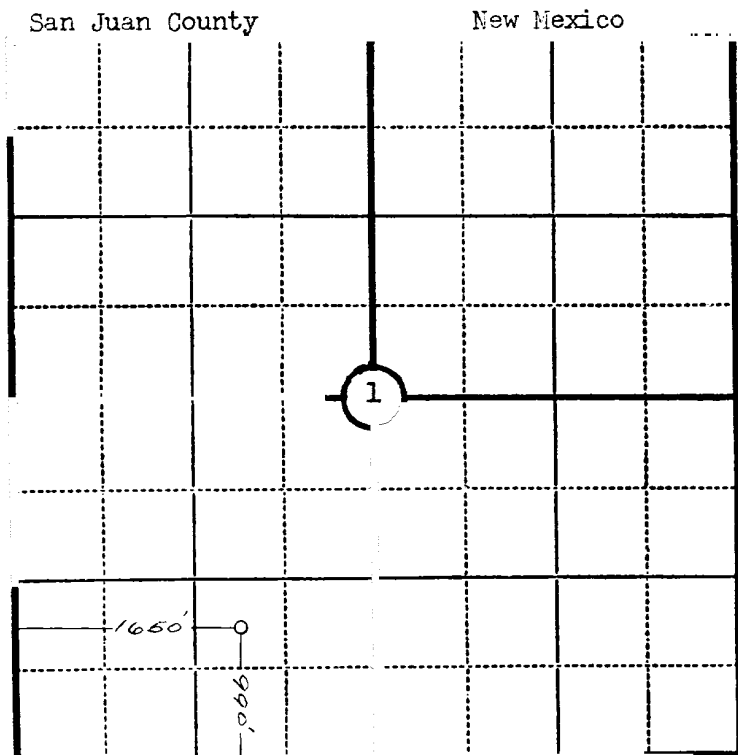

Scale—4 inches equal 1 mile.

This is to certify that the above plat was prepared from field notes of actual surveys made by me or under my supervision and that the same are true and correct to the best of my knowledge and belief.

Charles J. Finklea

Seal:

Registered Professional
Engineer and Land Surveyor.

Charles J. Finklea
N. Mex. Reg. No. 1302



SurveyedJanuary 9....., 1953