

Company James D. Hancock & Co., Ltd.

Lease Hancock SF-079116 Well No. 9

Sec. 1 T. 27 N., R. 12 W., N.M.P.M.

Location 1650' from the South line and 990' from  
the East line.



San Juan County

New Mexico

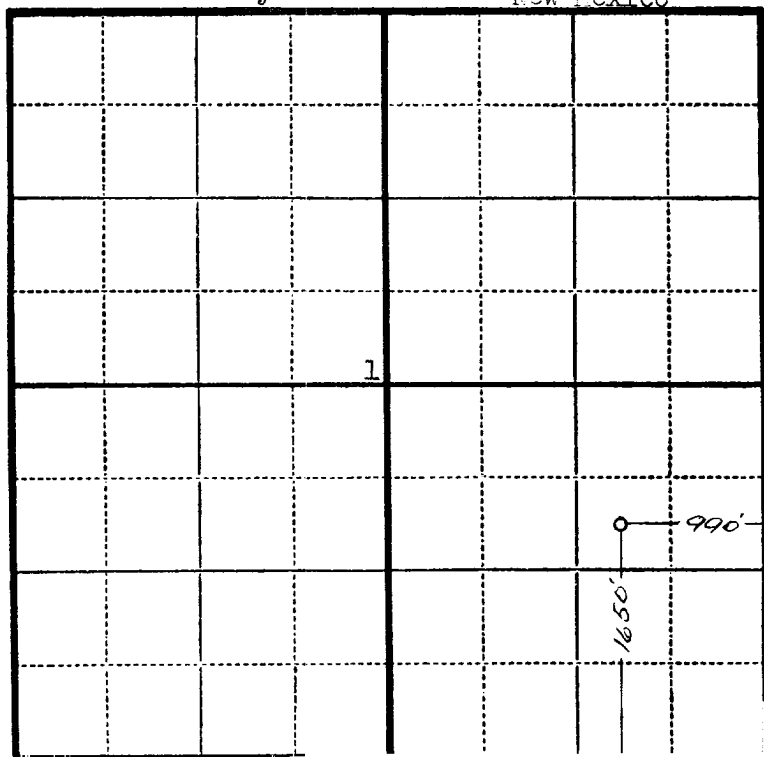

Scale—4 inches equals 1 mile.

This is to certify that the above plat was prepared from field notes of actual surveys made by me or under my supervision and that the same are true and correct to the best of my knowledge and belief.

*Charles J. Finklea*

Seal:

Registered Professional Charles J. Finklea  
Engineer and Land Surveyor N. Mex. Reg. No. 1302

Surveyed March 16, 1952