

District I  
P O Box 1980 Hobbs NM

District II  
P O Drawer DD Artesia NM 88221

District III  
1000 Rio Brazos Rd. Aztec, NM 87410

State of New Mexico  
Energy, Minerals and Natural Resources Department

OIL CONSERVATION DIVISION

2040 South Pacheco Street  
Santa Fe, New Mexico 87505

SUBMIT 1 COPY TO  
APPROPRIATE  
DISTRICT OFFICE  
AND 1 COPY TO  
SANTA FE OFFICE

PIT REMEDIATION AND CLOSURE REPORT

RECEIVED  
NOV - 1 1999

OIL CON. DIV.  
DIST. 3

Operator:	PNM Gas Services ( Cross Timbers )		Telephone:	324-3764	
Address:	603 W. Elm Street Farmington, NM 87401				
Facility or Well Name:	Fred Feasel G #1				
Location:	Unit	K	Sec	2	T 27 N R 10 W County San Juan
Pit Type:	Separator		Dehydrator	<input checked="" type="checkbox"/>	Other
Land Type:	BLM	<input checked="" type="checkbox"/>	State		Fee Other
Pit Location:	Pit dimensions:	length	15 '	width	15 ' depth 3 '
(Attach diagram)	Reference:	wellhead	<input checked="" type="checkbox"/>	other	
	Footage from reference:	197'			
	Direction from reference:	52	Degrees	<input checked="" type="checkbox"/> East	North <input checked="" type="checkbox"/>
				West	South
Depth to Ground Water:	Less than 50 feet (20 points)				
	50 feet to 99 feet (10 points)				
(Vertical distance from contaminants to seasonal high water elevation of ground water)	Greater than 100 feet (0 points)		0		
Wellhead Protection Area:	Yes (20 points)				
(Less than 200 feet from a private domestic water source, or, less than 1,000 feet from all other water sources)	No (0 points)		0		
Distance to Surface Water:	Less than 200 feet (20 points)				
	200 feet to 1,000 feet (10 points)				
(Horizontal distance to perennial lakes, ponds, rivers, streams, creeks, irrigation canals and ditches)	Greater than 1,000 feet (0 points)		0		
RANKING SCORE (TOTAL POINTS):					0

Fred Feasel G #1

Date Remediation Started: 07/08/1999

Date Completed: 07/08/1999

Remediation Method: Excavation ☒

Approx. Cubic Yard 321

(Check all appropriate sections)

Landfarmed ☒

Amount Landfarmed (cubic yds) 200

Other 121 cu yds overburden

Remediation Location:

Onsite

☒

Offsite

(i.e., landfarmed onsite, name and location of offsite facility)

Backfill Material Location:

General Description of Remedial Action:

Excavated contaminated soil to a pit size of 25.5' X 17' X 20' and landfarmed soil onsite within a bermed area at a depth of 6" to 12". Soil was aerated by disking/plowing until soil met regulatory levels.

Ground Water Encountered:

No

☒

Yes

Depth

Final Pit Closure Sampling:

Sample Location

5 pt. composite - bottom.

(if multiple samples, attach sample result and diagram of sample locations and depths.)

Sample depth

20'

Sample date

07/08/1999

Sample time

10:30:00 AM

Sample Results

Benzene (ppm) < 0.25

Total BTEX (ppm) 32.2

Field headspace (ppm)

TPH (ppm)

130.00

Method

8015B

Vertical Extent (ft)

Risk Analysis form attached Yes

No

☒

Ground Water Sample:

Yes

No

☒

(If yes, see attached Groundwater Site Summary Report)

I HEREBY CERTIFY THAT THE INFORMATION ABOVE IS TRUE AND COMPLETE TO THE BEST OF MY KNOWLEDGE AND MY BELIEF

DATE October 28, 1999

PRINTED NAME Maureen Gannon  
AND TITLE Project Manager

SIGNATURE

*Maureen Gannon*

Fred Farrell L<sup>y</sup>#1  
 (K) 2-27N-10W  
 Cross Timbers  
 7-6-94 @ 0815  
 52° E & N

11  
 N

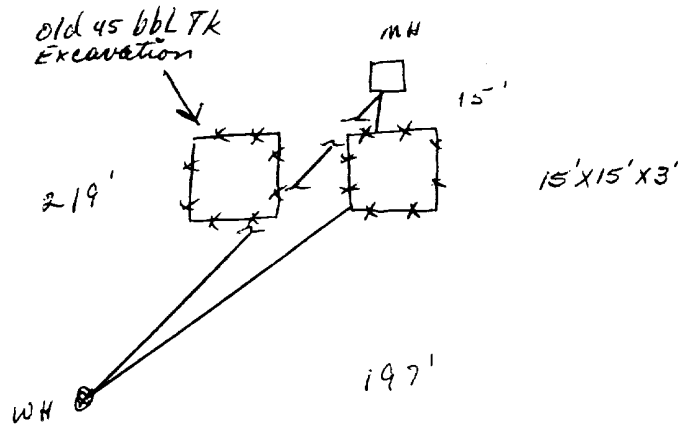

□ 54



### Excavation Sampling

#### PID Readings

5' - 2783 ppm  
 10' - 1582 ppm  
 15' - 2844 ppm  
 20' - 1342 ppm

25.5' (N+S) x 171' (E+W) x 20' (D)  
 Field headspace: 300 ppm (walls)

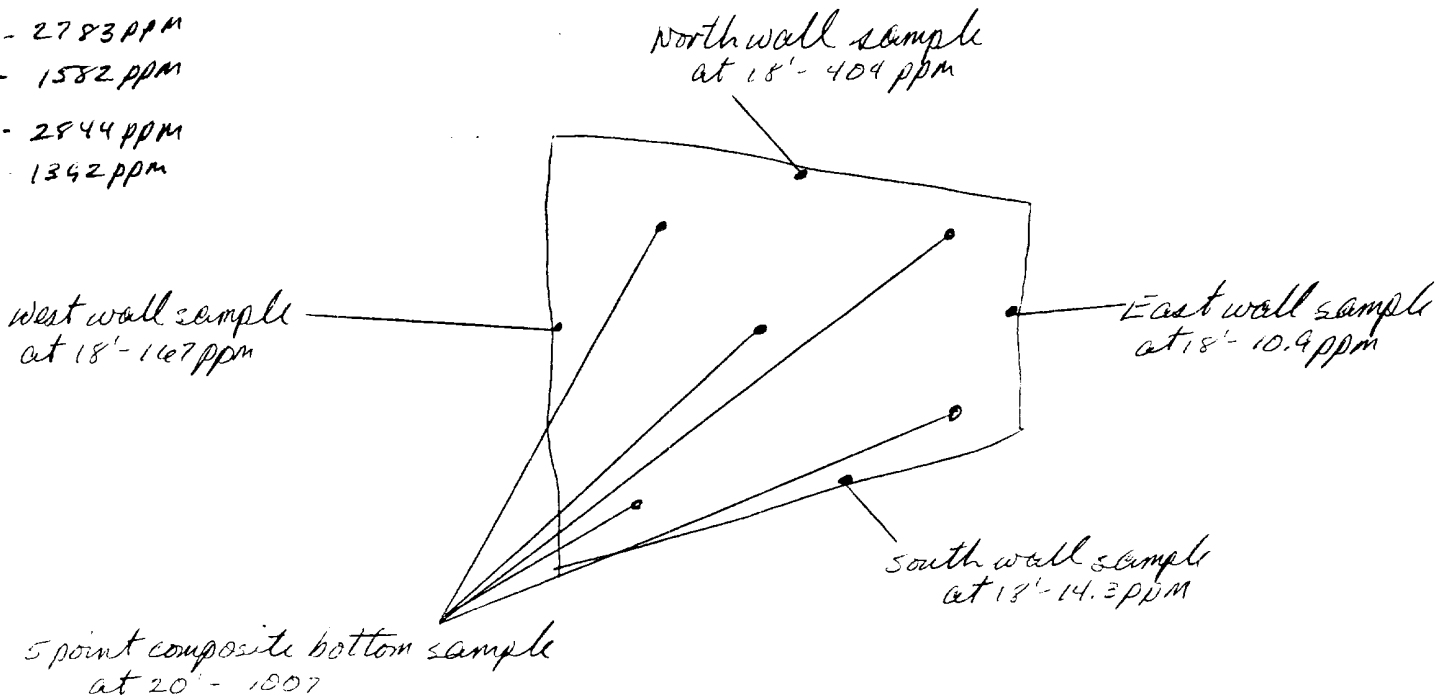

not to scale

OFF: (505) 325-5667



LAB: (505) 325-1556

**On Site Technologies, LTD.**

**Date:** 23-Jul-99

---

**CLIENT:** PNM - Public Service Company of NM  
**Project:** Fred Feasel G1, G1 Drip & G1E  
**Lab Order:** 9907019

---

## **CASE NARRATIVE**

Samples were analyzed using the methods outlined in the following references:

Test Methods for Evaluating Solid Waste, Physical/Chemical Methods, SW846, 3rd Edition

All method blanks, laboratory spikes, and/or matrix spikes met quality assurance objectives.

OFF: (505) 325-5667



Ray

LAB: (505) 325-1556

## ANALYTICAL REPORT

Date: 23-Jul-99

<b>Client:</b>	PNM - Public Service Company of NM	<b>Client Sample Info:</b>	Fred Feasel G#1
<b>Work Order:</b>	9907019	<b>Client Sample ID:</b>	9907081030; 5pt Bottom Comp
<b>Lab ID:</b>	9907019-01A	<b>Matrix:</b>	SOIL
<b>Project:</b>	Fred Feasel G1, G1 Drip & G1E	<b>Collection Date:</b>	7/8/99 10:30:00 AM
		<b>COC Record:</b>	7646

Parameter	Result	PQL	Qual	Units	DF	Date Analyzed
<b>DIESEL RANGE ORGANICS</b>		<b>SW8015B</b>				Analyst: DC
T/R Hydrocarbons: C10-C28	130	25		mg/Kg	1	7/21/99
<b>AROMATIC VOLATILES BY GC/PID</b>		<b>SW8021B</b>				Analyst: DC
Benzene	ND	250		µg/Kg	250	7/12/99
Toluene	4200	500		µg/Kg	250	7/12/99
Ethylbenzene	2500	250		µg/Kg	250	7/12/99
m,p-Xylene	20000	500		µg/Kg	250	7/12/99
o-Xylene	5500	250		µg/Kg	250	7/12/99

32200  
32.20 ppm

**Qualifiers:**

PQL - Practical Quantitation Limit

ND - Not Detected at Practical Quantitation Limit

J - Analyte detected below Practical Quantitation Limit

B - Analyte detected in the associated Method Blank

S - Spike Recovery outside accepted recovery limits

R - RPD outside accepted recovery limits

E - Value above quantitation range

Surr: - Surrogate

1 of 1

OFF: (505) 325-5667



LAB: (505) 325-1556

## ANALYTICAL REPORT

Date: 23-Jul-99

<b>Client:</b>	PNM - Public Service Company of NM	<b>Client Sample Info:</b>	Fred Feasel G#1
<b>Work Order:</b>	9907019	<b>Client Sample ID:</b>	9907081035; 4 Wall Comp
<b>Lab ID:</b>	9907019-02A	<b>Matrix:</b>	SOIL
<b>Project:</b>	Fred Feasel G1, G1 Drip & G1E	<b>Collection Date:</b>	7/8/99 10:35:00 AM
		<b>COC Record:</b>	7646

Parameter	Result	PQL	Qual	Units	DF	Date Analyzed
<b>DIESEL RANGE ORGANICS</b>		<b>SW8015B</b>				Analyst: DC
T/R Hydrocarbons: C10-C28	72	25		mg/Kg	1	7/21/99

**Qualifiers:**

PQL - Practical Quantitation Limit

ND - Not Detected at Practical Quantitation Limit

J - Analyte detected below Practical Quantitation Limit

B - Analyte detected in the associated Method Blank

S - Spike Recovery outside accepted recovery limits

R - RPD outside accepted recovery limits

E - Value above quantitation range

Surr: - Surrogate

1 of 1

Fred Feasel G #1  
Sec-2 T-27N R-10W 44-K  
Cross Timbers

# Landfarm Drawing

App 200 cu. yds

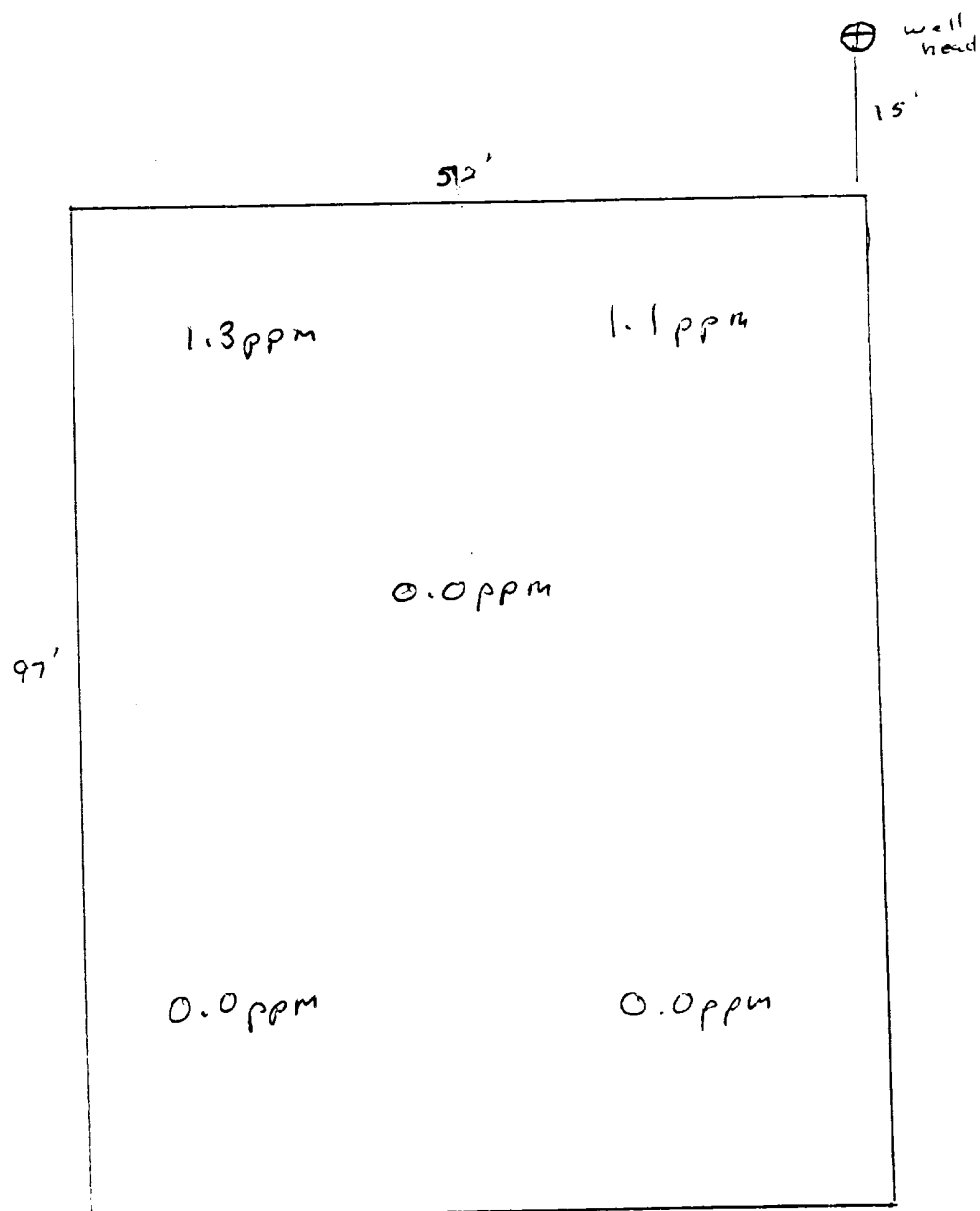

2" to 12" Depth  
Headspace 1.8 ppm  
Sample # 9908061205

Not to Scale

OFF: (505) 325-5667



LAB: (505) 325-1556

**On Site Technologies, LTD.**

**Date:** 11-Aug-99

---

**CLIENT:** PNM - Public Service Company of NM  
**Project:** PNM Pit Remediation Landfarms  
**Lab Order:** 9908017

---

**CASE NARRATIVE**

Samples were analyzed using the methods outlined in the following references:

Test Methods for Evaluating Solid Waste, Physical/Chemical Methods, SW846, 3rd Edition

All method blanks, laboratory spikes, and/or matrix spikes met quality assurance objectives.



OFF: (505) 325-5667



LAB: (505) 325-1556

## ANALYTICAL REPORT

Date: 11-Aug-99

<b>Client:</b>	PNM - Public Service Company of NM	<b>Client Sample Info:</b>	Fred Feasel G-1 LF
<b>Work Order:</b>	9908017	<b>Client Sample ID:</b>	9908061205; 5pt. Composite
<b>Lab ID:</b>	9908017-03A	<b>Matrix:</b>	SOIL
<b>Project:</b>	PNM Pit Remediation Landfarms	<b>Collection Date:</b>	08/06/1999 12:05:00 PM
		<b>COC Record:</b>	7801

Parameter	Result	PQL	Qual	Units	DF	Date Analyzed
<b>DIESEL RANGE ORGANICS</b>		<b>SW8015B</b>				Analyst: DC
T/R Hydrocarbons: C10-C28	28	25		mg/Kg	1	08/09/1999

**Qualifiers:**

PQL - Practical Quantitation Limit  
ND - Not Detected at Practical Quantitation Limit  
J - Analyte detected below Practical Quantitation Limit  
B - Analyte detected in the associated Method Blank

S - Spike Recovery outside accepted recovery limits  
R - RPD outside accepted recovery limits  
E - Value above quantitation range  
Surr: - Surrogate

1 of 1

P.O. BOX 2606 • FARMINGTON, NM 87499