

(SUBMIT IN TRIPLICATE)

UNITED STATES
DEPARTMENT OF THE INTERIOR
GEOLOGICAL SURVEY

Indian Agency _____
Nava jo _____
Allottee _____
Lease No. 1-89-IND-57

Sec. 4

SUNDRY NOTICES AND REPORTS ON WELLS

NOTICE OF INTENTION TO DRILL	<input checked="" type="checkbox"/>	SUBSEQUENT REPORT OF WATER SHUT-OFF	
NOTICE OF INTENTION TO CHANGE PLANS		SUBSEQUENT REPORT OF SHOOTING OR ACIDIZING	
NOTICE OF INTENTION TO TEST WATER SHUT-OFF		SUBSEQUENT REPORT OF ALTERING CASING	
NOTICE OF INTENTION TO REDRILL OR REPAIR WELL		SUBSEQUENT REPORT OF REDRILLING OR REPAIR	
NOTICE OF INTENTION TO SHOOT OR ACIDIZE		SUBSEQUENT REPORT OF ABANDONMENT	
NOTICE OF INTENTION TO PULL OR ALTER CASING		SUPPLEMENTARY WELL HISTORY	
NOTICE OF INTENTION TO ABANDON WELL			

RECEIVED
MAY 17 1962

(INDICATE ABOVE BY CHECK MARK NATURE OF REPORT, NOTICE, OR OTHER DATA)

U. S. GEOLOGICAL SURVEY
FARMINGTON, NEW MEXICO

May 16, 1962

Well No. 27 is located 2020ft. from [N] line and 1980 ft. from [W] line of sec. 4

SW/4 Sec. 4 T27N R17W NMPM
(1/4 Sec. and Sec. No.) (Twp.) (Range) (Meridian)
Table Mesa San Juan County New Mexico
(Field) (County or Subdivision) (State or Territory)

The elevation of the derrick floor above sea level is 5382 ft.

DETAILS OF WORK

(State names of and expected depths to objective sands; show sizes, weights, and lengths of proposed casings; indicate mudding jobs, cementing points, and all other important proposed work)

We propose to drill this well with rotary tools to an estimated depth of 1660' to test the Dakota formation. If commercial production is encountered a string of 5 1/2" O.D. production casing will be run to TD and cemented. The casing will be perforated and the well completed.

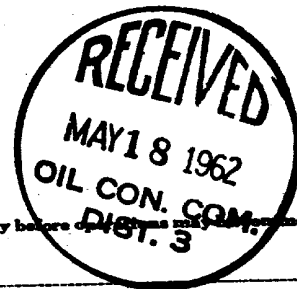

I understand that this plan of work must receive approval in writing by the Geological Survey before operations may be commenced.

Company Continental Oil Company

Address Box 3312

Durango, Colorado

By H. D. Haley
Title District Superintendent

NUMBER OF COPIES RECEIVED	
DISTRIBUTION	
SANTA FE	
FILE	
U.S.G.S.	
LAND OFFICE	
TRANSPORTER	OIL GAS
PRORATION OFFICE	
OPERATOR	

NEW MEXICO OIL CONSERVATION COMMISSION
WELL LOCATION AND ACREAGE DEDICATION PLAT
 SEE INSTRUCTIONS FOR COMPLETING THIS FORM ON THE REVERSE SIDE

FORM C-128
 Revised 5/1/57

SECTION A

Operator Continental Oil Company		Lease Table Mesa		Well No. 27
Unit Letter K	Section 4	Township 27N	Range 17W	County San Juan
Actual Footage Location of Well: 2020 feet from the South line and 1980 feet from the West line				
Ground Level Elev. 5372	Producing Formation Dakota	Pool Table Mesa Dakota	Dedicated Acreage: 40 Acres	

1. Is the Operator the only owner in the dedicated acreage outlined on the plat below? YES NO ____ . ("Owner" means the person who has the right to drill into and to produce from any pool and to appropriate the production either for himself or for himself and another. (65-3-29 (e) NMSA 1935 Comp.)
2. If the answer to question one is "no," have the interests of all the owners been consolidated by communitization agreement or otherwise? YES ____ NO ____ . If answer is "yes," Type of Consolidation _____
3. If the answer to question two is "no," list all the owners and their respective interests below:

Owner	Land Description

SECTION B

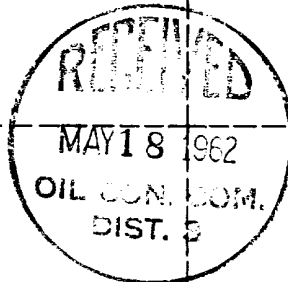
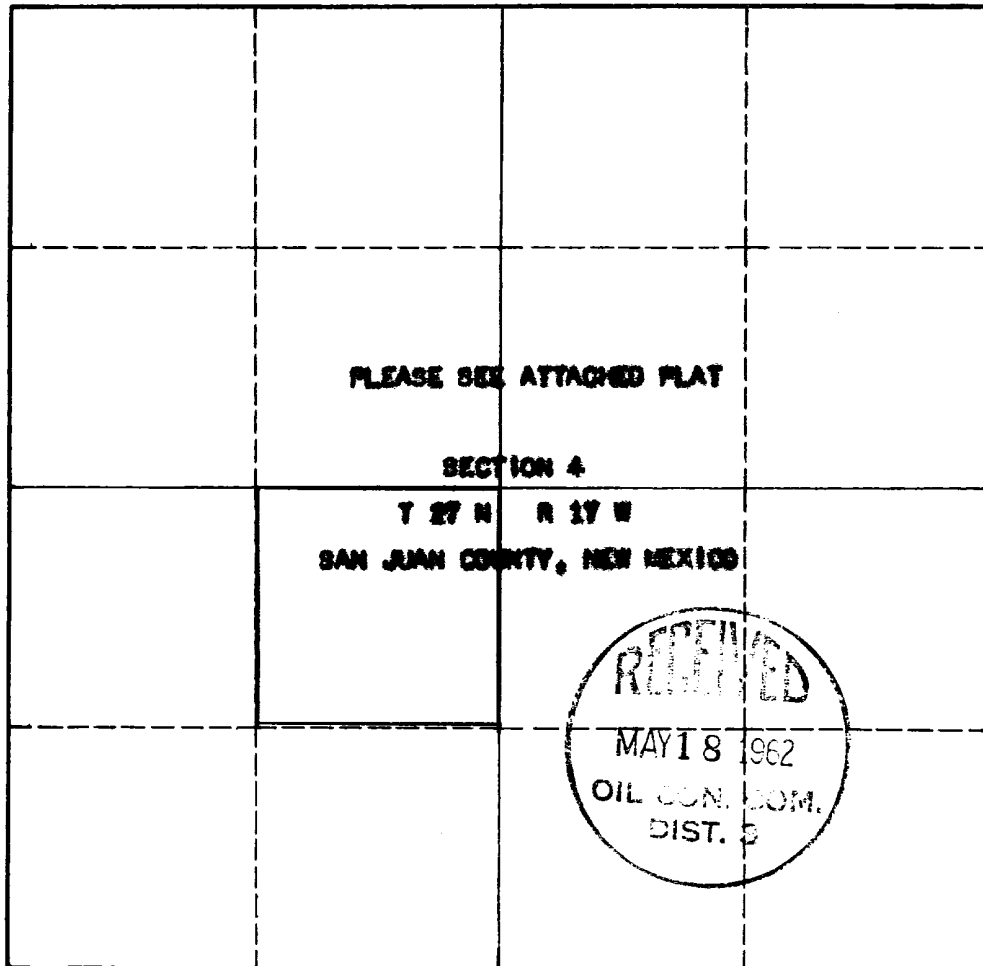

CERTIFICATION

I hereby certify that the information in SECTION A above is true and complete to the best of my knowledge and belief.

Name	<i>H. D. HALEY</i>
Position	District Superintendent
Company	Continental Oil Company
Date	5-16-62

I hereby certify that the well location shown on the plat in SECTION B was plotted from field notes of actual surveys made by me or under my supervision, and that the same is true and correct to the best of my knowledge and belief.

Date Surveyed	MAY 10, 1962
Registered Professional Engineer and/or Land Surveyor	<i>Johnson M. Clark</i>
Certificate No.	10100

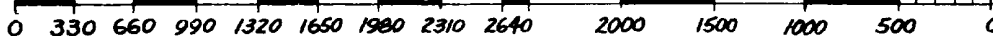

INSTRUCTIONS FOR COMPLETION OF FORM C-128

1. Operator shall furnish and certify to the information called for in Section A.
2. Operator shall outline the dedicated acreage for *both* oil and gas wells on the plat in Section B.
3. A registered professional engineer or land surveyor registered in the State of New Mexico or approved by the Commission shall show on the plat the location of the well and certify this information in the space provided.
4. All distances shown on the plat must be from the outer boundaries of the Section.
5. If additional space is needed for listing owners and their respective interests as required in question 3 of Section A, please use space below.

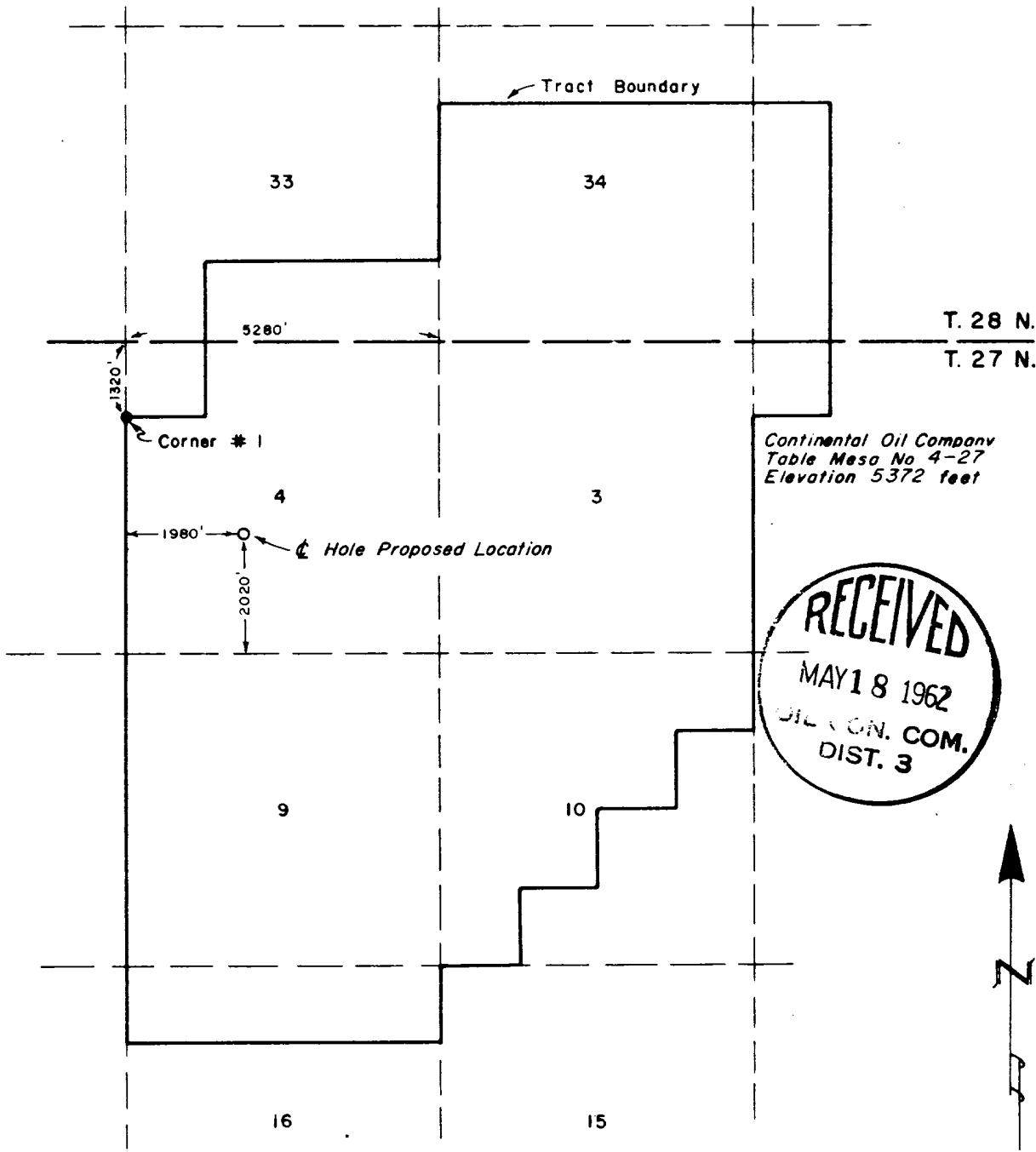

SCALE: 1" = 2640'

NOTE:
Section line projection based upon lease description and tract survey of November, 1950.

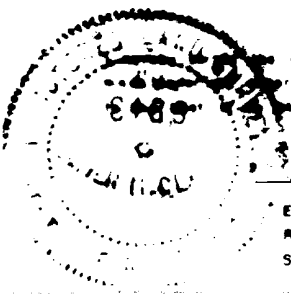

above plat represents a survey
revised and that it is accurate
knowledge and belief.

Elmer M. Clark

ELMER M. CLARK
Registered Land Surveyor
State of New Mexico (No 3189)

CONTINENTAL OIL CO.	
WELL LOCATION PLAT Sec. 4, T27N, R17W San Juan Co., New Mexico	
E. M. CLARK & ASSOC. Durango, Colorado	DATE: May 10, 1962 FILE NO: 62036