

COPY FOR
STATE OF NEW MEXICO
**OIL CONSERVATION
COMMISSION**
SUBMIT IN TRIPLICATE TO
DISTRICT OFFICE

**UNITED STATES
DEPARTMENT OF THE INTERIOR
GEOLOGICAL SURVEY**

Land Office Santa Fe
Lease No. 078902
Unit West Kutz Field

SUNDRY NOTICES AND REPORTS ON WELLS

NOTICE OF INTENTION TO DRILL.....	<input checked="" type="checkbox"/>	SUBSEQUENT REPORT OF WATER SHUT-OFF.....	
NOTICE OF INTENTION TO CHANGE PLANS.....		SUBSEQUENT REPORT OF SHOOTING OR ACIDIZING.....	
NOTICE OF INTENTION TO TEST WATER SHUT-OFF.....		SUBSEQUENT REPORT OF ALTERING CASING.....	
NOTICE OF INTENTION TO RE-DRILL OR REPAIR WELL.....		SUBSEQUENT REPORT OF REDRILLING OR REPAIR.....	
NOTICE OF INTENTION TO SHOOT OR ACIDIZE.....		SUBSEQUENT REPORT OF ABANDONMENT.....	
NOTICE OF INTENTION TO PULL OR ALTER CASING.....		SUPPLEMENTARY WELL HISTORY.....	
NOTICE OF INTENTION TO ABANDON WELL.....			

(INDICATE ABOVE BY CHECK MARK NATURE OF REPORT, NOTICE, OR OTHER DATA)

September 15, 1952

(Lilly)
Well No. 3 is located 1650 ft. from $\left\{ \begin{array}{l} N \\ S \end{array} \right\}$ line and 1650 ft. from $\left\{ \begin{array}{l} E \\ W \end{array} \right\}$ line of sec. 5
NE/4 Sec. 5 27N 12W NMPM
(1/4 Sec. and Sec. No.) (Twp.) (Range) (Meridian)
West Kutz San Juan New Mexico
(Field) (County or Subdivision) (State or Territory)

The elevation of the derrick floor above sea level is _____ ft. (Not available, will furnish later.)

DETAILS OF WORK

(State names of and expected depths to objective sands; show sizes, weights, and lengths of proposed casings; indicate muddling jobs, cementing points, and all other important proposed work)

Pictured Cliffs sand test. Estimated depth 1500'.

Surface Casing: 100' of 40# 9 5/8"-Cmented to the surface.
Production Casing: 1500' of 20# 6 5/8" - Cemented with 100 sacks.

If commercial production is indicated, the producing section will be shot with nitroglycerin.

I understand that this plan of work must receive approval in writing by the Geological Survey before operations may be commenced.

Company BENSON AND MONTIN
Address 815 1/2 West Main St.
Farmington, New Mexico
By Albert R. Greer,
Title Field, Sup't.

Company Denson-Montin

Lease _____ Well No. 3 Lilly

Sec. 5 T. 27 N., R. 12 W., N.M.P.M.

Location 1650' from the North line and 1650' from the East line.

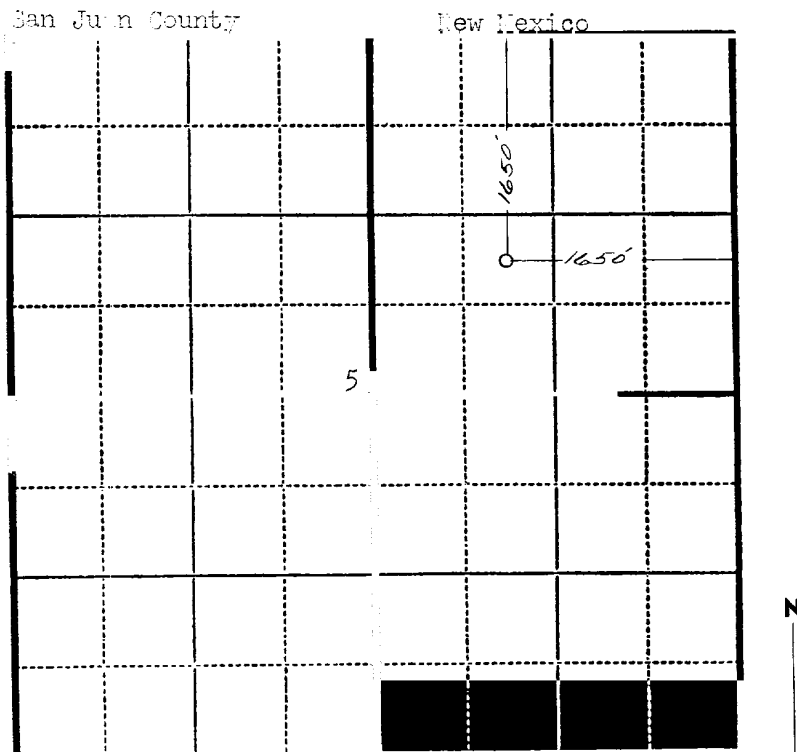

Scale—4 inches equals 1 mile.

This is to certify that the above plat was prepared from field notes of actual surveys made by me or under my supervision and that the same are true and correct to the best of my knowledge and belief.

Charles J. Finklea

Seal:

Registered Professional
Engineer and Land Surveyor.

Charles J. Finklea
N. Mex. Reg. No. 1302

Surveyed April 21, 19 52