

(SUBMIT IN TRIPLICATE)

Land Office Santa Fe.

Lease No. SE 046563

Unit _____

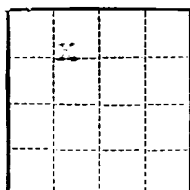

UNITED STATES
DEPARTMENT OF THE INTERIOR
GEOLOGICAL SURVEY



SUNDRY NOTICES AND REPORTS ON WELLS

NOTICE OF INTENTION TO DRILL	<input checked="" type="checkbox"/>	SUBSEQUENT REPORT OF WATER SHUT-OFF	
NOTICE OF INTENTION TO CHANGE PLANS		SUBSEQUENT REPORT OF SHOOTING OR ACIDIZING	
NOTICE OF INTENTION TO TEST WATER SHUT-OFF		SUBSEQUENT REPORT OF ALTERING CASING	
NOTICE OF INTENTION TO RE-DRILL OR REPAIR WELL		SUBSEQUENT REPORT OF RE-DRILLING OR REPAIR	
NOTICE OF INTENTION TO SHOOT OR ACIDIZE		SUBSEQUENT REPORT OF ABANDONMENT	
NOTICE OF INTENTION TO PULL OR ALTER CASING		SUPPLEMENTARY WELL HISTORY	
NOTICE OF INTENTION TO ABANDON WELL			

(INDICATE ABOVE BY CHECK MARK NATURE OF REPORT, NOTICE, OR OTHER DATA)

February 26, 1965

Astoc
Well No. 1 is located 112ft. from N line and 990 ft. from E line of sec. 2

NW Section 2 27N 10W N100M
(1/4 Sec. and 1/4 Sec. No.) (Twp.) (Range) (Meridian)
Basin Dakota-Kutz San Juan New Mexico
(Field) (County or Subdivision) (State or Territory)

The elevation of the derrick floor above sea level is 5929 ft.

DETAILS OF WORK

(State names of and expected depths to objective sands; show sizes, weights, and lengths of proposed casings, indicating points, and all other important proposed work)

Intend to drill to 6470 to Dakota with rotary tools.

1. Set 9-5/8" 32# H-40 at 250' KB
2. Drill to 6470'
3. Set 5-1/2" 17# J-55 from surface to TD
4. Complete well as a Dakota gas well.
5. Expected formation tops.

Base Picture Cliff - 3995
Point Outlook - 1725
Mancos - 1565
Niobrara - 545

Gallop - 400
Tocito - 150
Greenhorn - 245
4th B. Dakota - 490
T.D. - 340

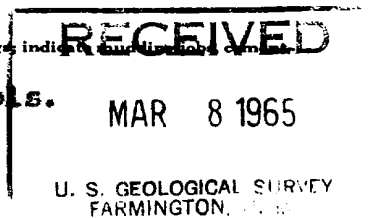

I understand that this plan of work must receive approval in writing by the Geological Survey before operations may be commenced.

Company Sunset International Petroleum Corporation

Address 201 Wall Bldg. Suite 308

Midland, Texas

By Robert W. Arrandiell

Title Production Manager
West Texas Division

NEW MEXICO OIL CONSERVATION COMMISSION

Well Location and Acreage Dedication Plat

SECTION A.

Date **March 2, 1965**

Operator **Sunset International Petroleum Corp.** Lease **AZTEC**
Well No. **1** Unit Letter **D** Section **2** Township **27 North** Range **10 West** NMPM
Located **1190** Feet From **North** Line, **990** Feet From **West** Line
County **San Juan** G. L. Elevation **5919** Dedicated Acreage **N/2 Section 2** Acres **322.64**
Name of Producing Formation **Dakota** Pool **Basin Dakota**

1. Is the Operator the only owner* in the dedicated acreage outlined on the plat below? Yes ☐ No ☒
2. If the answer to question One is "No," have the interests of all the owners been consolidated by a written agreement or otherwise? Yes ☒ No ☐ If answer is "Yes," Type of Consolidation **Consolidation**

3. If the answer to question Two is "No," list all the owners and their respective interests below:
- | OWNER | LAND DESCRIPTION |
|---|---|
| Sunset International Petroleum Corporation | Lots 3 & 4 and S/2 NW/4 and S/2 NE/4 Section 2 |
| Aztec Oil & Gas Company | Lots 1 & 2 Section 2 |

SECTION B.

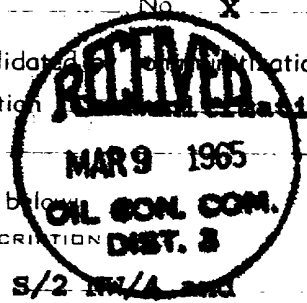
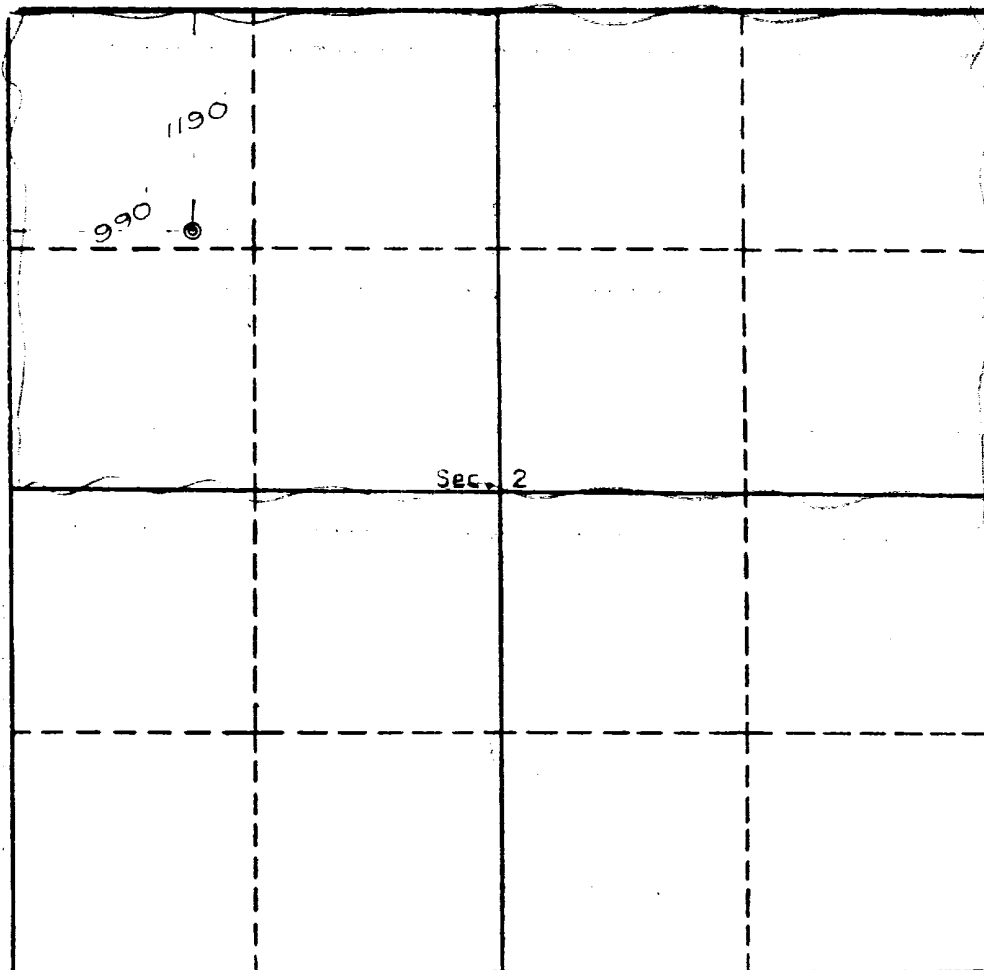

RECEIVED

MAR 8 1965

This is to certify that the information in Section A is true and complete to the best of my knowledge and belief.

Sunset International Pet, Co
(OPERATOR)

R. W. Arndt

R. W. Arndt
(REPRESENTATIVE)

West Texas Division
201 Wall Bldg. Suite 308,
Midland, Texas
(ADDRESS)

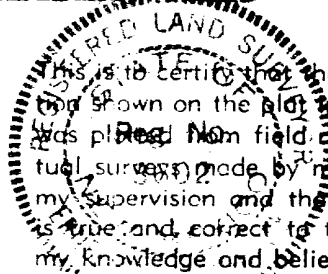

Date Surveyed **Nov. 21, 1964**

Four States Engineering Co.
FARMINGTON, NEW MEXICO

Earl W. Edwards
REGISTERED ENGINEER OR
LAND SURVEYOR

Certificate No. **3602**

