

(SUBMIT IN TRIPLICATE)

UNITED STATES  
DEPARTMENT OF THE INTERIOR  
GEOLOGICAL SURVEY

Land Office Santa Fe  
Lease No. 87 07306  
Unit \_\_\_\_\_

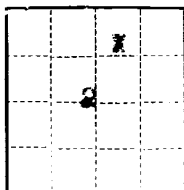

## SUNDRY NOTICES AND REPORTS ON WELLS

NOTICE OF INTENTION TO DRILL _____	<input checked="" type="checkbox"/>	SUBSEQUENT REPORT OF WATER SHUT-OFF _____	
NOTICE OF INTENTION TO CHANGE PLANS _____		SUBSEQUENT REPORT OF SHOOTING OR ACIDIZING _____	
NOTICE OF INTENTION TO TEST WATER SHUT-OFF _____		SUBSEQUENT REPORT OF ALTERING CASING _____	
NOTICE OF INTENTION TO RE-DRILL OR REPAIR WELL _____		SUBSEQUENT REPORT OF RE-DRILLING OR REPAIR _____	
NOTICE OF INTENTION TO SHOOT OR ACIDIZE _____		SUBSEQUENT REPORT OF ABANDONMENT _____	
NOTICE OF INTENTION TO PULL OR ALTER CASING _____		SUPPLEMENTARY WELL HISTORY _____	
NOTICE OF INTENTION TO ABANDON WELL _____			

(INDICATE ABOVE BY CHECK MARK NATURE OF REPORT, NOTICE, OR OTHER DATA)

June 6, 19 60

Tom Bolack Gas Unit "A"

Well No. 1 is located 790 ft. from [N] line and 1750 ft. from [E] line of sec. 2

NE/4 Sec. 2 27N 11W MPM  
(1/4 Sec. and Sec. No.) (Twp.) (Range) (Meridian)

Undesignated Dakota San Juan New Mexico  
(Field) (County or Subdivision) (State or Territory)

The elevation of the ground level above sea level is 5950 ft.

### DETAILS OF WORK

(State names of and expected depths to objective sands; show sizes, weights, and lengths of proposed casings; indicate mudding jobs, cementing points, and all other important proposed work)

We propose to drill a well at the above location to test the Dakota formation with rotary tools from the surface to T.D. as follows:

1. Drill 12 1/4" hole to 800'.
2. Run 9 5/8" OD, 32.3#, N-40 STWC casing to 800' and cement with sufficient volume to circulate to surface.
3. WOC 24 hrs. Pressure test casing at 600 psi for 30 minutes.
4. Drill 8 3/4" from 800' to est. T.D. 6600'.
5. Run Ea-Induction, Gamma Ray Sonic logs from 800' to T.D.
6. If Dakota formation is indicated to be productive, run 4 1/2" OD 9.5#, J-55 casing. Cement in two stages with stage collar 50' below base of Pictured Cliffs. Cement with sufficient volume to bring top cement at least 50' above top of Pictured Cliffs.

I understand that this plan of work must receive approval in writing by the Geological Survey before operations may be commenced.

Company Tennessee Gas Transmission Company

Address P.O. Box 1714

Durango, Colorado

By J. J. Lacey  
Title District Petroleum Engineer

NEW MEXICO OIL CONSERVATION COMMISSION  
Well Location and Acreage Dedication Plat

Section A.

Date June 5, 1960

Operator TENNESSEE GAS AND OIL CO. Lease TOM BOLACK GAS UNIT "A"  
Well No. 1 Unit Letter A Section 2 Township 27 N Range 11 W PMF:  
Located 790 Feet From north Line, 1750 Feet From east Line  
County San Juan G. L. Elevation 5950 Dedicated Acreage 322.65 Acres  
Name of Producing Formation Bakia Pool Undominated

1. Is the Operator the only owner\* in the dedicated acreage outlined on the plat below?  
Yes \_\_\_\_\_ No X.
2. If the answer to question one is "no," have the interests of all the owners been consolidated by communitization agreement or otherwise? Yes X No \_\_\_\_\_. If answer is "yes," Type of Consolidation Communitization Agreement
3. If the answer to question two is "no," list all the owners and their respective interests below:

Owner

Land Description

\_\_\_\_\_  
\_\_\_\_\_  
\_\_\_\_\_

\_\_\_\_\_  
\_\_\_\_\_  
\_\_\_\_\_

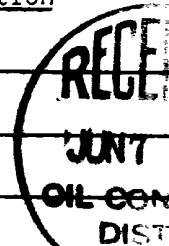

Section B

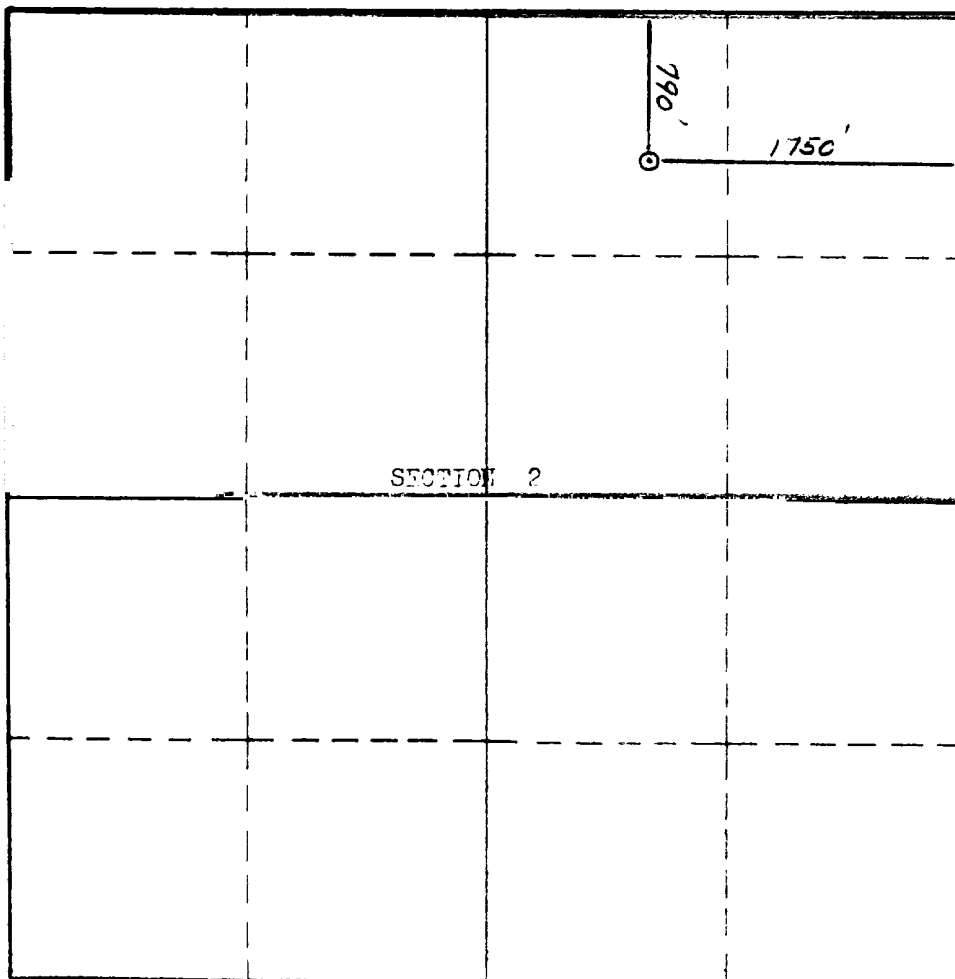

This is to certify that the information in Section A above is true and complete to the best of my knowledge and belief.

Tennessee Gas Transmission Co.

(Operator)

J. H. H. H. H. H.

(Representative)

P.O. Box 1714

Durango, Colorado

Address

This is to certify that the well location shown on the plat in Section B was plotted from field notes of actual surveys made by me or under my supervision and that the same is true and correct to the best of my knowledge and belief.

Date Surveyed June 2, 1960

STEPHEN H. KIRBY

Registered Professional Engineer and Oil Land Surveyor.

Certificate No. 803

(See instructions for completing this form on the reverse side.)